

INSTALLATION INSTRUCTIONS

PRO-SERIES FRONT BUMPER



APPLICATION:

Ram 1500 2019-2020 (Excl. 2019-2020 Ram 1500 Classic, Rebel, & Warlock)

PART NUMBER:

58-411075

CONTENT			
ITEM	QUANTITY	DESCRIPTION	TOOLS NEEDED
1	1	PRO-SERIES FRONT BUMPER	10MM SOCKET
2	1	WINCH TRAY	10MM WRENCH
3	1	LED MESH COVER	19MM SOCKET
4	1	LED DRIVER BRACKET	19MM WRENCH
5	1	LED PASSENGER BRACKET	21MM SOCKET
6	1	BUMPER DRIVER BRACKET	21MM WRENCH
7	1	BUMPER PASSENGER BRACKET	RATCHET
8	1	WINCH TRAY DRIVER BRACKET	TORQUE WRENCH
9	1	WINCH TRAY PASSENGER BRACKET	TAPE MEASURE
10	4	SENSOR PLATE A	
11	2	SENSOR PLATE B	
12	2	CENTER MESH COVER DRIVER	
13	2	CENTER MESH COVER PASSENGER	
14	1	SLANTED MESH COVER DRIVER	
15	1	SLANTED MESH COVER PASSENGER	
16	16	M12 SERRATED FLANGE NUT	
17	16	M12 HEX HEAD CAP SCREW	
18	16	M12 FLAT WASHER	
19	4	M6 HEX HEAD CAP SCREW	
20	4	M6 FLAT WASHER	
21	20	M6 SERRATED FLANGE NUT	
22	2	M12 LARGE FLAT WASHER	
23	2	M14 FLAT WASHER	
24	2	M14 SPLIT LOCK WASHER	
25	2	M14 HEX HEAD CAP SCREW	
26	16	M6 HEX DRIVE FLAT HEAD SCREWS	
ANTI-SEIZE LUBRICANT MUST BE USED ON ALL STAINLESS STEEL FASTENERS TO PREVENT THREAD DAMAGE AND GALLING			

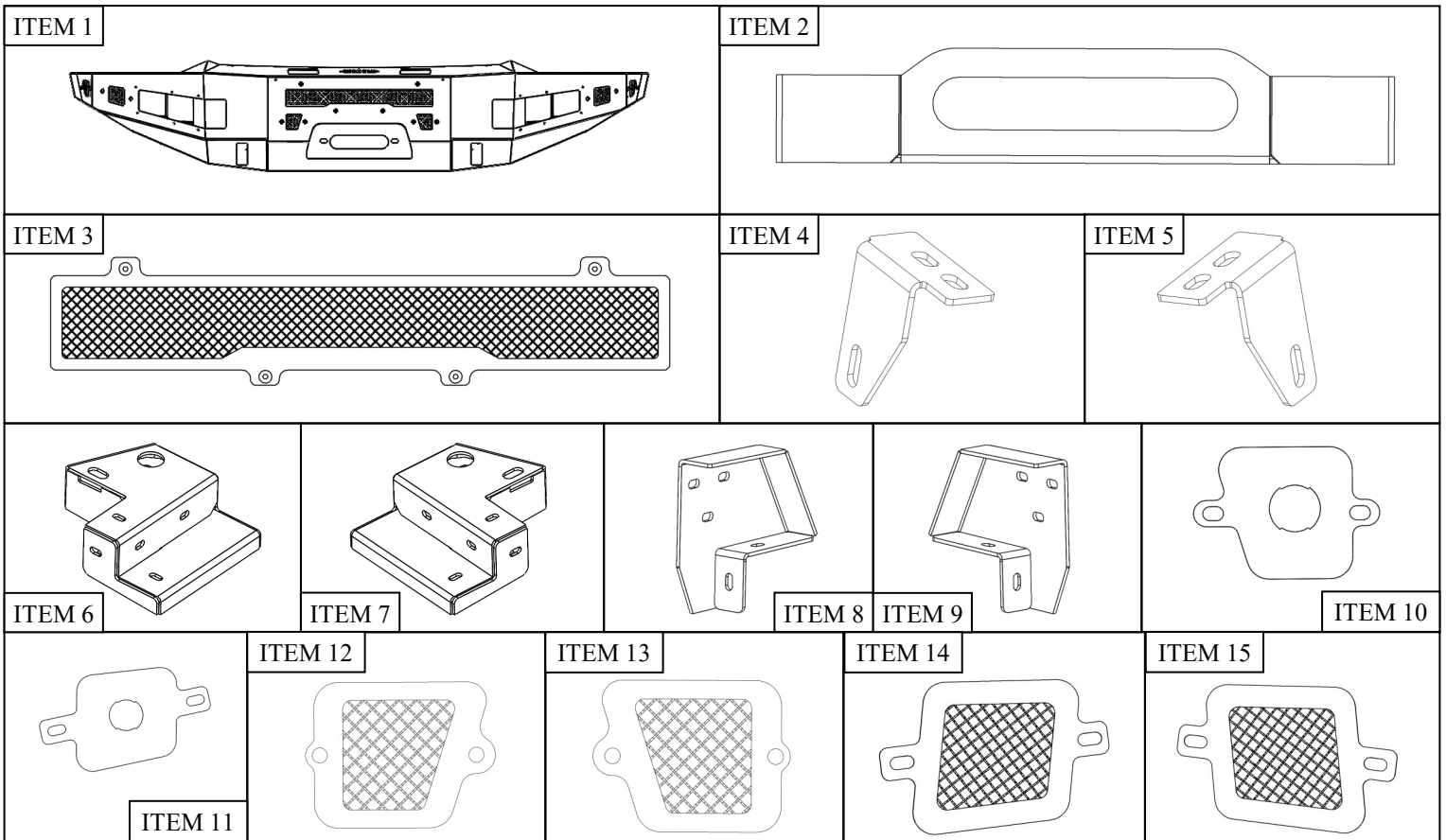

PROCEDURE

1. Remove contents from box, verify if all parts listed are present and free from damage. Carefully read and understand all instructions before attempting installation.
Failure to identify damage before installation could lead to a rejection of any claim.
2. Unplug any connections to the OEM front bumper (sensors, fog lights, etc).
3. Remove the front inner fender pieces by removing the 5 screws shown in **Figure 1**.
4. Remove the three frame mounted bolts from each side of the vehicle. Then, carefully remove the OEM bumper. See **Figure 2** for reference.

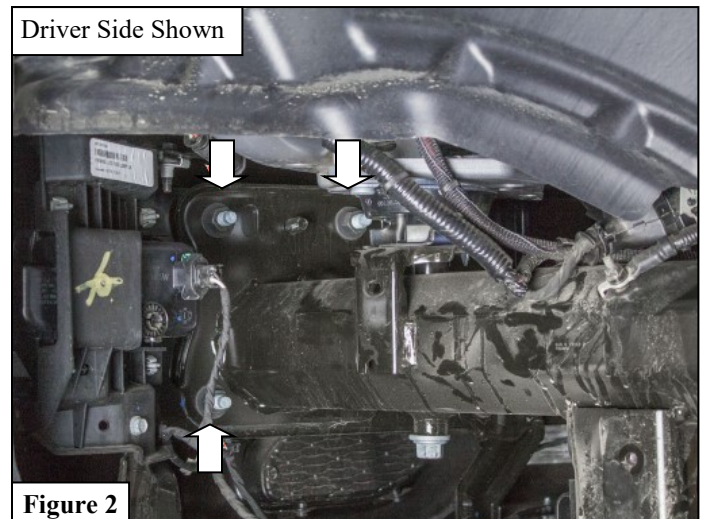
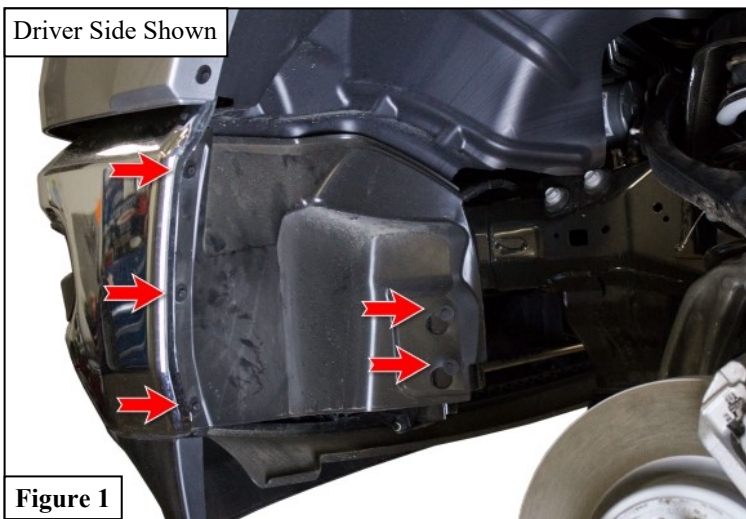

5. Unplug and remove the active valence from the vehicle if equipped. See **Figure 3** for reference.



6. Locate the Winch Tray Brackets (8-9). Using the supplied M12 (16, 17, & 22) and M14 hardware (23-25) loosely install the Winch Tray Brackets to the frame. See **Figures 4 through 6** for reference.

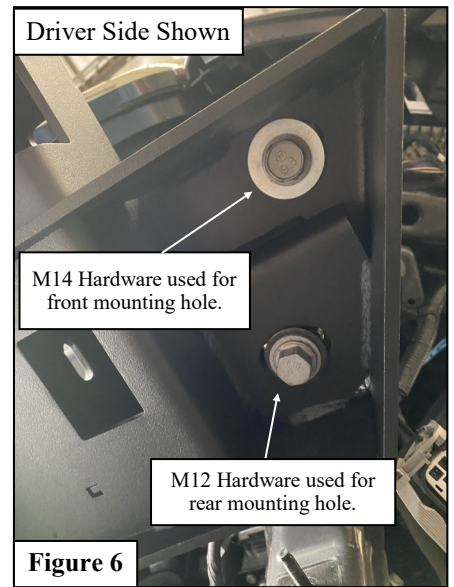
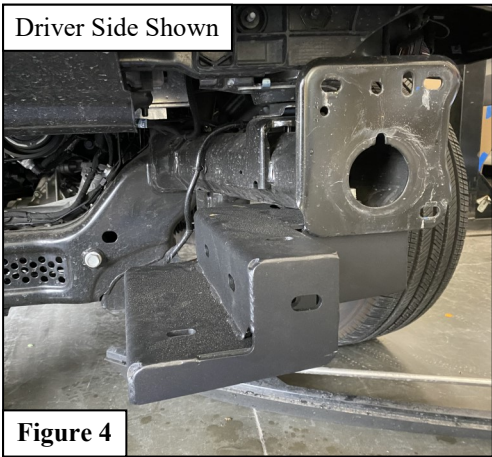

7. Locate the Winch Tray (2). Using the supplied M12 Hardware (16-18) loosely install the Winch Tray onto the Winch Tray Brackets. See **Figure 7 & 8** for reference.

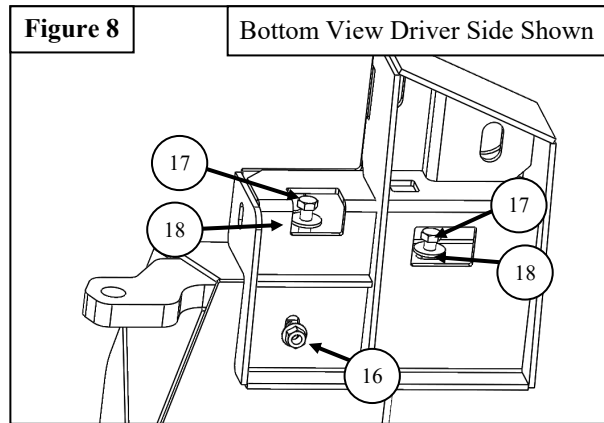
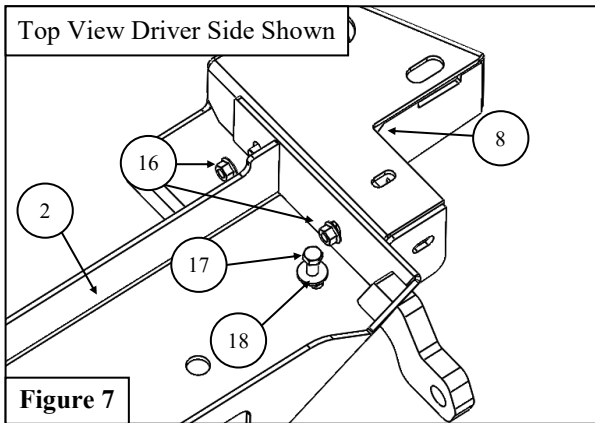

8. Locate the Bumper Driver and Passenger Brackets (6-7). Using the supplied M12 Hardware (16-18) loosely install the Bumper Driver and Passenger Brackets onto the Winch Tray Brackets. See **Figure 9 & 10** for reference. **Note:** *If installing a winch onto the Winch Tray, now is the time to do so. Install according to manufacturers recommendations.*

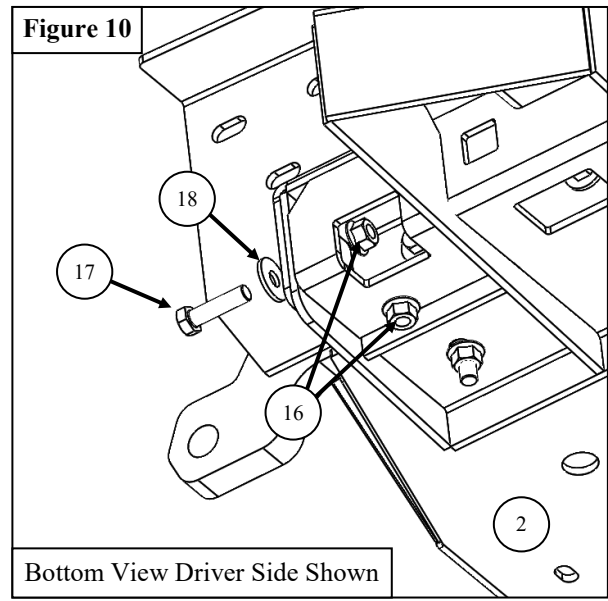
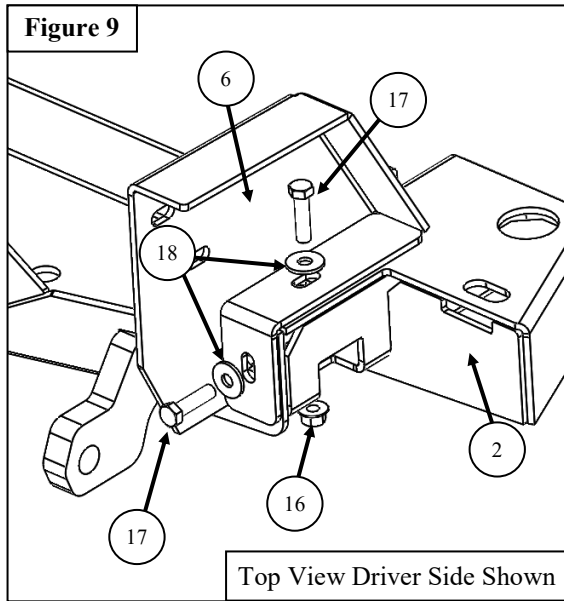

9. If using sensors, install the optional sensor plates where the corner mesh covers are with the provided M6 hardware.
10. Remove the sensors and retainers from the stock bumper. Install the factory sensor retainer into each of the sensor plates **from the front**. **Note:** *Ensure to install sensors in the same orientation you removed them.* See **Figures 11-14** for reference.
11. **If you are not installing sensors,** install mesh covers A and B using supplied M6 hardware. See **Figure 14**.

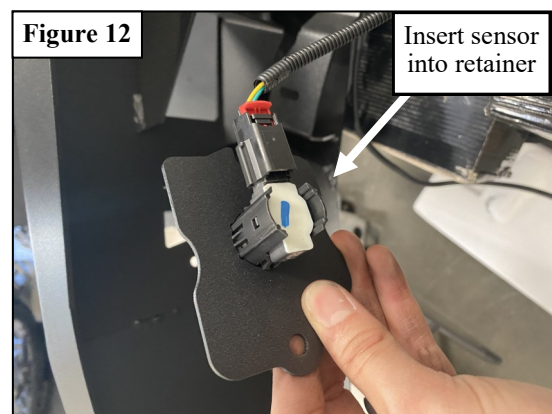
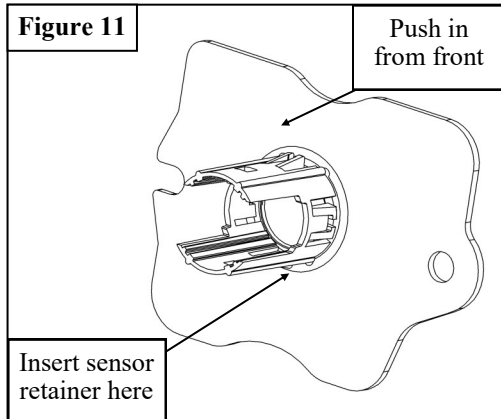

Figure 13

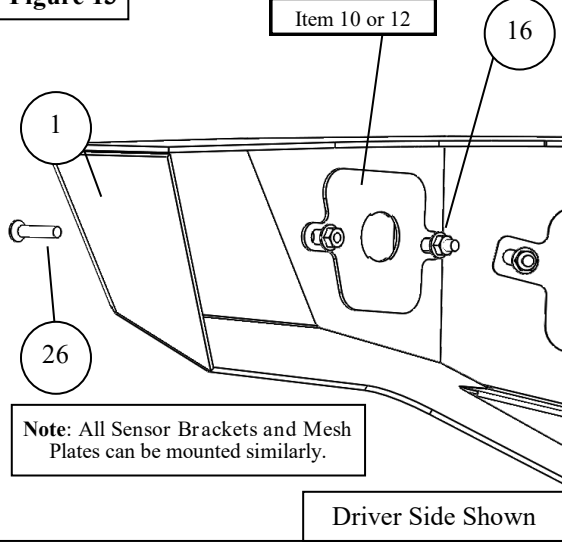
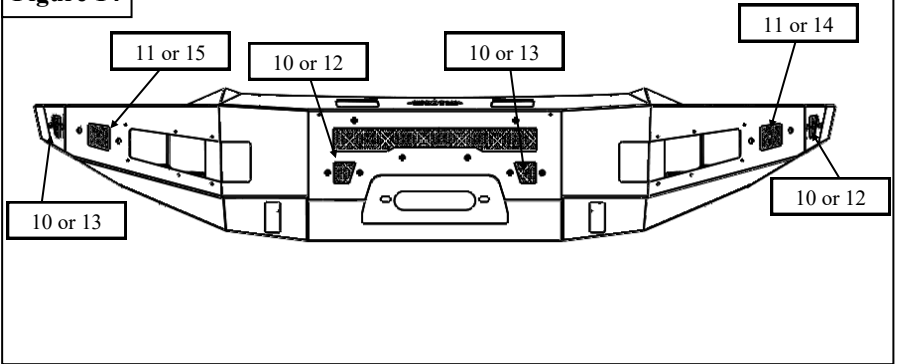

Figure 14



- 12. Install the led light mesh cover using supplied M6 hardware. **See Figure 15** for reference.
- 13. If installing a light bar, install using the supplied LED light brackets and supplied M6 hardware, if applicable. Install light per manufacturers recommendation. **See Figure 16** for reference.
- 14. If using light pods, install at this time as well using manufacturers recommendations.

Figure 15

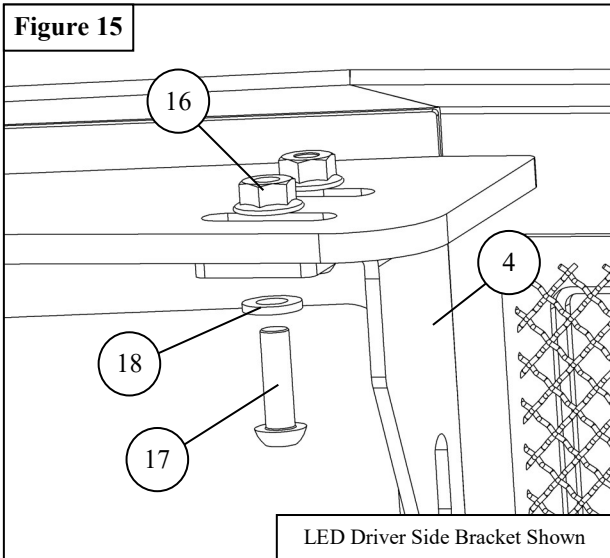
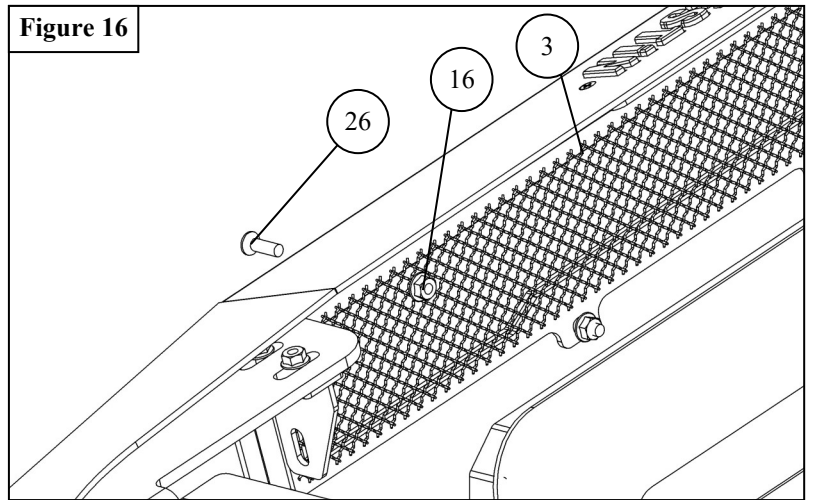
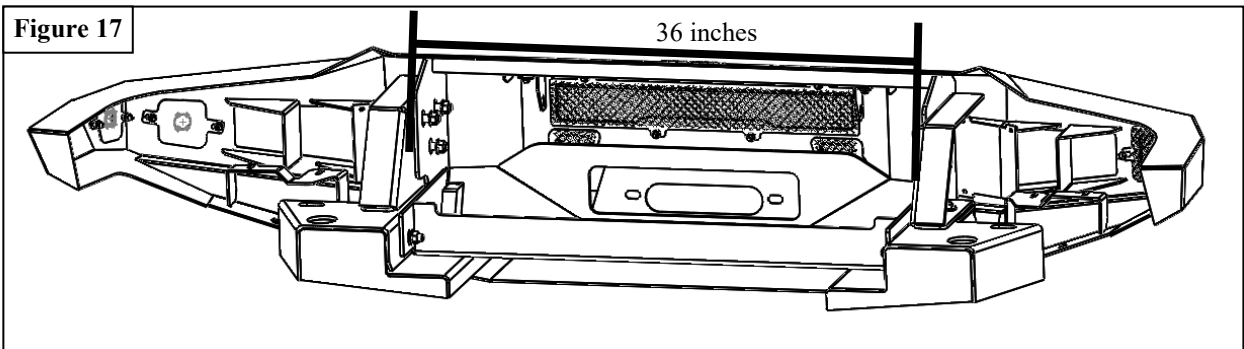

Figure 16



- 15. Measure the inner distance of the Bumper Driver and Passenger Brackets. Make sure the distance matches the outer distance on the bumper mounting locations. (About 36 inches) **See Figure 17**.

Figure 17



16. With help, mount the bumper to the bumper mounting brackets using the supplied M12 hardware. **See Figure 18.**
17. Align and adjust as needed and torque all hardware as specified: M6 to 7 ft. lbs, M12 to 55-60 ft-lbs, and M14 to 85-90 ft-lbs

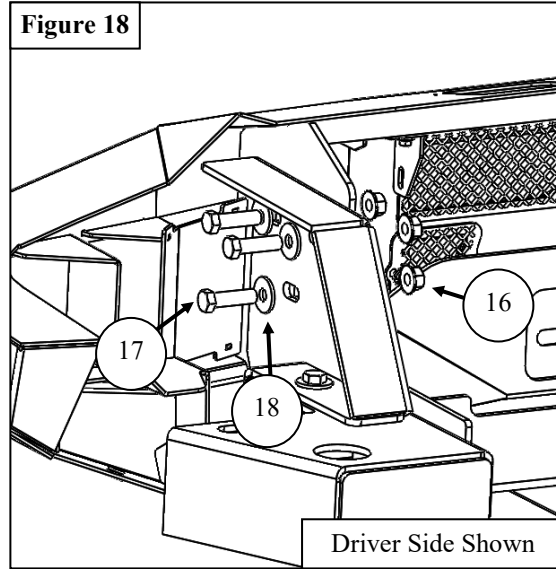

INSTALLATION COMPLETE



CARE INSTRUCTIONS

- REGULAR WAXING IS RECOMMENDED. DO NOT USE ANY TYPE OF POLISH OR WAX THAT MAY CONTAIN ABRASIVES.
- STAINLESS STEEL PRODUCTS CAN BE CLEANED WITH MILD SOAP AND WATER. STAINLESS STEEL POLISH SHOULD BE USED TO POLISH SMALL SCRATCHES.
- GLOSS BLACK FINISHES SHOULD BE CLEANED WITH MILD SOAP AND WATER.

WESTIN Westin Automotive Products, Inc.
320 W. Covina Blvd
San Dimas, Ca. 91773

Thank you for choosing Westin products
for additional installation assistance please call
Customer Service (800) 793-7846

www.westinautomotive.com

DATE: 04/30/21



WARNING



Failure to follow these instructions could lead to death, personal injury, and / or property damage.

Failure to follow these instructions could lead to death, personal injury, and / or property damage.

FASTENERS:

All Westin supplied fasteners must be utilized and installed in accordance with the installation instructions and apply torque to the specifications as defined. **DOUBLE CHECK ALL FASTENERS BEFORE INITIAL USE, AND PERIODICALLY IN THE FUTURE TO ENSURE PROPER FUNCTION AND SAFETY.**

DRILLING:

Most Westin products do not require drilling for installation. If drilling is defined as required, use caution when drilling a vehicle. **FAILURE TO REVIEW AN AREA TO BE DRILLED MAY RESULT IN PERSONAL INJURY AND/OR INJURY TO OTHERS AS WELL AS VEHICLE DAMAGE.**

EYE PROTECTION:

ALWAYS WEAR SAFETY GLASSES OR GOGGLES DURING THE INSTALLATION PROCESS TO AVOID PERSONAL INJURY.

MAXIMUM TOWING/CARRYING CAPACITY: (if applicable)

The Westin Receiver Hitches will have a visible tow rating label affixed directly on the product. User should never exceed the vehicle manufacturers maximum tow and weight rating regardless of the capacity of the hitch. **FAILURE TO FOLLOW THESE GUIDELINES WILL VOID THE WESTIN WARRANTY AND MAY RESULT IN PERSONAL INJURY AND/OR INJURY TO OTHERS AS WELL AS VEHICLE DAMAGE.**

FOR CALIFORNIA RESIDENTS ONLY-PROP 65 WARNING:

Some products may contain chemicals such as DEHP, which can cause cancer, birth defects or other reproductive harm. For more info go to www.p65warnings.ca.gov