



# INSTALLATION INSTRUCTIONS

## PUSH BUMPER ELITE-XD

### APPLICATION:

2021-2022 Ford F-150 / F-150 Police Responder / F-150 XL SSV

PART NUMBER: 36-54085

CONTENT			
ITEM	QUANTITY	DESCRIPTION	TOOLS NEEDED
1	1	PUSH BUMPER ASSEMBLY	14MM SOCKET
2	1	DRIVER SIDE LOWER MOUNTING BRACKET	15MM SOCKET
3	1	PASSENGER SIDE LOWER MOUNTING BRACKET	18MM SOCKET
4	1	DRIVER SIDE UPPER SUPPORT BRACKET	RATCHET
5	1	PASSENGER SIDE UPPER SUPPORT BRACKET	UTILITY KNIFE
6	2	DOUBLE M12 NUT PLATE	PRY TOOL
7	4	M12 HEX HEAD BOLT	ALLEN WRENCH
8	4	M12 FLAT WASHER	TORQUE WRENCH
9	4	M12 SPLIT LOCK WASHER	
10	2	M8 HEX HEAD BOLT	
11	2	M8 FLAT WASHER	
12	2	M8 SPLIT LOCK WASHER	
13	4	M12 HEX SOCKET BUTTON HEAD SCREW	
14	4	M12 BELLVILLE WASHER	
15	4	M12 SERATED FLANGE NUT	
16	2	M10 HEX SOCKET BUTTON HEAD SCREW	
17	2	M10 BELLVILLE WASHER	
18	2	M10 SERRATED FLANGE NUT	

ANTI-SEIZE LUBRICANT MUST BE USED ON ALL STAINLESS STEEL FASTENERS TO PREVENT THREAD DAMAGE AND GALLING

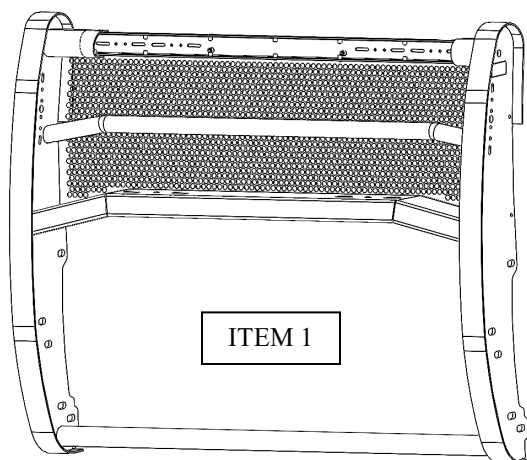

Westin Automotive Products, Inc.  
320 W. Covina Blvd  
San Dimas, Ca. 91773

Thank you for choosing Westin products  
for additional installation assistance please call  
Customer Service (800) 793-7846  
[www.westinautomotive.com](http://www.westinautomotive.com)

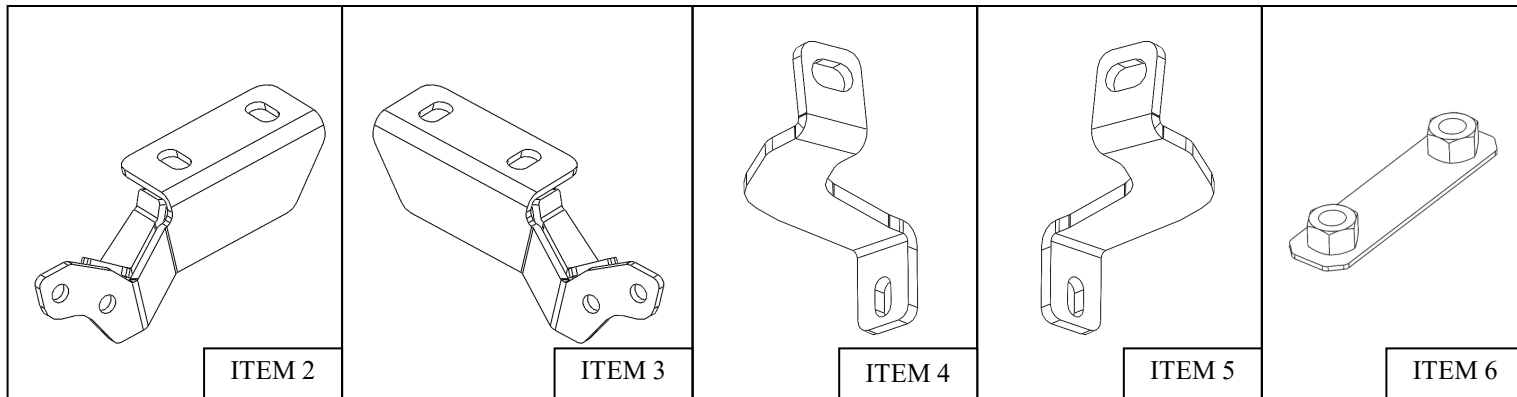

### PROCEDURE

1. Remove contents from box, verify if all parts listed are present and free from damage.  
Carefully read and understand all instructions before attempting installation.  
**Failure to identify damage before installation could lead to a rejection of any claim.**
2. Start by removing the plastic pop clips and screws along the front of the vehicle that secure the OEM front grille shown in **Figure 1**. Remove the front grille carefully. **Note:** Make sure any wiring connectors pertaining to the grille are disconnected prior to removal.
3. **For vehicles without factory tow hooks:** Trim the plastic in the areas in **Figures 2 & 3**. Repeat for the passenger side.

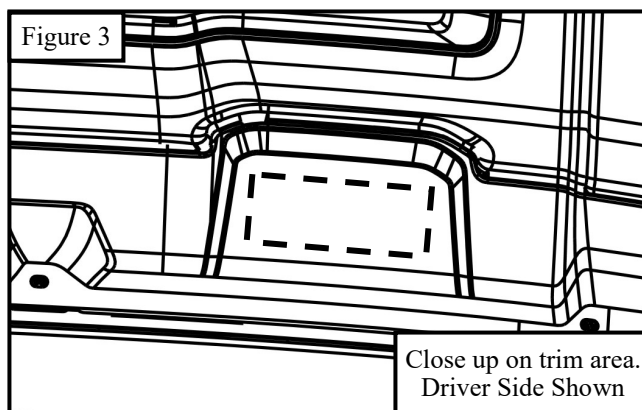
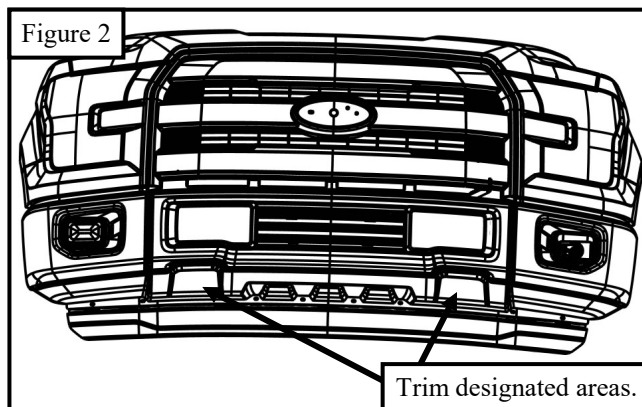
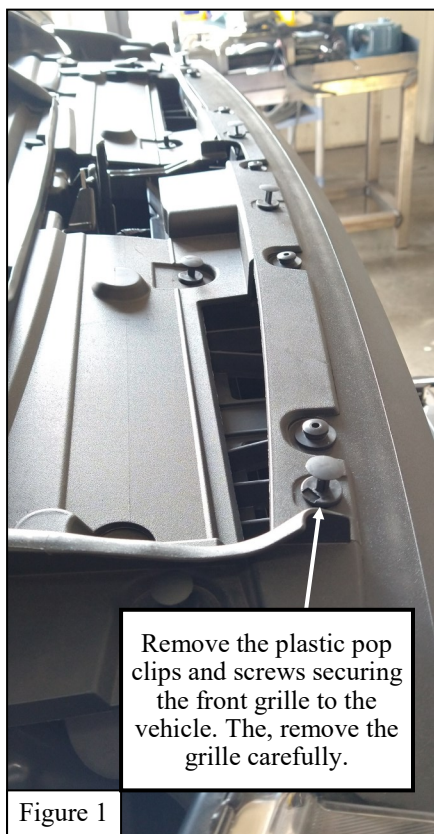

**WESTIN**

Westin Automotive Products, Inc.  
320 W. Covina Blvd  
San Dimas, Ca. 91773

Thank you for choosing Westin products  
for additional installation assistance please call  
Customer Service (800) 793-7846

[www.westinautomotive.com](http://www.westinautomotive.com)

DATE: 12/06/21

4. For vehicles **with** factory tow hooks: Remove tow hooks and loosely install Lower Mounting Brackets (Items 2 & 3) to the factory nut plates using supplied M12 hardware as shown in **Figure 4 & 5**. *Note: Trimming of screws may be required if they interfere with lower mounting bracket. See **Figure 7** for reference.*
5. For vehicles **without** tow hooks: Slip M12 Double nut plates (Item 6) into frame and line up with existing holes. See **Figure 4**. Loosely install the Lower Mounting Brackets using the supplied M12 hardware as shown in **Figure 4 & 5**. *Note: Trimming of screws may be required if they interfere with lower mounting bracket. See **Figure 7** for reference.*

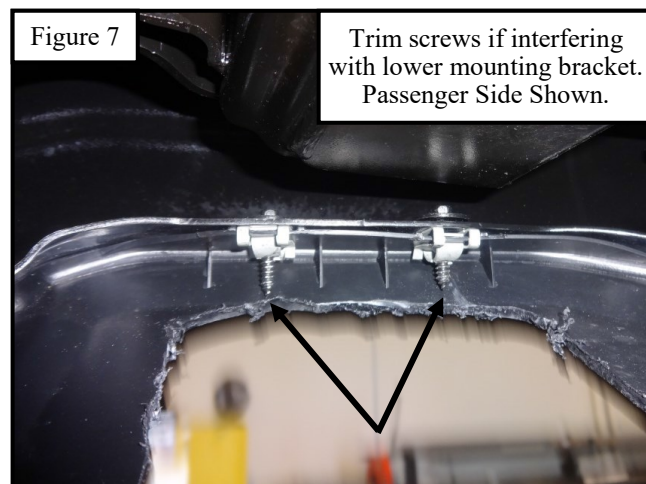
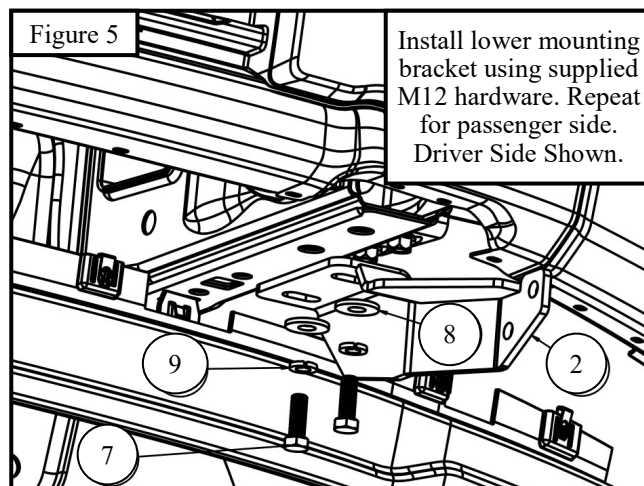
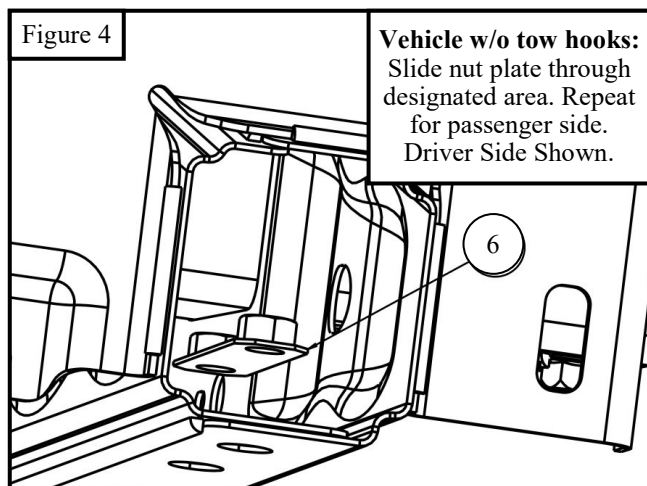

6. Install the Upper Mounting Bracket (Items 4 & 5). Remove the OEM M8 Bolt and use the supplied M8 hardware to mount the brackets. See **Figure 8 & 9** for reference.
7. Make sure the brackets are approximately 39-3/4" apart from outer bracket flange, and make sure to lay the bracket firmly on top of the rubber strip that is on top of the bumper. Tighten M8 hardware to 15 ft-lbs. See **Figures 9 & 10** for reference.



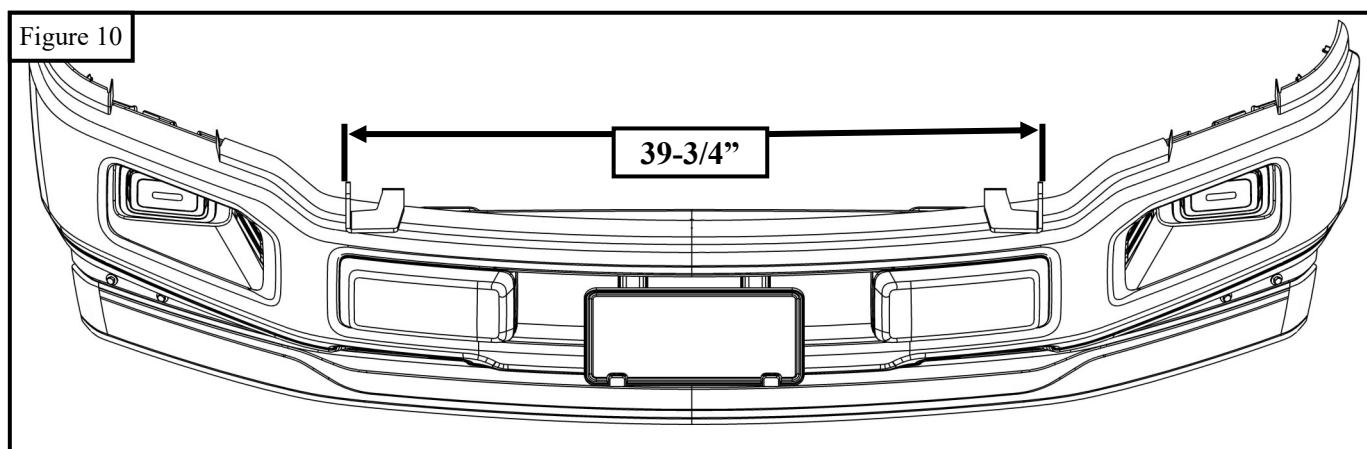
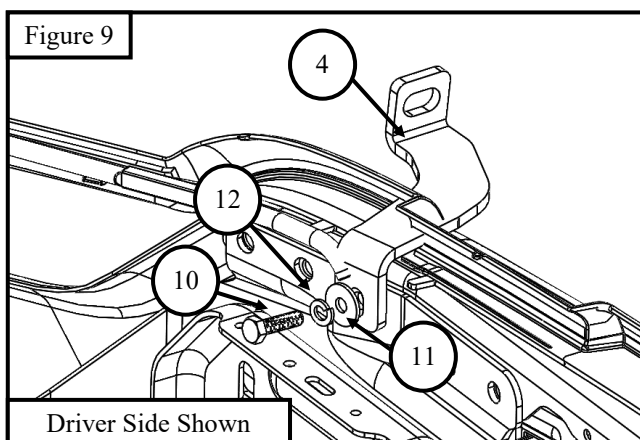
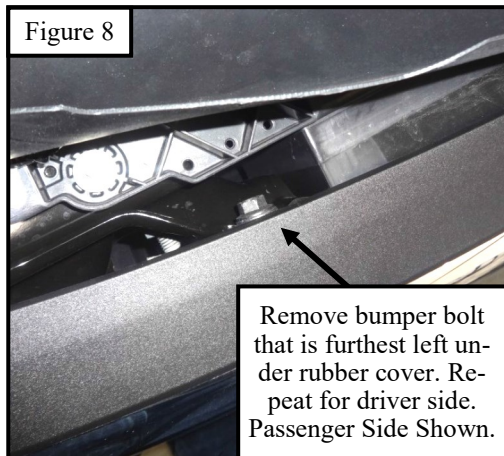

8. Reinstall any parts removed in the reverse order of the install instructions.
9. With assistance hold the Push Bumper Assembly up to the previously installed brackets. Loosely attach the Push Bumper to the brackets using the supplied M10 hardware for the upper support mounting brackets and the M12 hardware for the lower mounting brackets only. See **Figures 11** for reference.
10. Align and adjust the Push Bumper as needed. Tighten and torque the M8 hardware to 16-18 ft-lbs. M10 hardware to 35-40 ft-lbs.. and the M12 hardware to 50-55 ft-lbs.

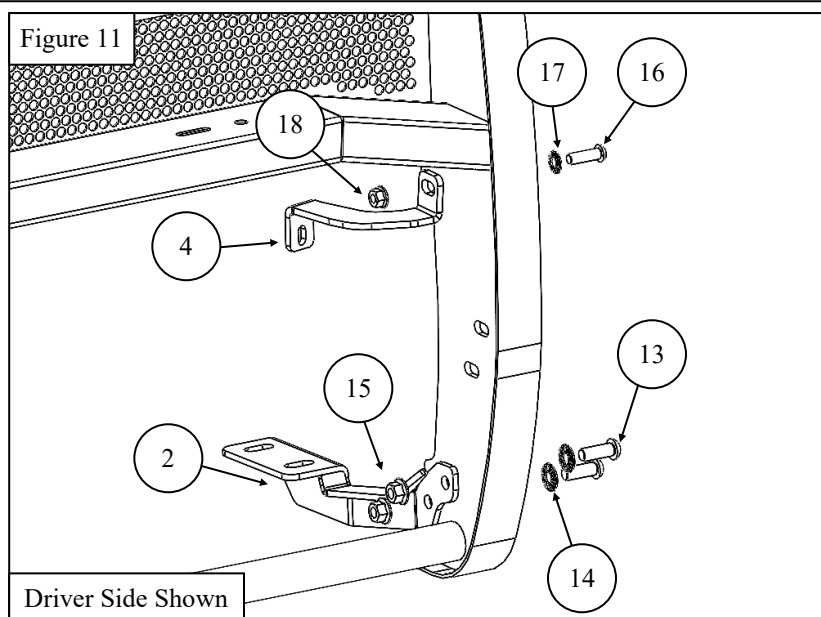

## INSTALLATION COMPLETE



### CARE INSTRUCTIONS

- REGULAR WAXING IS RECOMMENDED. DO NOT USE ANY TYPE OF POLISH OR WAX THAT MAY CONTAIN ABRASIVES.
- STAINLESS STEEL PRODUCTS CAN BE CLEANED WITH MILD SOAP AND WATER. STAINLESS STEEL POLISH SHOULD BE USED TO POLISH SMALL SCRATCHES.
- GLOSS BLACK FINISHES SHOULD BE CLEANED WITH MILD SOAP AND WATER.

**WESTIN** Westin Automotive Products, Inc.  
320 W. Covina Blvd  
San Dimas, Ca. 91773

P.N.: 75-3654085-RevA

ECO #: W21-0105

Thank you for choosing Westin products  
for additional installation assistance please call  
Customer Service (800) 793-7846

[www.westinautomotive.com](http://www.westinautomotive.com)

DATE: 12/06/21



## WARNING



Failure to follow these instructions could lead to death, personal injury, and / or property damage.

Failure to follow these instructions could lead to death, personal injury, and / or property damage.

### FASTENERS:

All Westin supplied fasteners must be utilized and installed in accordance with the installation instructions and apply torque to the specifications as defined. **DOUBLE CHECK ALL FASTENERS BEFORE INITIAL USE, AND PERIODICALLY IN THE FUTURE TO ENSURE PROPER FUNCTION AND SAFETY.**

### DRILLING:

Most Westin products do not require drilling for installation. If drilling is defined as required, use caution when drilling a vehicle. **FAILURE TO REVIEW AN AREA TO BE DRILLED MAY RESULT IN PERSONAL INJURY AND/OR INJURY TO OTHERS AS WELL AS VEHICLE DAMAGE.**

### EYE PROTECTION:

**ALWAYS WEAR SAFETY GLASSES OR GOGGLES DURING THE INSTALLATION PROCESS TO AVOID PERSONAL INJURY.**

### MAXIMUM TOWING/CARRYING CAPACITY: (if applicable)

The Westin Receiver Hitches will have a visible tow rating label affixed directly on the product. User should never exceed the vehicle manufacturers maximum tow and weight rating regardless of the capacity of the hitch. **FAILURE TO FOLLOW THESE GUIDELINES WILL VOID THE WESTIN WARRANTY AND MAY RESULT IN PERSONAL INJURY AND/OR INJURY TO OTHERS AS WELL AS VEHICLE DAMAGE.**

### FOR CALIFORNIA RESIDENTS ONLY-PROP 65 WARNING:

Some products may contain chemicals such as DEHP, which can cause cancer, birth defects or other reproductive harm. For more info go to [www.p65warnings.ca.gov](http://www.p65warnings.ca.gov)



Westin Automotive Products, Inc.  
320 W. Covina Blvd  
San Dimas, Ca. 91773