

INSTALLATION INSTRUCTIONS

PUSH BUMPER ELITE XD



APPLICATION:
2019-2020 Chevrolet Silverado (Excl. LD 2019)
PART NUMBER:
36-53955

CONTENT			
ITEM	QUANTITY	DESCRIPTION	TOOLS NEEDED
1	1	PUSH BUMPER	TORQUE WRENCH
2	1	LOWER DRIVER BRACKET	13MM SOCKET
3	1	LOWER PASSENGER BRACKET	15MM SOCKET
4	1	DRIVER TOP SUPPORT	18MM SOCKET
5	1	PASSENGER TOP SUPPORT	19MM SOCKET
6	2	LOWER SUPPORT BRACKET	PRY TOOL
7	2	WINCH TRAY BRACKET	RATCHET
8	4	M12 SHORT HEX HEAD BOLT (YELLOW ZINC)	
9	2	M12 LONG HEX HEAD BOLT (YELLOW ZINC)	
10	6	M12 SPLIT LOCK WASHER (YELLOW ZINC)	
11	12	M12 FLAT WASHER (YELLOW ZINC)	
12	6	M12 HEX NUT (YELLOW ZINC)	
13	4	M12 SERRATED HEX HEAD BOLT (BLACK ZINC)	FOR WINCH TRAY INSTALLATION
14	4	M12 SERRATED FLANGE NUT (BLACK ZINC)	
15	2	M10 BUTTON HEAD BOLT (BLACK ZINC)	
16	2	M10 BELLVILLE WASHER (BLACK ZINC)	
17	2	M10 SERRATED FLANGE NUT (BLACK ZINC)	
18	6	M12 BUTTON HEAD BOLT (BLACK ZINC)	
19	6	M12 SERRATED FLANGE NUT	
20	6	M12 BELLVILLE WASHER	

ANTI-SEIZE LUBRICANT MUST BE USED ON ALL STAINLESS STEEL FASTENERS TO PREVENT THREAD DAMAGE AND GALLING

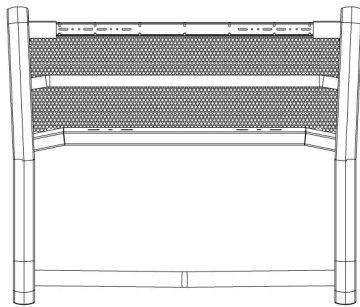
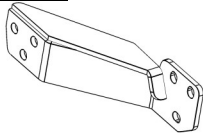
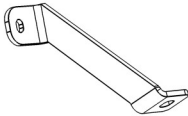
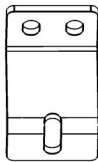
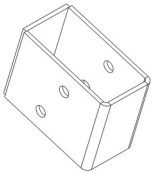
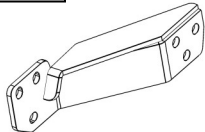
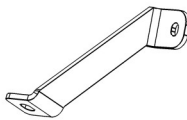
ITEM 1	ITEM 2	ITEM 4	ITEM 6	ITEM 7
				
	ITEM 3	ITEM 5		
				

WESTIN Westin Automotive Products, Inc.
320 W. Covina Blvd
San Dimas, Ca. 91773

Thank you for choosing Westin products
for additional installation assistance please call
Customer Service (800) 793-7846

www.westinautomotive.com

DATE: 04/09/2020

PROCEDURE

1. Remove contents from box, verify if all parts listed are present and free from damage.
Carefully read and understand all instructions before attempting installation.
Failure to identify damage before installation could lead to a rejection of any claim.
2. Begin by removing the plastic trim fasteners holding the grille in place. Also dethatch the clips of the wings of the grille. See **Figures 1 & 2**.
3. Remove the grille by pulling firmly and carefully at the bottom of the grille.

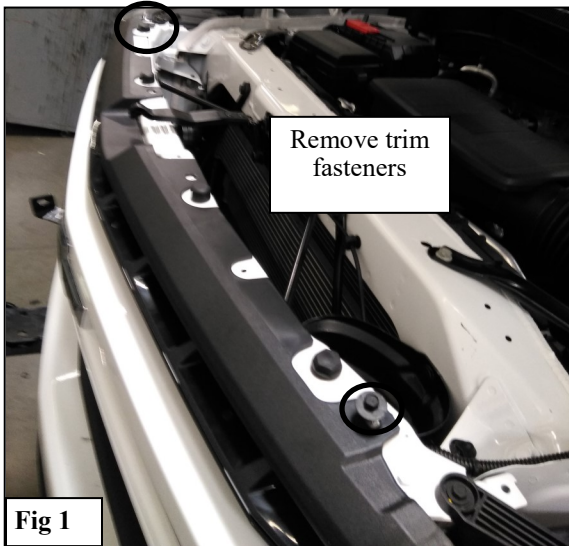

4. Use the OEM hardware to secure the Upper Strap Bracket (4-5) to the bumper. *Note: Bumper shown off vehicle for viewing purposes.* See **Figure 3**
5. Trim the factory trim area to fit the Lower Mounting Bracket (2-3). See **Figure 4**.

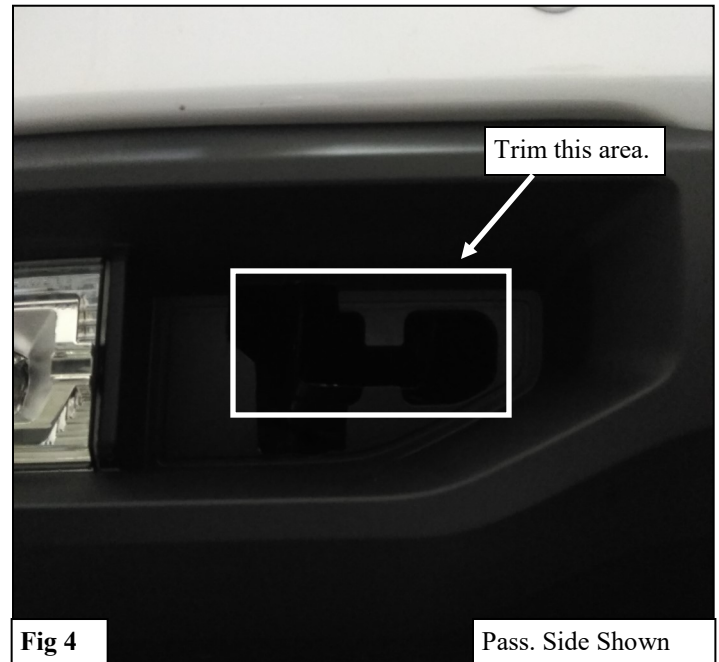
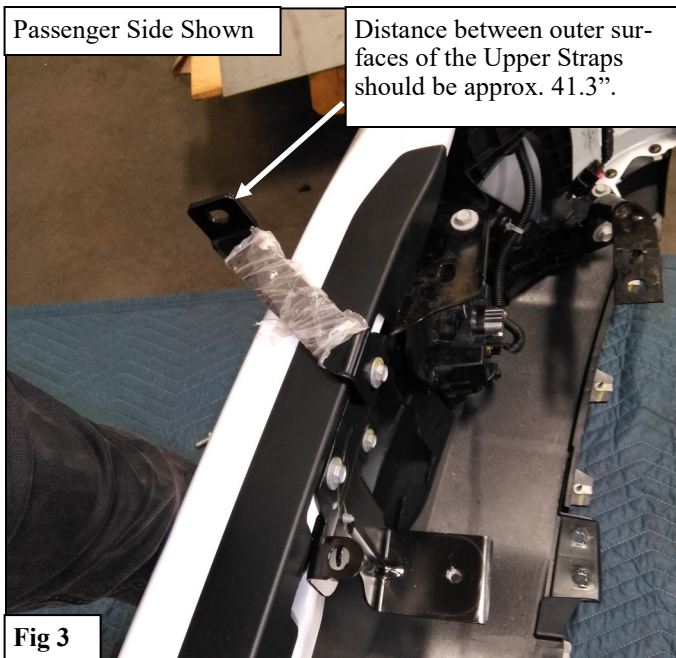

6. Install the Lower Mounting Bracket (2-3) and Lower Support Strap (6) to the frame using the supplied M12 Hardware. See **Figures 5 & 6.**

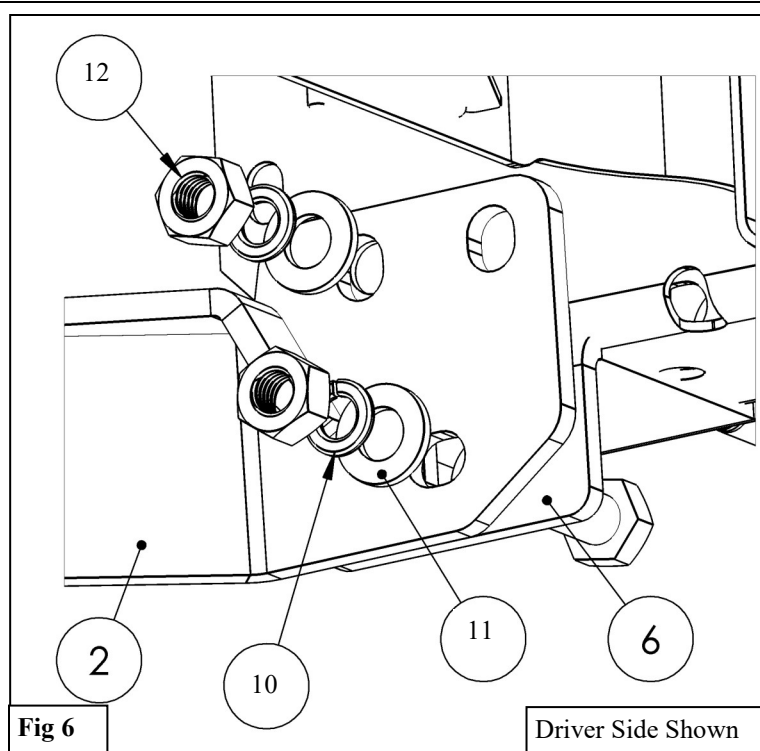
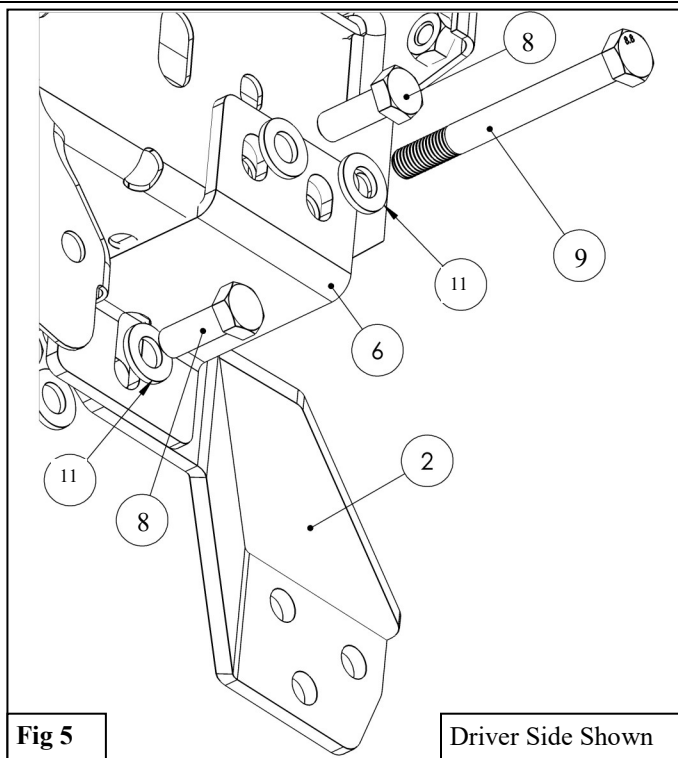

7. Repeat Steps 4-6 for the opposite sides.
8. Use the supplied M10 and M12 Hardware to secure the Grille Guard to the Mounting Brackets/Straps. See **Figures 7, 8, & 9.**

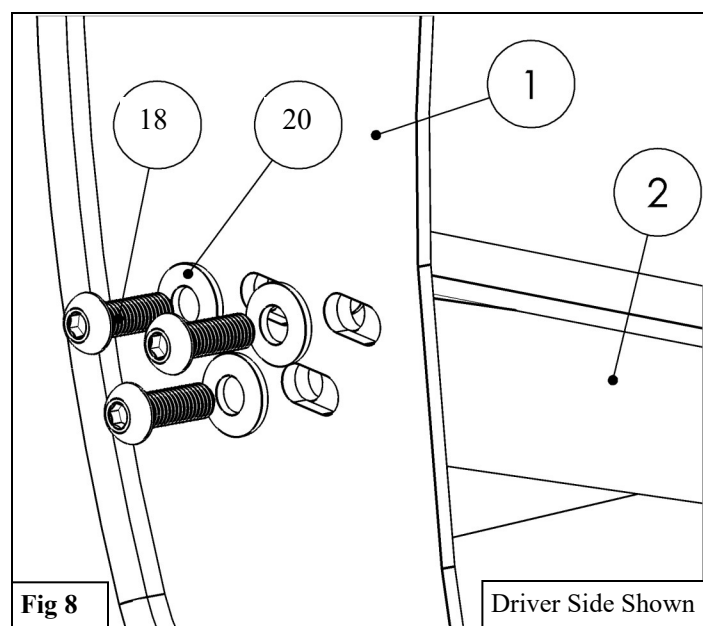
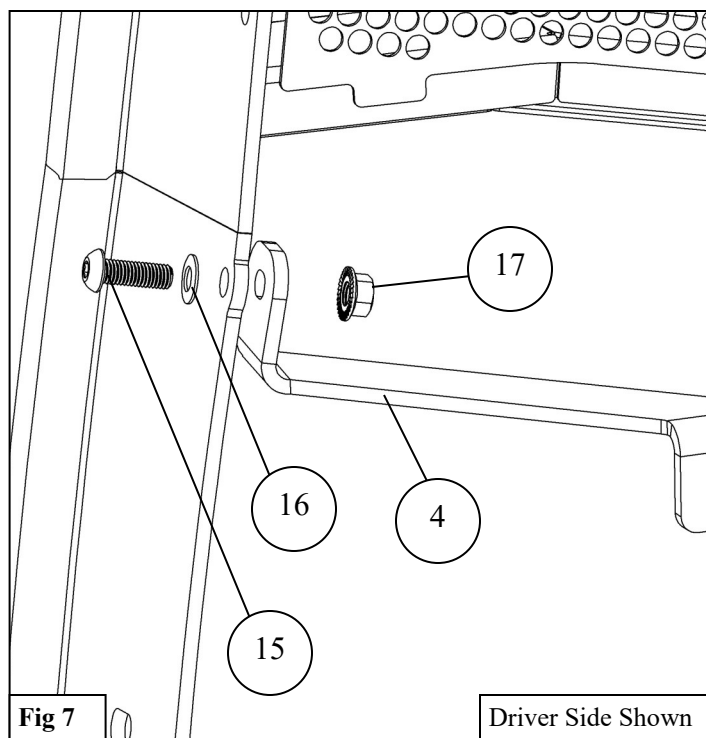

9. Adjust the Assembly as desired and tighten all hardware: M10 to 32 ft-lbs, M12 to 55 ft-lbs.

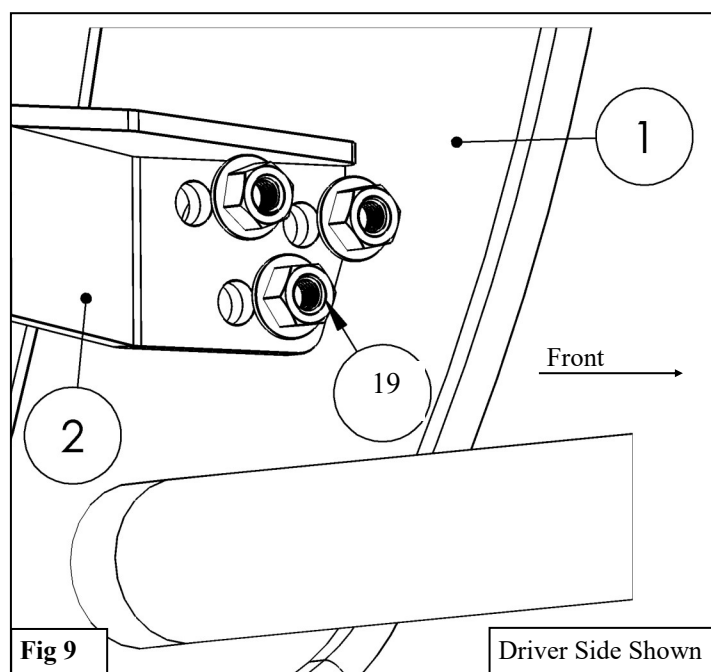

FOR WINCH TRAY INSTALLATION ONLY

10. Locate and attach both Spacer Brackets (Item 4) to the Winch Tray using (4) M12 hex head flange bolt and (4) M12 hex head serrated flange nut. **See Figure 10.**
11. Install Winch per Winch Manufacturer's Instructions. **Note:** It may be very difficult to install the winch after the Grille Guard has been installed.
12. With assistance loosely install the Grille Guard Assembly (Item 26) onto the previously installed spacer brackets using the supplied M12 hardware. **See Figures 11.**
13. Align and adjust the Grille Guard Assembly as necessary. Tighten all remaining hardware: M12 to 50-55 ft-lbs.

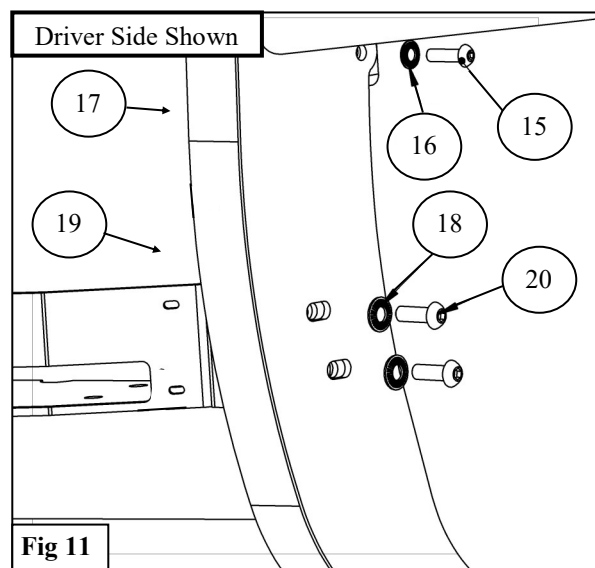
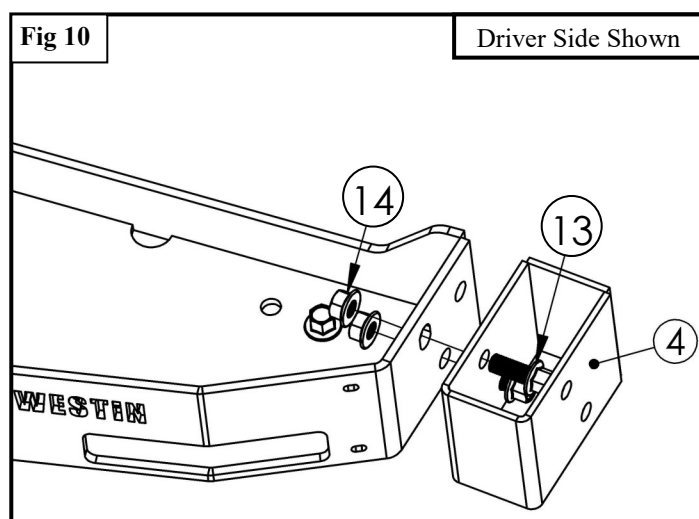

Westin Automotive Products, Inc.
320 W. Covina Blvd
San Dimas, Ca. 91773

INSTALLATION COMPLETE



Wing Wraps,
winch mount
sold separately

CARE INSTRUCTIONS

- REGULAR WAXING IS RECOMMENDED. DO NOT USE ANY TYPE OF POLISH OR WAX THAT MAY CONTAIN ABRASIVES.
- STAINLESS STEEL PRODUCTS CAN BE CLEANED WITH MILD SOAP AND WATER. STAINLESS STEEL POLISH SHOULD BE USED TO POLISH SMALL SCRATCHES.
- GLOSS BLACK FINISHES SHOULD BE CLEANED WITH MILD SOAP AND WATER.

WESTIN

Westin Automotive Products, Inc.
320 W. Covina Blvd
San Dimas, Ca. 91773

Thank you for choosing Westin products
for additional installation assistance please call
Customer Service (800) 793-7846
www.westinautomotive.com



WARNING



Failure to follow these instructions could lead to death, personal injury, and / or property damage.

Failure to follow these instructions could lead to death, personal injury, and / or property damage.

FASTENERS:

All Westin supplied fasteners must be utilized and installed in accordance with the installation instructions and apply torque to the specifications as defined. **DOUBLE CHECK ALL FASTENERS BEFORE INITIAL USE, AND PERIODICALLY IN THE FUTURE TO ENSURE PROPER FUNCTION AND SAFETY.**

DRILLING:

Most Westin products do not require drilling for installation. If drilling is defined as required, use caution when drilling a vehicle. **FAILURE TO REVIEW AN AREA TO BE DRILLED MAY RESULT IN PERSONAL INJURY AND/OR INJURY TO OTHERS AS WELL AS VEHICLE DAMAGE.**

EYE PROTECTION:

ALWAYS WEAR SAFETY GLASSES OR GOGGLES DURING THE INSTALLATION PROCESS TO AVOID PERSONAL INJURY.

MAXIMUM TOWING/CARRYING CAPACITY: (if applicable)

The Westin Receiver Hitches will have a visible tow rating label affixed directly on the product. User should never exceed the vehicle manufacturers maximum tow and weight rating regardless of the capacity of the hitch. **FAILURE TO FOLLOW THESE GUIDELINES WILL VOID THE WESTIN WARRANTY AND MAY RESULT IN PERSONAL INJURY AND/OR INJURY TO OTHERS AS WELL AS VEHICLE DAMAGE.**

FOR CALIFORNIA RESIDENTS ONLY-PROP 65 WARNING:

Some products may contain chemicals such as DEHP, which can cause cancer, birth defects or other reproductive harm. For more info go to www.p65warnings.ca.gov



Westin Automotive Products, Inc.
320 W. Covina Blvd
San Dimas, Ca. 91773