



AUTOMOTIVE PRODUCTS,

INSTALLATION INSTRUCTIONS

POLICE PUSH BUMPER ELITE XD

APPLICATION:

2015-2017 Ford Expedition

PART NUMBER:

36-53865

ITEM	QUANTITY	DESCRIPTION	TOOLS NEEDED
1	1	PUSH BUMPER ELITE XD	13MM SOCKET
2,3	2	LOWER MOUNT BRACKET, DRIVER (2) AND PASSENGER (3)	13MM WRENCH
4,5	2	MOUNT BRACKET, DRIVER (4) AND PASSENGER (5)	15MM SOCKET
6,7	2	UPPER SUPPORT STRAP, DRIVER (6) AND PASSENGER (7)	15MM WRENCH
8	2	DOUBLE M12 NUT PLATE	16MM SOCKET
9	2	M12 STUD PLATE	16MM WRENCH
10	4	M12 HEX HEAD CAP SCREW (YELLOW ZINC)	19MM SOCKET
11	6	M12 FLAT WASHER (YELLOW ZINC)	19MM WRENCH
12	6	M12 SPLIT LOCK WASHER (YELLOW ZINC)	ALLEN WRENCH
13	2	M12 HEX NUT (YELLOW ZINC)	SOCKET EXT.
14	2	M10 HEX NUT (YELLOW ZINC)	RATCHET
15	2	M10 HEX HEAD CAP SCREW (YELLOW ZINC)	TORQUE WRENCH
16	2	M10 SPLIT LOCK WASHER (YELLOW ZINC)	
17	4	M10 FLAT WASHER (YELLOW ZINC)	
18	2	M8 HEX HEAD CAP SCREW (YELLOW ZINC)	
19	2	M8 FLAT WASHER (YELLOW ZINC)	
20	2	M8 SPLIT LOCK WASHER (YELLOW ZINC)	
21	6	M12 HEX SOCKET BUTTON HEAD SCREW (BLACK ZINC)	
22	6	M12 BELLVILLE WASHER (BLACK ZINC)	
23	6	M12 SERRATED FLANGE NUT (BLACK ZINC)	
24	2	M12 FISH WIRE	
25	2	M12 PLASTIC RETAINER	

ANTI-SEIZE LUBRICANT MUST BE USED ON ALL STAINLESS STEEL FASTENERS TO PREVENT THREAD DAMAGE AND GALLING

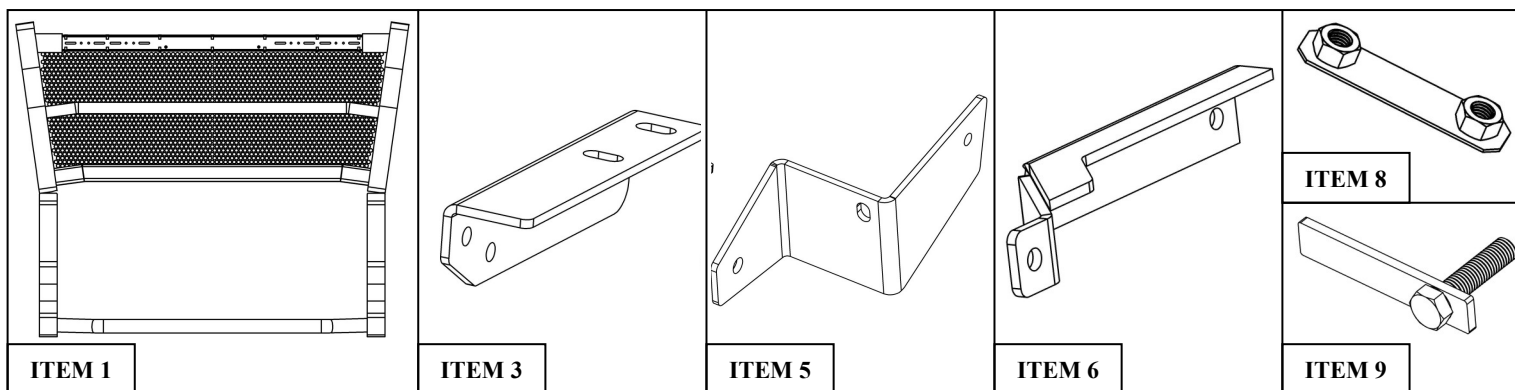

Westin Automotive Products, Inc.
320 W. Covina Blvd
San Dimas, Ca. 91773

P.N.: 75-365386-RevB

ECO #: W16-0995

Thank you for choosing Westin products
for additional installation assistance please call
Customer Service (800) 793-7846

www.westinautomotive.com

DATE: 12/19/16

PROCEDURE

1. Remove contents from box, verify if all parts listed are present and free from damage.
Carefully read and understand all instructions before attempting installation.
Failure to identify damage before installation could lead to a rejection of any claim.

Step 1: Removal

- Remove the plastic tow hook covers on both sides of the front of vehicle. See **Figure 1**.
- Remove the factory tow hooks. **Note:** Factory tow hooks can not be re-installed.
- Remove cover near tires by either removing the plastic push pins that holds it in place in the frame channel or by pulling it out. See **Figure 2**. **Note:** Cover needs to be removed in order to install the mount bracket (Item 4/5).

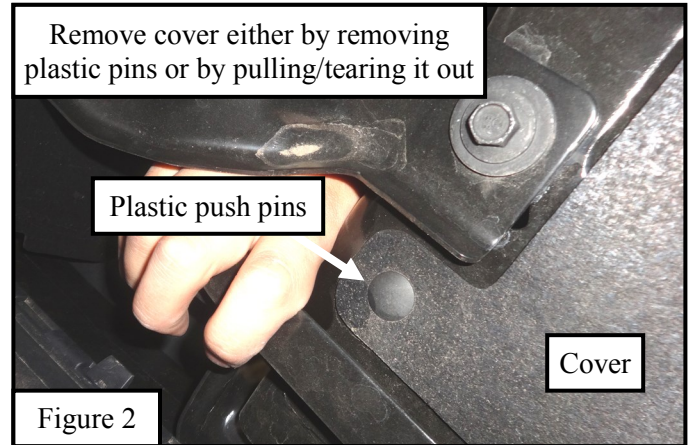
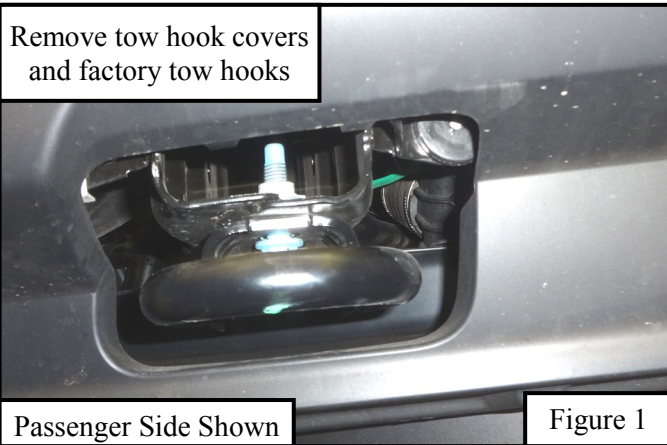

Step 2: Installing Bottom Mount Brackets

- Mounting location for the mount bracket (Item 4/5) after cover is removed is shown in **Figure 3**.
- Locate (1) M12 fish wire, (1) M12 plastic retainer and (1) M12 stud plate. Insert the fish wire through the opening of the frame channel and out through a hole on the side of the frame channel. Then attach the M12 stud plate to the fish wire and pull M12 stud plate through hole and secure stud plate in place using the M12 plastic retainer. See **Figures 4 and 5**.

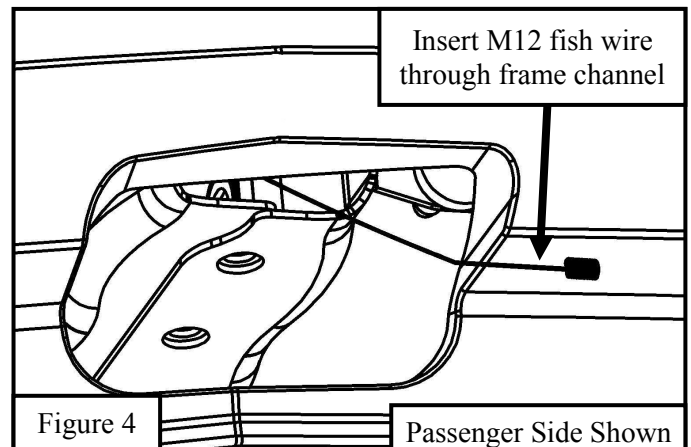
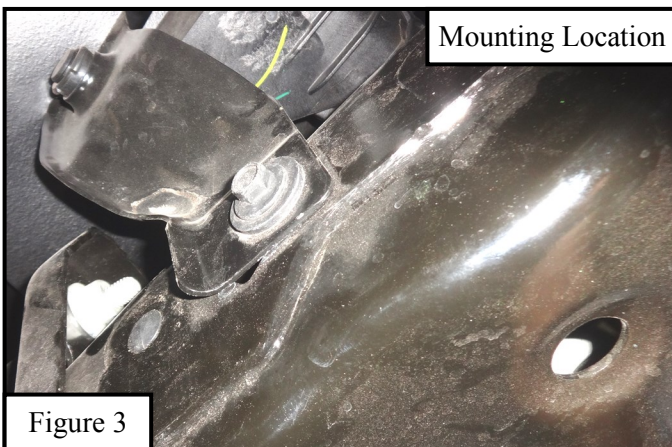

- Remove factory hardware. See **Figure 6**.
- Locate (1) mount bracket (Item 4/5) and loosely secure to the previously installed M12 stud plate using (1) M12 flat washer, (1) M12 split lock washer, (1) M12 hex nut, (1) M8 hex head cap screw, (1) M8 flat washer and (1) M8 split lock washer. See **Figure 7**.

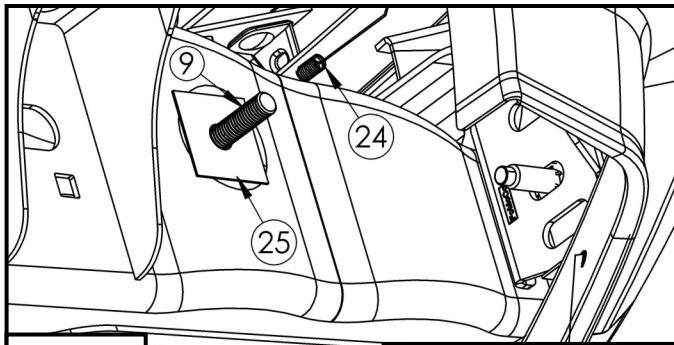

Figure 5

Passenger Side Shown

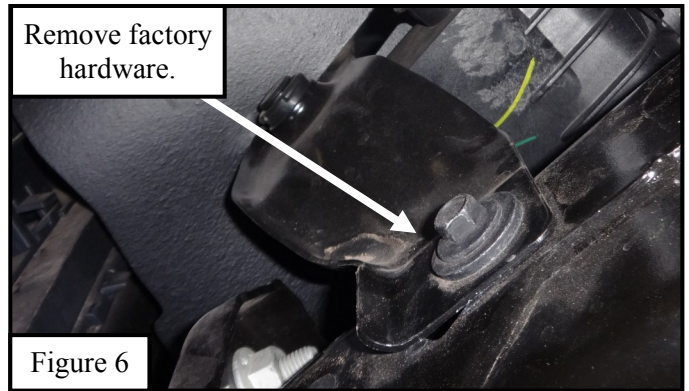

Figure 6

Step 3: Installing Lower Mount Brackets - NOTE: Skip this step if mounting the Push Bumper in conjunction with 46-23865 Max Winch Tray.

- Start on either side and locate (1) lower mount bracket (Items 2/3) and (1) double M12 nut plate (Item 8) and loosely secure to frame channel, where the factory tow hooks were, using (2) M12 hex head cap screws, (2) M12 flat washers and (2) M12 split lock washers. See **Figure 8**. Repeat step for opposite side.

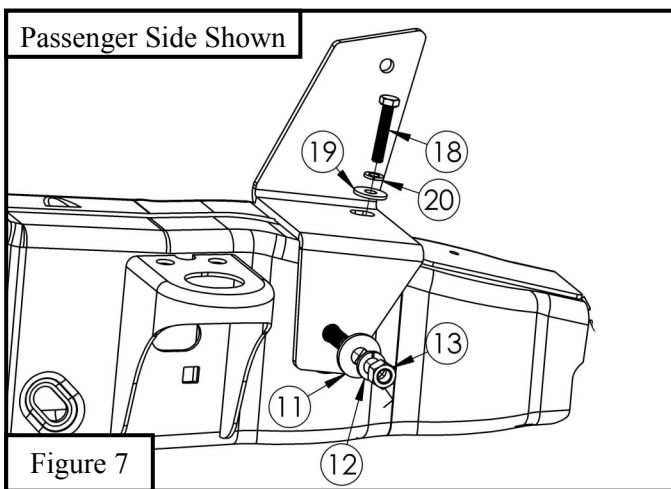

Figure 7

Passenger Side Shown

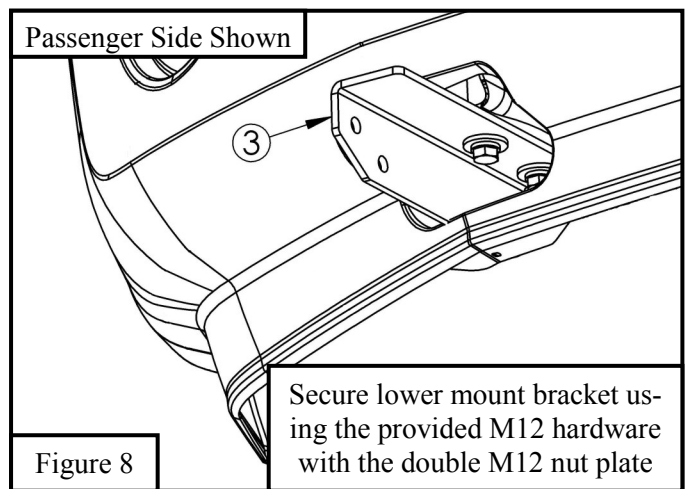

Figure 8

Passenger Side Shown

Secure lower mount bracket using the provided M12 hardware with the double M12 nut plate

Step 4: Installing Upper Support Straps

- Trim plastic area as necessary for upper support straps. Refer to **Figure 9 and 10**.
- Insert upper support strap (Item 6/7) through previously trimmed area and loosely secure the upper support strap to mount bracket (Item 4/5) from underneath the vehicle utilizing wrenches or ratchets with socket extensions using (1) M10 hex nut, (1) M10 hex head cap screw, (1) M10 split lock washer and (2) M10 flat washers. See **Figure 11**.
- Repeat to install upper support straps on opposite side.

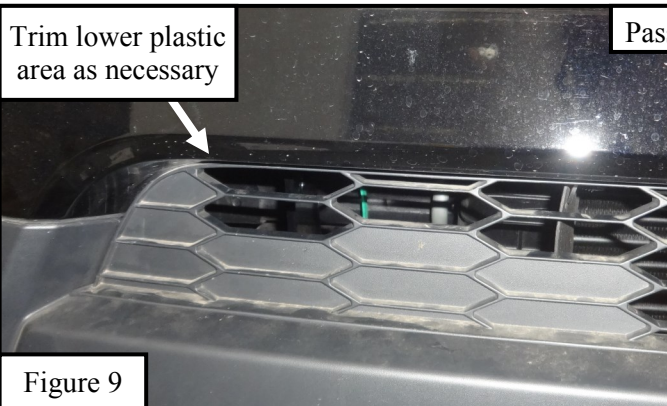

Figure 9

Trim lower plastic area as necessary

Passenger Side Shown

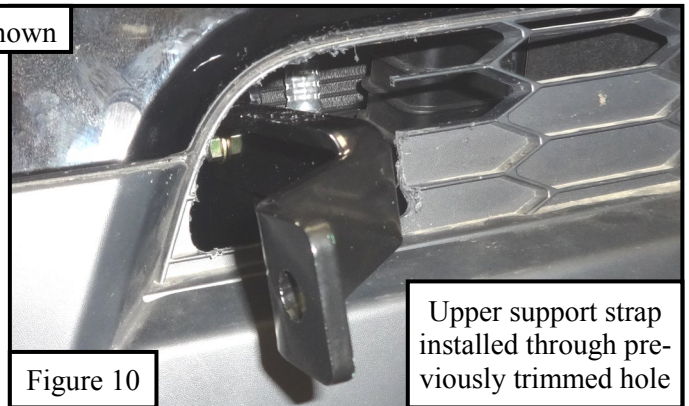

Figure 10

Upper support strap installed through previously trimmed hole



Westin Automotive Products, Inc.
320 W. Covina Blvd
San Dimas, Ca. 91773

Step 5: Installing the Push Bumper

- With assistance align the push bumper assembly onto the previously installed brackets and upper support straps and loosely secure using the provided M12 hardware (Items 21-23). See **Figures 12 and 13**.
- If using the Push Bumper in conjunction with the 46-23865 Max Winch Tray (Sold Separately) attach the Push Bumper to the Max Winch Tray using the provided M12 hardware (Item 21-23) and the provided M12 hardware in the Max Winch Tray Kit (Items 18-20 in install sheet: 75-462386). See **Figure 14**.
- Align brackets and push bumper as necessary and then torque all: M8 hardware to 20 ft-lbs, M10 hardware 30-35 ft-lbs, and M12 to 50-55 ft-lbs.

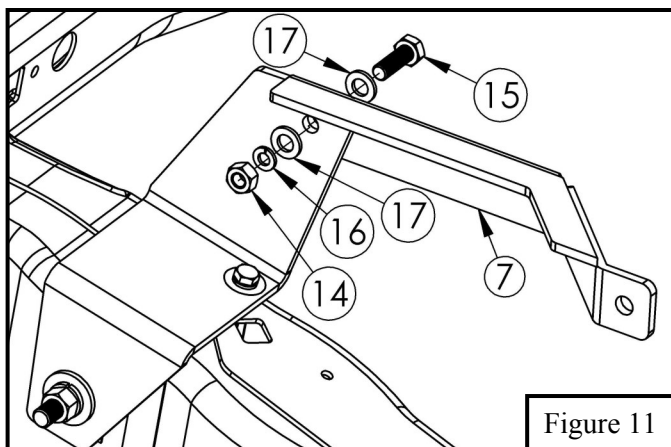

Figure 11

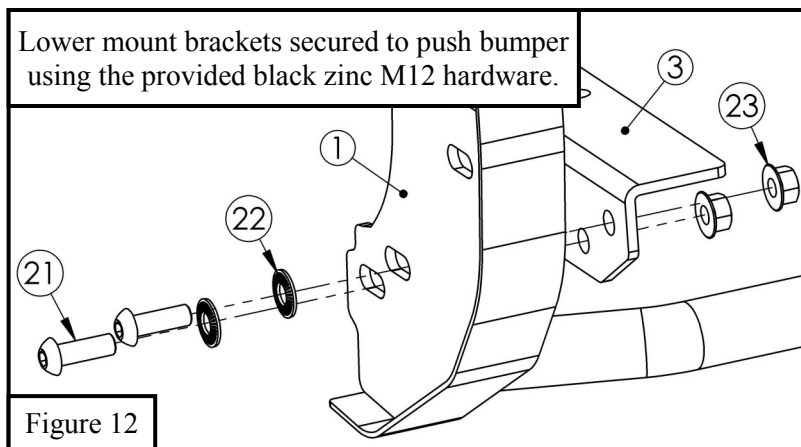

Figure 12

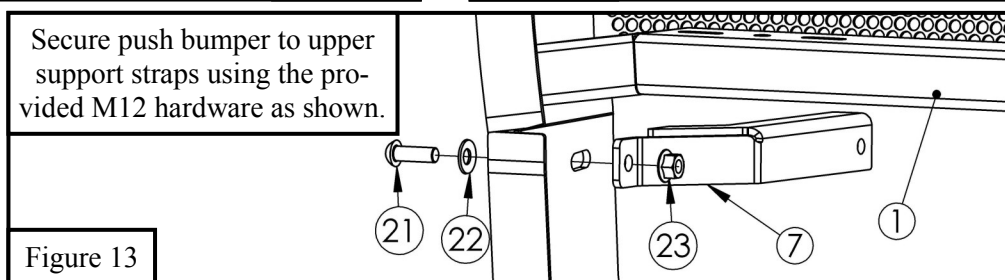

Figure 13

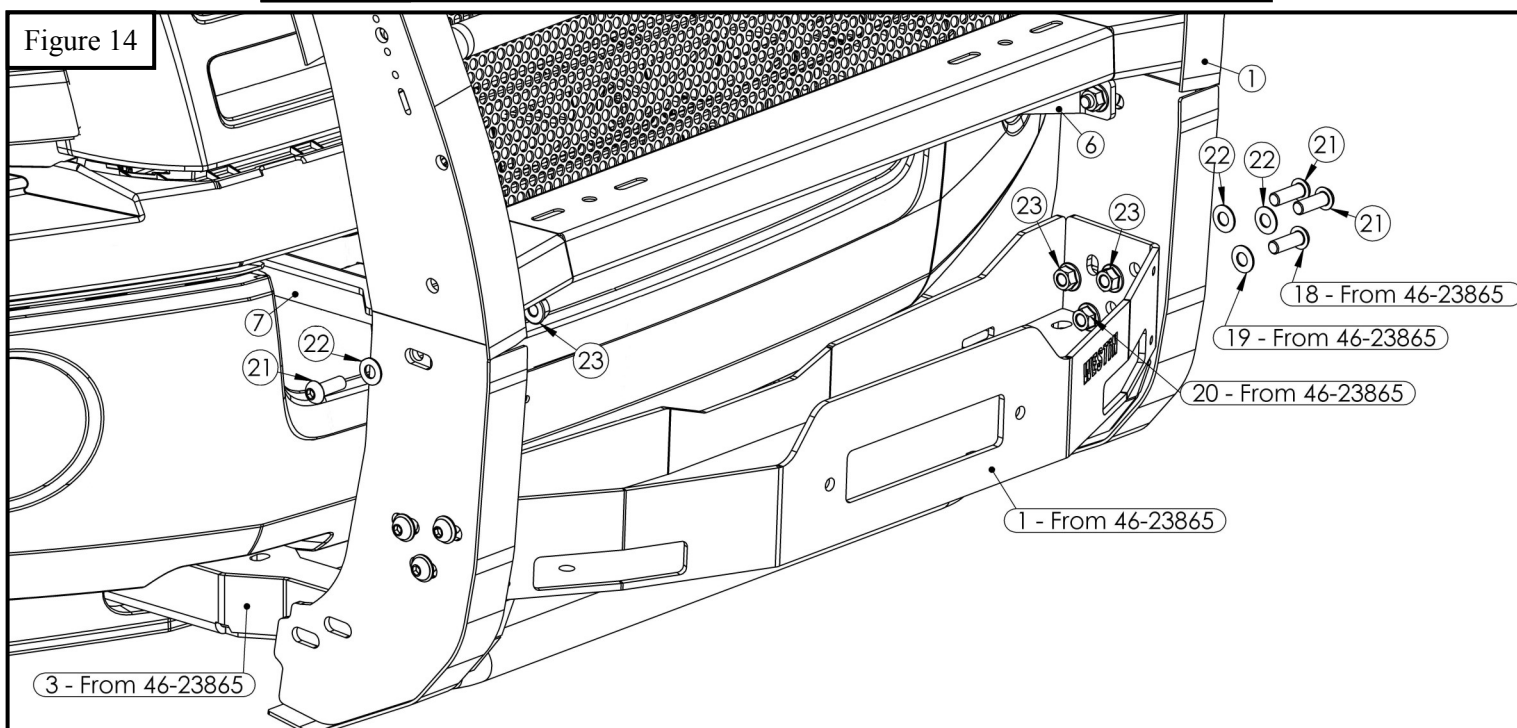

Figure 14



Westin Automotive Products, Inc.
320 W. Covina Blvd
San Dimas, Ca. 91773

Thank you for choosing Westin products
for additional installation assistance please call
Customer Service (800) 793-7846

INSTALLATION COMPLETE - PUSH BAR



INSTALLATION COMPLETE - PUSH BAR W / WINCH TRAY



CARE INSTRUCTIONS

- REGULAR WAXING IS RECOMMENDED. DO NOT USE ANY TYPE OF POLISH OR WAX THAT MAY CONTAIN ABRASIVES.
- STAINLESS STEEL PRODUCTS CAN BE CLEANED WITH MILD SOAP AND WATER. STAINLESS STEEL POLISH SHOULD BE USED TO POLISH SMALL SCRATCHES.
- GLOSS BLACK FINISHES SHOULD BE CLEANED WITH MILD SOAP AND WATER.



Westin Automotive Products, Inc.
320 W. Covina Blvd
San Dimas, Ca. 91773

Thank you for choosing Westin products
for additional installation assistance please call
Customer Service (800) 793-7846

www.westinautomotive.com



SIGNATURE OF QUALITY

AUTOMOTIVE PRODUCTS, INC.



WARNING



Failure to follow these instructions could lead to death, personal injury, and / or property damage.

FASTENERS:

All Westin supplied fasteners must be utilized and installed in accordance with the installation instructions and apply torque to the specifications as defined. **DOUBLE CHECK ALL FASTENERS BEFORE INITIAL USE, AND PERIODICALLY IN THE FUTURE TO ENSURE PROPER FUNCTION AND SAFETY.**

DRILLING:

Most Westin products do not require drilling for installation. If drilling is defined as required, use caution when drilling a vehicle. **FAILURE TO REVIEW AN AREA TO BE DRILLED MAY RESULT IN PERSONAL INJURY AND/OR INJURY TO OTHERS AS WELL AS VEHICLE DAMAGE.**

EYE PROTECTION:

ALWAYS WEAR SAFETY GLASSES OR GOGGLES DURING THE INSTALLATION PROCESS TO AVOID PERSONAL INJURY.

MAXIMUM TOWING/CARRYING CAPACITY:

The Westin Receiver Hitches will have a visible tow rating label affixed directly on the product. User should never exceed the vehicle manufacturers maximum tow and weight rating regardless of the capacity of the hitch. **FAILURE TO FOLLOW THESE GUIDELINES WILL VOID THE WESTIN WARRANTY AND MAY RESULT IN PERSONAL INJURY AND/OR INJURY TO OTHERS AS WELL AS VEHICLE DAMAGE.**



Westin Automotive Products, Inc.
320 W. Covina Blvd
San Dimas, Ca. 91773