



# INSTALLATION INSTRUCTIONS

**PUSH BUMPER ELITEXD WIRE COVER**  
**APPLICATION:**  
**ACCESSORY FOR 36-52315 PUSH BUMPER**  
**PART NUMBER:**  
**36-52135WC**

CONTENT			
ITEM	QUANTITY	DESCRIPTION	TOOLS NEEDED
1	1	WIRE COVER—DRIVER (SHOWN)	15MM SOCKET
2	1	WIRE COVER—PASSENGER	18MM SOCKET
3	2	M12 SOCKET BUTTON HEAD SCREW	RATCHET
4	2	M12 WASHER	5MM “L” WRENCH
5	2	M12 FLANGE NUT	6MM “L” WRENCH
6	2	M10 SOCKET BUTTON HEAD SCREW	15MM WRENCH
7	2	M10 FLAT WASHER	18MM WRENCH
8	2	M10 FLANGE NUT	
9	2	SPACER	

**ANTI-SEIZE LUBRICANT MUST BE USED ON ALL STAINLESS STEEL FASTENERS TO PREVENT THREAD DAMAGE AND GALLING**

**THIS PRODUCT CAN BE INSTALLED ONLY ON WESTIN PUSH BUMPER ELITE 36-52135**

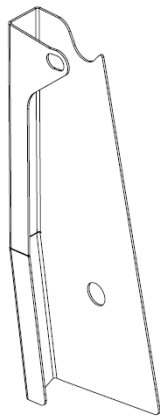

ITEM 1

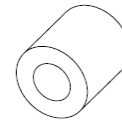

ITEM 9

## PROCEDURE

1. Remove contents from box, verify if all parts listed are present and free from damage.  
Carefully read and understand all instructions before attempting installation.  
**Failure to identify damage before installation could lead to a rejection of any claim.**
2. Starting with the driver side, place wire cover (1), spacer (9) at upright push bumper inner wall and secure them with the M12 hardware (3, 4, & 5) as shown in figure 1.
3. Then install M10 hardware (6, 7, & 8) as shown in figure 1.
4. Tighten hardware to: M10 hardware to 35 ft-lb and M12 hardware to 55 ft-lb.
5. Proceed to the passenger side and repeat steps 2 to 4 to install the passenger side wire cover (2).

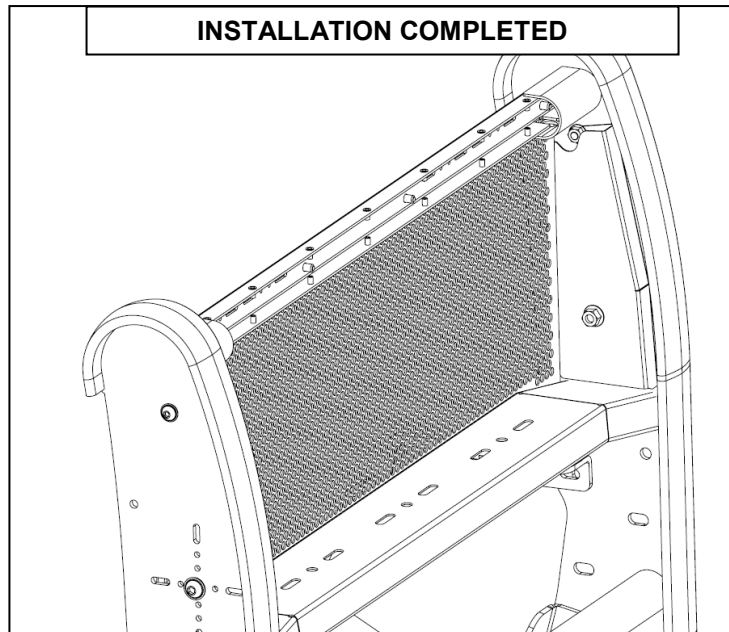
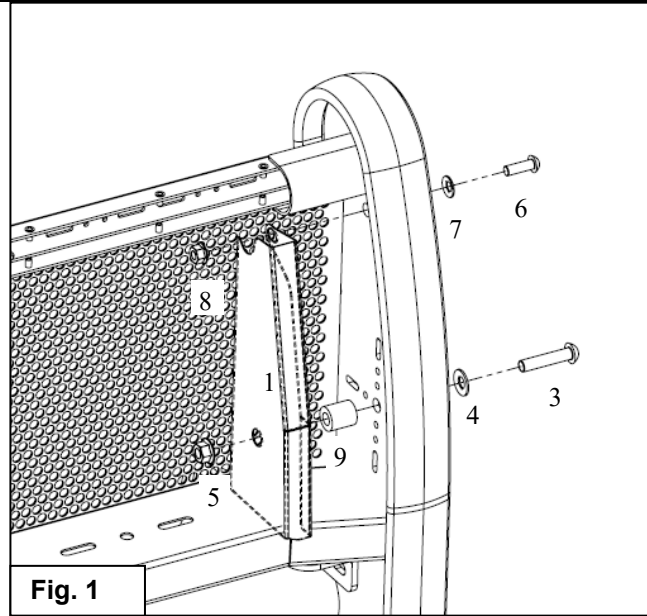

## CARE INSTRUCTIONS

- REGULAR WAXING IS RECOMMENDED. DO NOT USE ANY TYPE OF POLISH OR WAX THAT MAY CONTAIN ABRASIVES
- STAINLESS STEEL PRODUCTS CAN BE CLEANED WITH MILD SOAP AND WATER. STAINLESS STEEL POLISH SHOULD BE USED TO POLISH SMALL SCRATCHES.
- GLOSS BLACK FINISHES SHOULD BE CLEANED WITH MILD SOAP AND WATER



## WARNING



Failure to follow these instructions could lead to death, personal injury, and / or property damage.

Failure to follow these instructions could lead to death, personal injury, and / or property damage.

### FASTENERS:

All Westin supplied fasteners must be utilized and installed in accordance with the installation instructions and apply torque to the specifications as defined. **DOUBLE CHECK ALL FASTENERS BEFORE INITIAL USE, AND PERIODICALLY IN THE FUTURE TO ENSURE PROPER FUNCTION AND SAFETY.**

### DRILLING:

Most Westin products do not require drilling for installation. If drilling is defined as required, use caution when drilling a vehicle. **FAILURE TO REVIEW AN AREA TO BE DRILLED MAY RESULT IN PERSONAL INJURY AND/OR INJURY TO OTHERS AS WELL AS VEHICLE DAMAGE.**

### EYE PROTECTION:

**ALWAYS WEAR SAFETY GLASSES OR GOGGLES DURING THE INSTALLATION PROCESS TO AVOID PERSONAL INJURY.**

### MAXIMUM TOWING/CARRYING CAPACITY: (if applicable)

The Westin Receiver Hitches will have a visible tow rating label affixed directly on the product. User should never exceed the vehicle manufacturers maximum tow and weight rating regardless of the capacity of the hitch. **FAILURE TO FOLLOW THESE GUIDELINES WILL VOID THE WESTIN WARRANTY AND MAY RESULT IN PERSONAL INJURY AND/OR INJURY TO OTHERS AS WELL AS VEHICLE DAMAGE.**

### FOR CALIFORNIA RESIDENTS ONLY-PROP 65 WARNING:

Some products may contain chemicals such as DEHP, which can cause cancer, birth defects or other reproductive harm. For more info go to [www.p65warnings.ca.gov](http://www.p65warnings.ca.gov)



Westin Automotive Products, Inc.  
320 W. Covina Blvd  
San Dimas, Ca. 91773