

# INSTALLATION INSTRUCTIONS

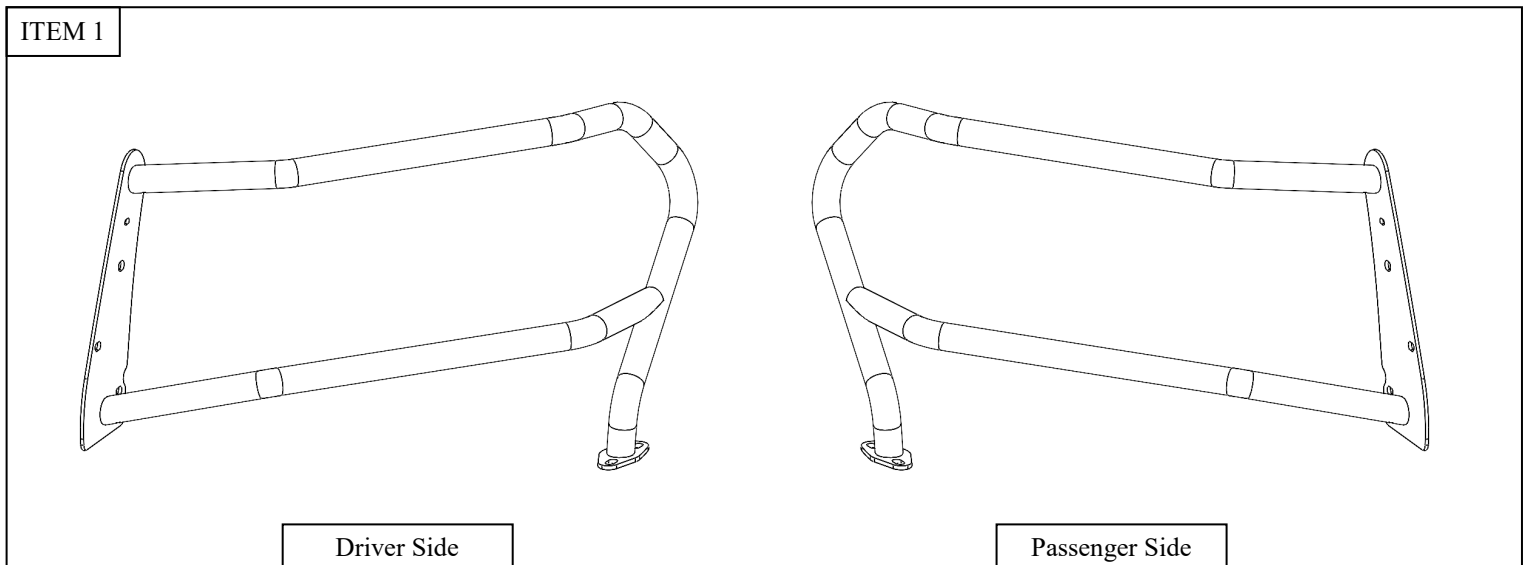

**WING WRAP ELITE**  
**APPLICATION:**  
**2021 Dodge Durango**  
**PART NUMBER:**  
**36-4075W**

CONTENT			
ITEM	QUANTITY	DESCRIPTION	TOOLS NEEDED
1	2	WING WRAP ASSEMBLY (1 DRIVER, 1 PASSENGER)	16MM SOCKET
2	4	M10 BUTTON HEAD HEX SOCKET BOLT	16MM WRENCH
3	4	M10 BELLVILLE WASHER	18MM SOCKET
4	4	M10 SERRATED FLANGE NUT	18MM WRENCH
5	6	M12 BUTTON HEAD HEX SOCKET BOLT	RATCHET
6	6	M12 SERRATED FLANGE NUT	TORQUE WRENCH
7	6	M12 BELLVILLE WASHER	ALLEN WRENCH
8	2	M10 FLANGE HEX HEAD BOLT	
ANTI-SEIZE LUBRICANT MUST BE USED ON ALL STAINLESS STEEL FASTENERS TO PREVENT THREAD DAMAGE AND GALLING			



## PROCEDURE

1. Remove contents from box, verify if all parts listed are present and free from damage.  
Carefully read and understand all instructions before attempting installation.  
**Failure to identify damage before installation could lead to a rejection of any claim.**
2. Once the Push Bumper (P# 36-4075) and the Pit Bar Elite (P# 36-4075PB) have been mounted and adjusted, locate and install the Passenger Side Wing Wrap (Item 2) with the provided hardware as shown in **Figure 1**.
3. Repeat for the Driver Side Wing Wrap.
4. Align and adjust the Wing Wrap as needed then torque all hardware as follows: M10 Hardware to 35 ft-lbs, M12 Hardware to 60 ft-lbs.

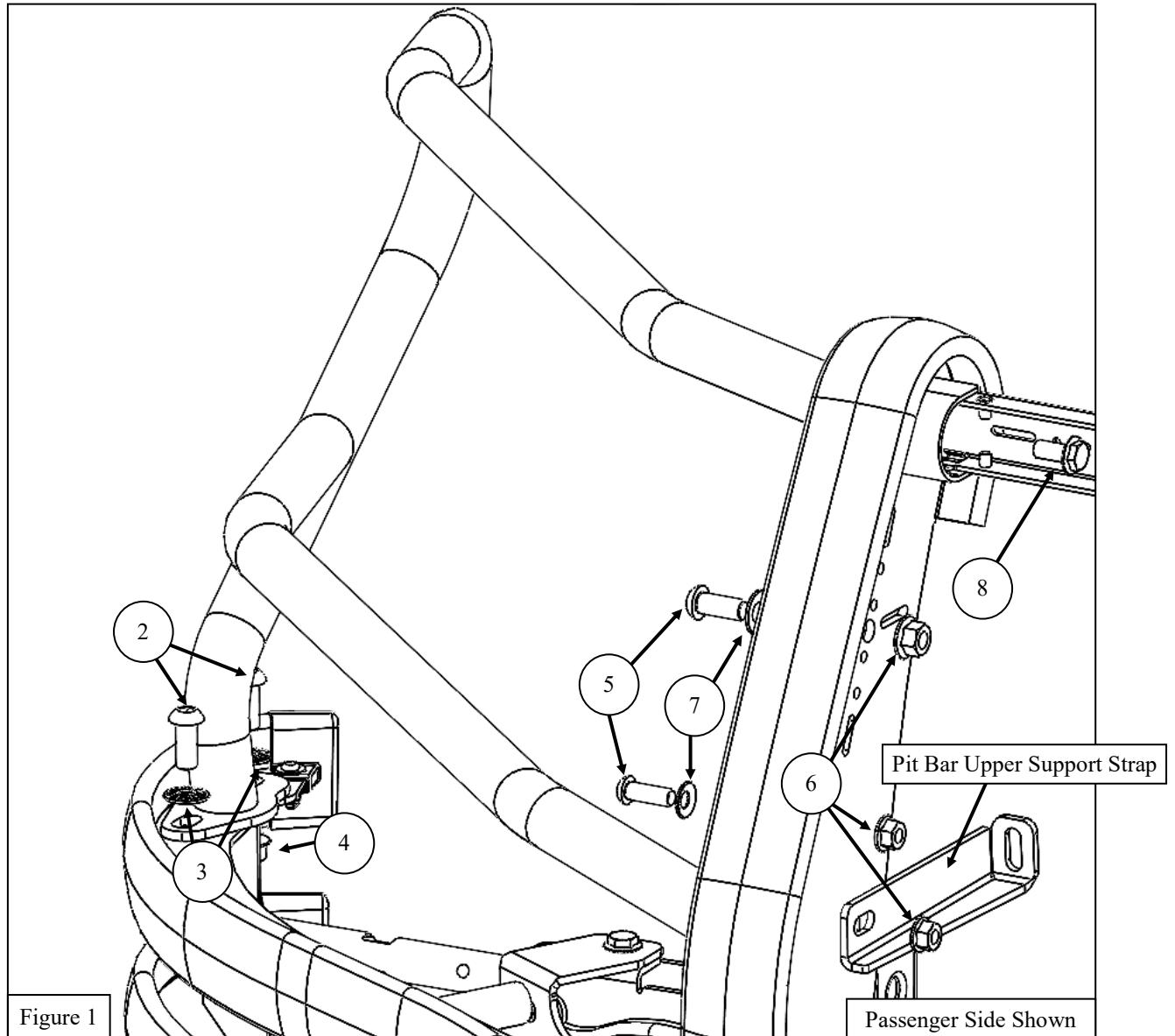

Westin Automotive Products, Inc.  
320 W. Covina Blvd  
San Dimas, Ca. 91773

## Installation Complete



**Note:** Pit Bar (P#4075PB) and Push Bumper (P#4075) depicted are sold separately.

### CARE INSTRUCTIONS

- REGULAR WAXING IS RECOMMENDED. DO NOT USE ANY TYPE OF POLISH OR WAX THAT MAY CONTAIN ABRASIVES.
- STAINLESS STEEL PRODUCTS CAN BE CLEANED WITH MILD SOAP AND WATER. STAINLESS STEEL POLISH SHOULD BE USED TO POLISH SMALL SCRATCHES.
- GLOSS BLACK FINISHES SHOULD BE CLEANED WITH MILD SOAP AND WATER.

**WESTIN**

Westin Automotive Products, Inc.  
320 W. Covina Blvd  
San Dimas, Ca. 91773

Thank you for choosing Westin products  
for additional installation assistance please call  
Customer Service (800) 793-7846  
[www.westinautomotive.com](http://www.westinautomotive.com)



## WARNING



Failure to follow these instructions could lead to death, personal injury, and / or property damage.

Failure to follow these instructions could lead to death, personal injury, and / or property damage.

### FASTENERS:

All Westin supplied fasteners must be utilized and installed in accordance with the installation instructions and apply torque to the specifications as defined. **DOUBLE CHECK ALL FASTENERS BEFORE INITIAL USE, AND PERIODICALLY IN THE FUTURE TO ENSURE PROPER FUNCTION AND SAFETY.**

### DRILLING:

Most Westin products do not require drilling for installation. If drilling is defined as required, use caution when drilling a vehicle. **FAILURE TO REVIEW AN AREA TO BE DRILLED MAY RESULT IN PERSONAL INJURY AND/OR INJURY TO OTHERS AS WELL AS VEHICLE DAMAGE.**

### EYE PROTECTION:

**ALWAYS WEAR SAFETY GLASSES OR GOGGLES DURING THE INSTALLATION PROCESS TO AVOID PERSONAL INJURY.**

### MAXIMUM TOWING/CARRYING CAPACITY: (if applicable)

The Westin Receiver Hitches will have a visible tow rating label affixed directly on the product. User should never exceed the vehicle manufacturers maximum tow and weight rating regardless of the capacity of the hitch. **FAILURE TO FOLLOW THESE GUIDELINES WILL VOID THE WESTIN WARRANTY AND MAY RESULT IN PERSONAL INJURY AND/OR INJURY TO OTHERS AS WELL AS VEHICLE DAMAGE.**

### FOR CALIFORNIA RESIDENTS ONLY-PROP 65 WARNING:

Some products may contain chemicals such as DEHP, which can cause cancer, birth defects or other reproductive harm. For more info go to [www.p65warnings.ca.gov](http://www.p65warnings.ca.gov)



Westin Automotive Products, Inc.  
320 W. Covina Blvd  
San Dimas, Ca. 91773