

# INSTALLATION INSTRUCTIONS



**PUSH BUMPER ELITE**  
**APPLICATION:**  
**2021 Dodge Durango**  
**PART NUMBER:**  
**36-4075**

CONTENT			
ITEM	QUANTITY	DESCRIPTION	TOOLS NEEDED
1	1	PUSH BUMPER	13MM SOCKET
2	1	DRIVER MOUNTING BRACKET	15MM SOCKET
3	1	PASSENGER MOUNTING BRACKET	17MM SOCKET
4	1	DRIVER SUPPORT STRAP	TRIM REMOVAL TOOL
5	1	PASSENGER SUPPORT STRAP	RATCHET
6	2	CLAMP BRACKET	TORQUE WRENCH
7	1	CROSS BAR	
8	10	M8 HEX HEAD BOLT	
9	10	M8 FLAT WASHER	
10	10	M8 LOCK WASHER	
11	2	M10 BUTTON HEAD BOLT	
12	2	M10 BELVILLE WASHER	
13	2	M10 SERRATED FLANGE HEX NUT	
14	4	M12 BUTTON HEAD BOLT	
15	4	M12 BELLVILLE WASHER	
16	4	M12 SERRATED FLANGE HEX NUT	
17	1	DRIVER SIDE CUTTING TEMPLATE	
18	1	PASSENGER SIDE CUTTING TEMPLATE	
19	2	RUBBER STRIP TRIM	

**ANTI-SEIZE LUBRICANT MUST BE USED ON ALL STAINLESS STEEL FASTENERS TO PREVENT THREAD DAMAGE AND GALLING**

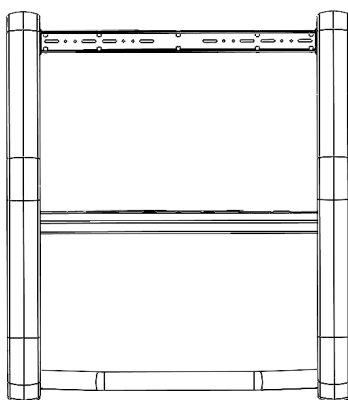

ITEM 1



Westin Automotive Products, Inc.  
320 W. Covina Blvd  
San Dimas, Ca. 91773

Thank you for choosing Westin products  
for additional installation assistance please call  
Customer Service (800) 793-7846  
[www.westinautomotive.com](http://www.westinautomotive.com)

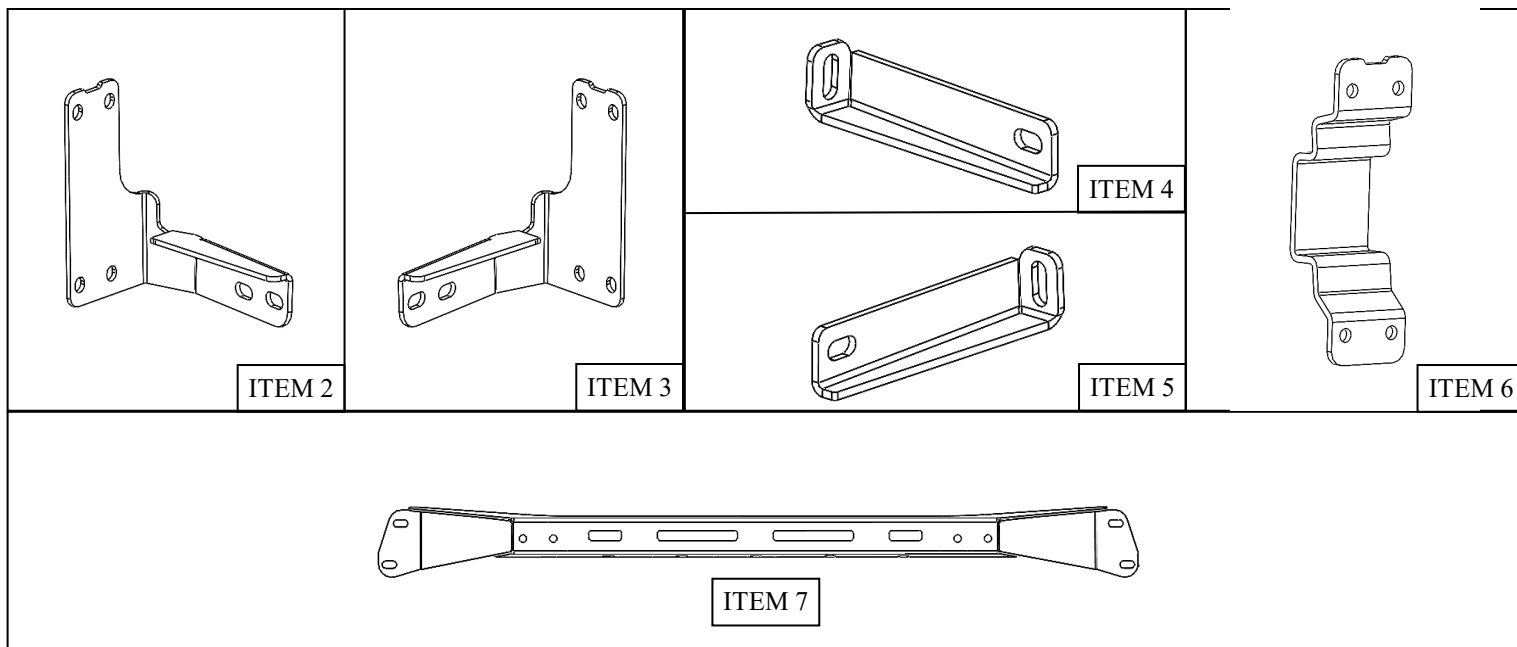

### PROCEDURE

1. Remove contents from box, verify if all parts listed are present and free from damage.  
Carefully read and understand all instructions before attempting installation.  
**Failure to identify damage before installation could lead to a rejection of any claim.**
2. Begin by removing the front fascia trim clips and screws as shown in **Figures 1 through 5.**



**WESTIN**

Westin Automotive Products, Inc.  
320 W. Covina Blvd  
San Dimas, Ca. 91773

Thank you for choosing Westin products  
for additional installation assistance please call  
Customer Service (800) 793-7846  
[www.westinautomotive.com](http://www.westinautomotive.com)

3. There are factory rivets on the driver and passenger side of the front fascia that may need to be drilled out prior to front fascia removal. See **Figures 5 & 6** for reference.
4. Carefully unplug the running light harnesses before completely removing the front fascia of the vehicle. See **Figure 7** for reference.
5. Carefully remove the front fascia of the vehicle. **Note:** Additional help may be needed to remove the fascia.

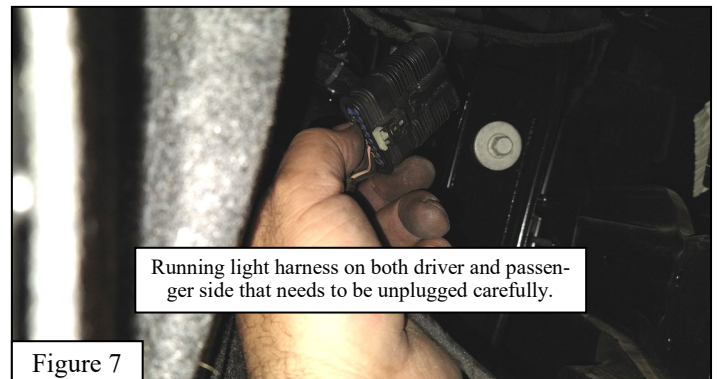
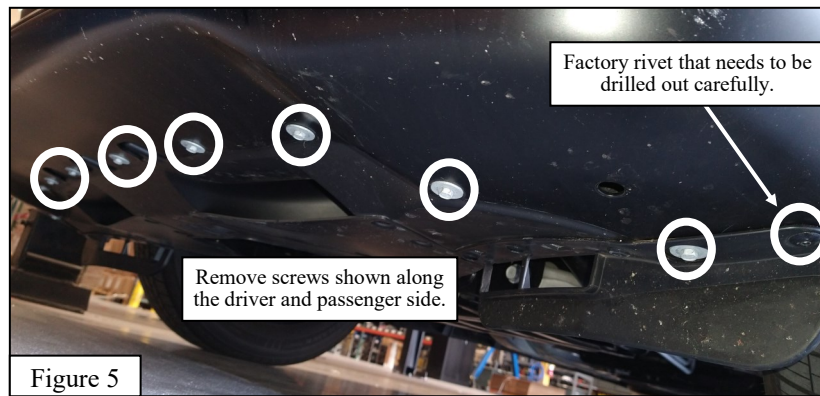

6. Once the front fascia is removed, the OEM foam shock absorber may be removed and discarded since you will not reuse it. See **Figure 8** for reference.
7. Continue to trim the plastic radiator shroud corner using a trimming tool to reveal mounting bracket locations. See **Figures 9 through 11** for reference.





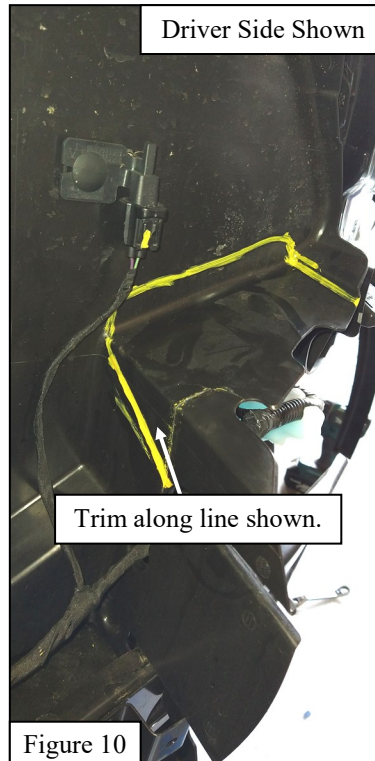
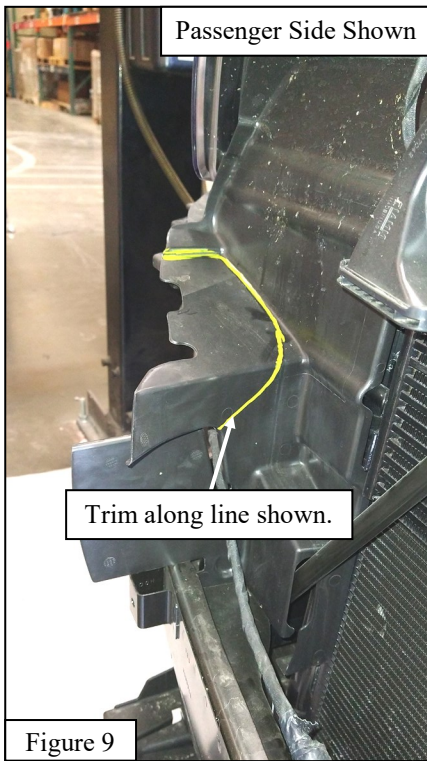

8. Moving on to the front fascia of the vehicle, cut and trim at the center location shown in **Figures 12 & 13**. *Note: Cut about 3" downward into the vehicle fascia and about 1 1/4" inward into the fascia toward the front of the vehicle to allow maximum clearance for the Cross Bar that will be installed later.*

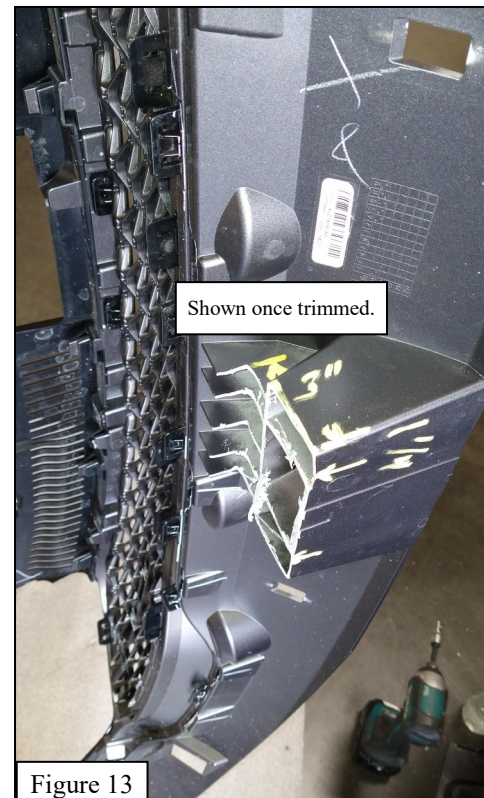
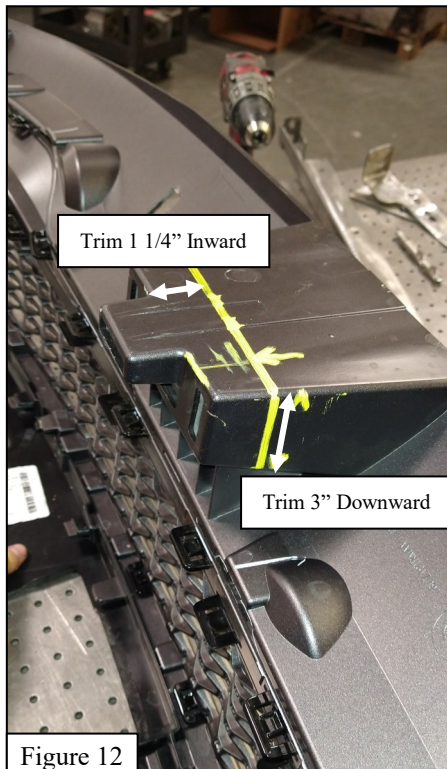

9. Using supplied M8 Hardware, install the Clamp Brackets (Item 6) and the Driver and Passenger Mounting Brackets accordingly to the vehicle crossbar (Items 2 & 3). See **Figure 14** for reference.

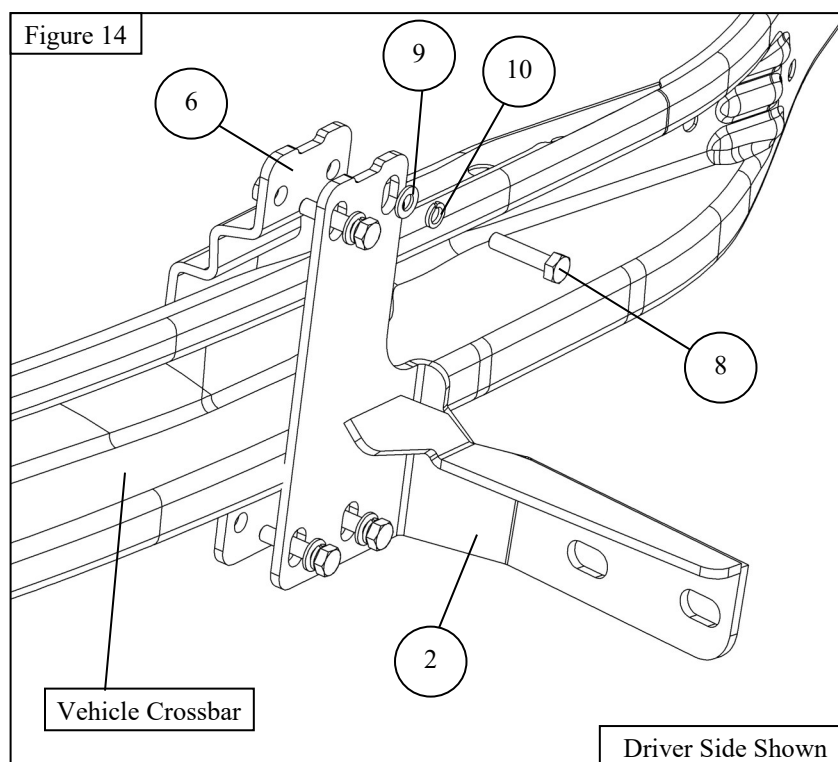

10. Measure between the tips of the Driver and Passenger Mounting Brackets. Make sure they are spaced around 26" apart and centered to the vehicle. See **Figure 15** for reference.

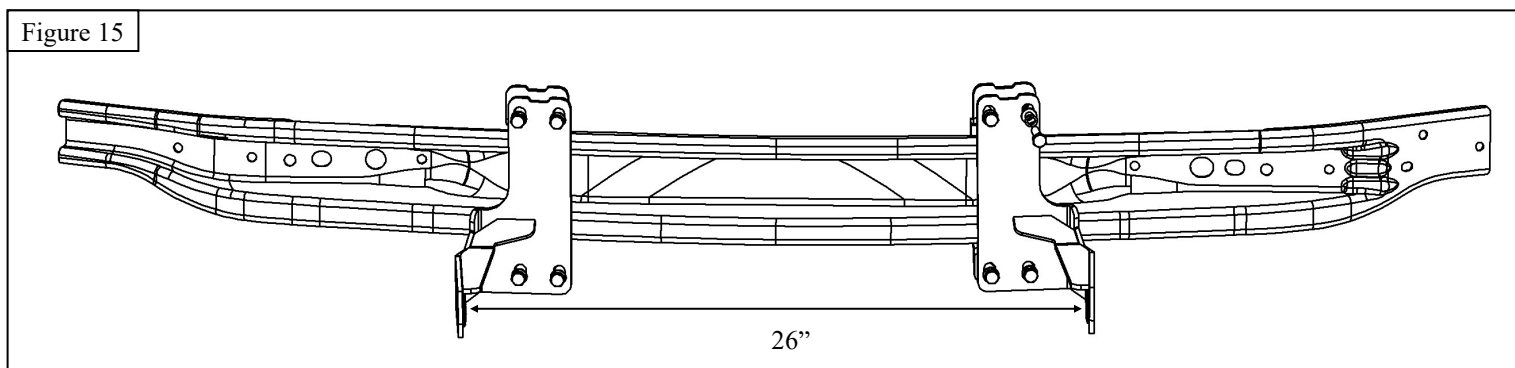

11. Locate and install the Cross Bar (Item 7) to the front radiator support using the OEM factory hardware. See **Figure 16** for reference.

Figure 16

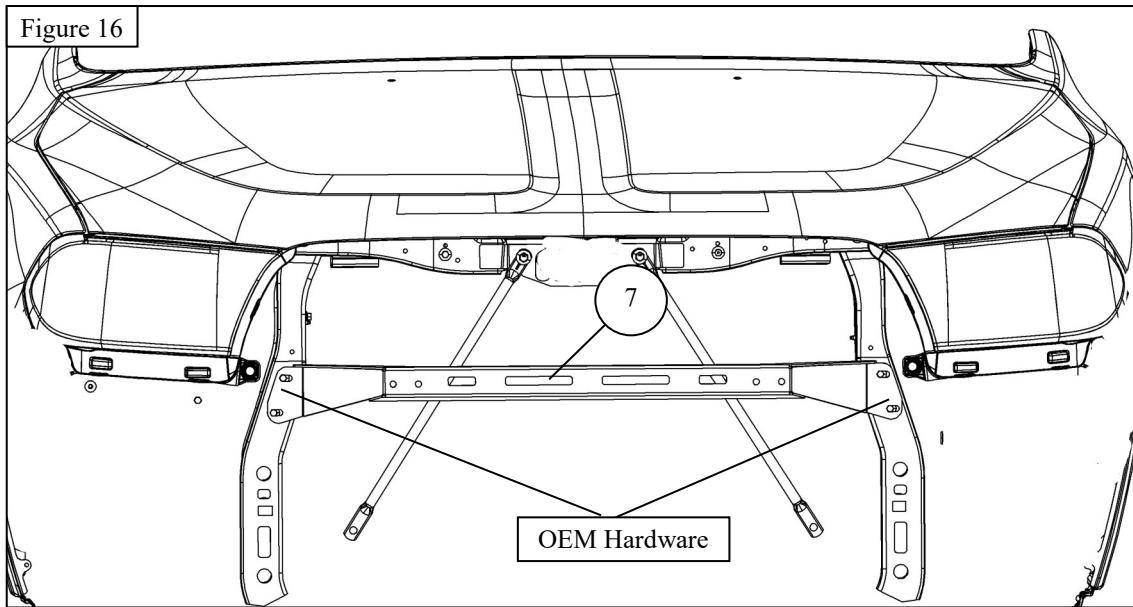

12. Once all the mounting brackets have been assembled (**except the Support Straps**), use the provided M12 hardware to test fit the Push Bumper (Item 1) on the vehicle without the front fascia.
13. Align and adjust the brackets and the Push Bumper as needed, and tighten and torque all the mounting brackets to the vehicle as specified: M8 to 15-18 ft.-lbs. See **Figure 17** for reference.
14. After test fit, remove the Push Bumper.

Figure 17

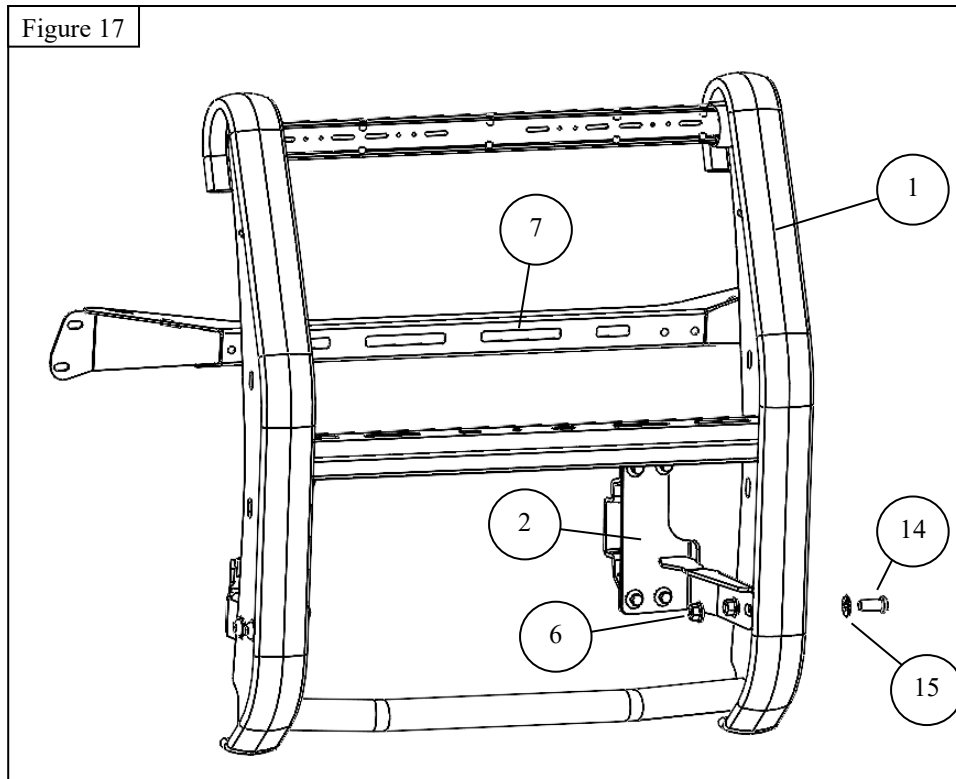



15. Before replacing the fascia onto the vehicle, trimming of the lower valence area is required to allow clearance for the Driver and Passenger Mounting brackets (Items 2 & 3). See **Figures 18 & 19** for reference. **Note:** Measurements are approximations. Trim in the directions shown in the given figures.

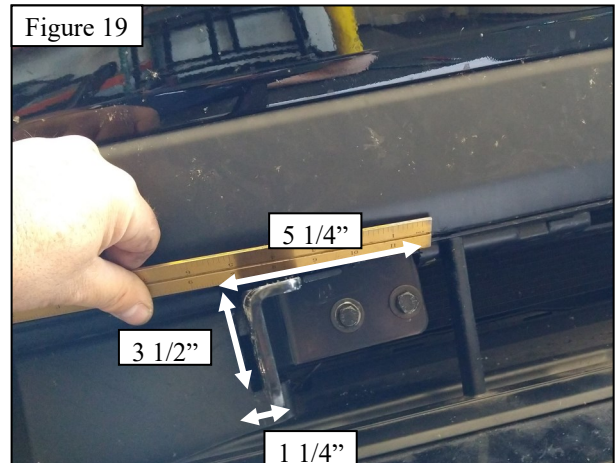
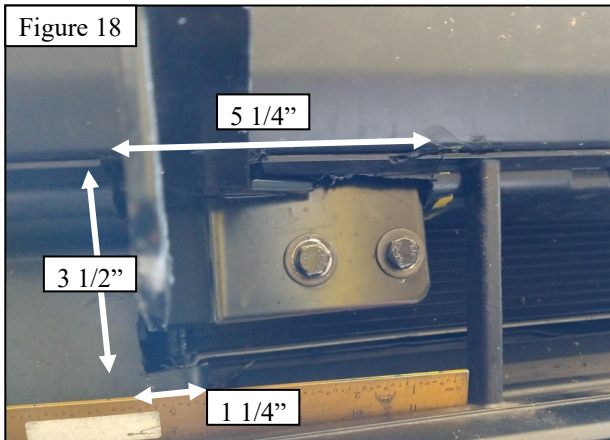

16. Plug in the running lights to the front fascia and reinstall the fascia onto the vehicle carefully over the previously installed brackets. Ensure that every bracket has enough clearance.
17. Using the provided Driver and Passenger Side Cutting Templates (Items 17 & 18), cut into the front vehicle fascia to allow clearance for the Driver and Passenger Support Straps.

**Cutting Instructions using the provided Cutting Templates (Items 22 & 23)**

- Align the template properly as shown. You can use a 2" hole saw to make the clearance opening for the Support Straps. See **Figure 20 and 21** for reference.
- Be **VERY** careful when drilling and cutting. Make sure the bracket will be at the center of the drilled hole.

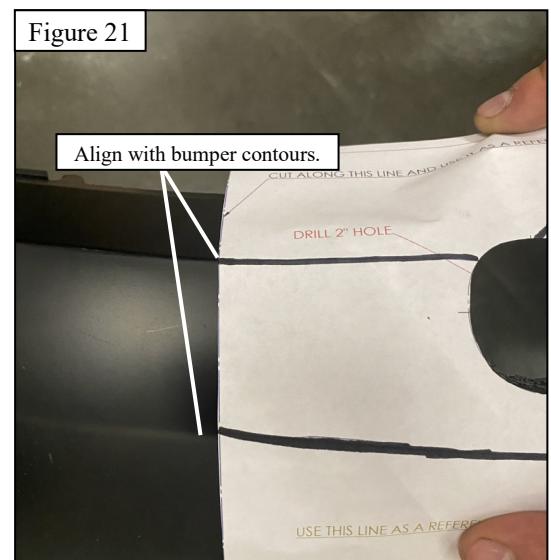
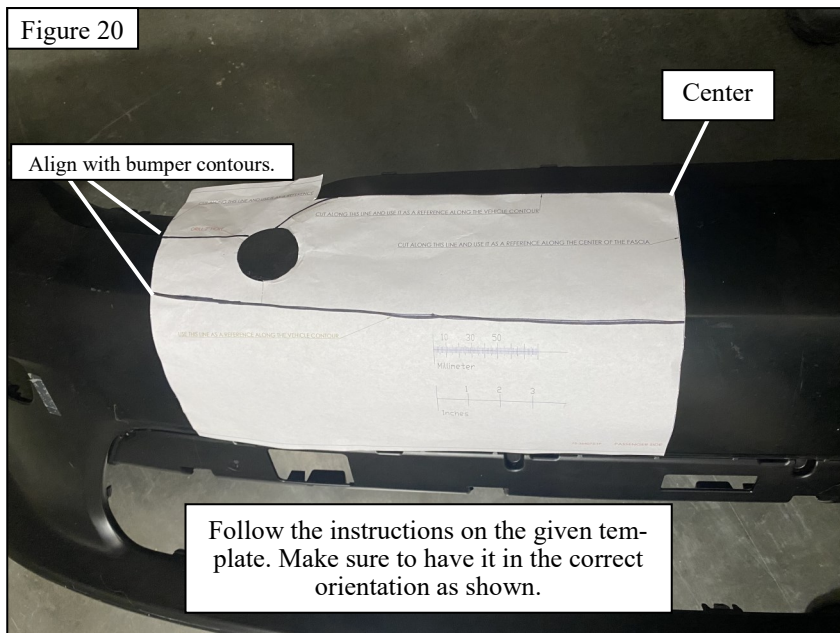

18. Using supplied M8 hardware, loosely assemble the Driver and Passenger Support Straps (Items 4 & 5) to the Cross Bar. See **Figure 22 & 23** for reference.
19. Reinstall the Push Bumper (Item 1) using the provided M12 hardware at the Driver and Passenger Mounting Brackets, M10 Hardware at the outer Driver and Passenger Support Strap mounting point, and M8 Hardware at the center Driver and Passenger Support Strap mounting point. See **Figure 22** for reference.
20. Use the provided Rubber Strip Trim (Item 19) to cover the hole edges on the Upper Support Strap openings created in the vehicle fascia. See **Figure 24** for reference.
21. Align and adjust the bumper as needed, and tighten and torque hardware as specified: M8 to 15-18 ft. lbs, M10 to 35-38 ft. lbs, M12 to 55-58 ft. lbs.

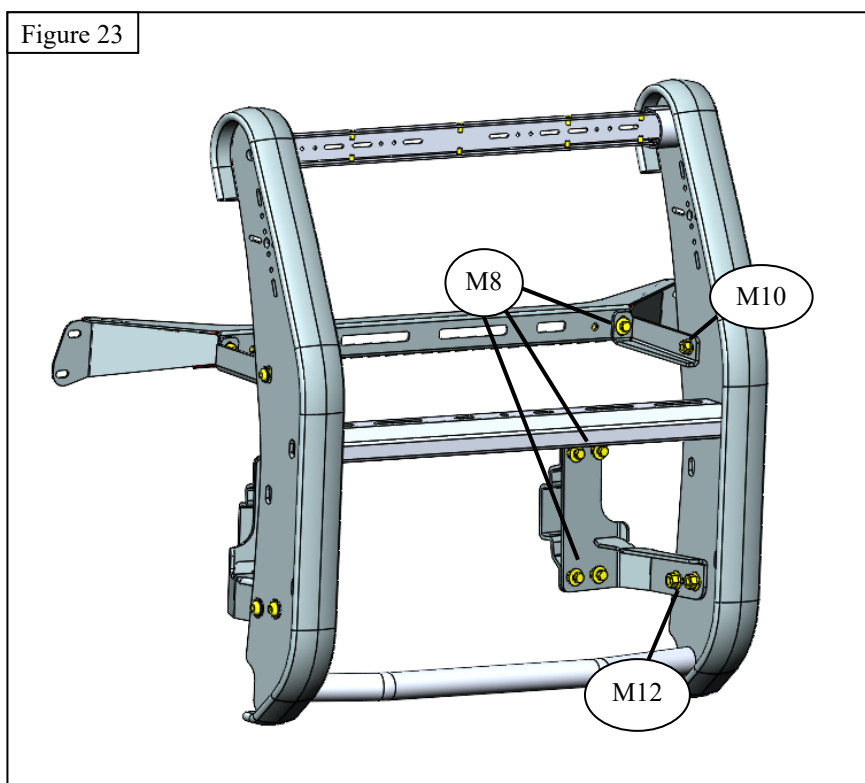
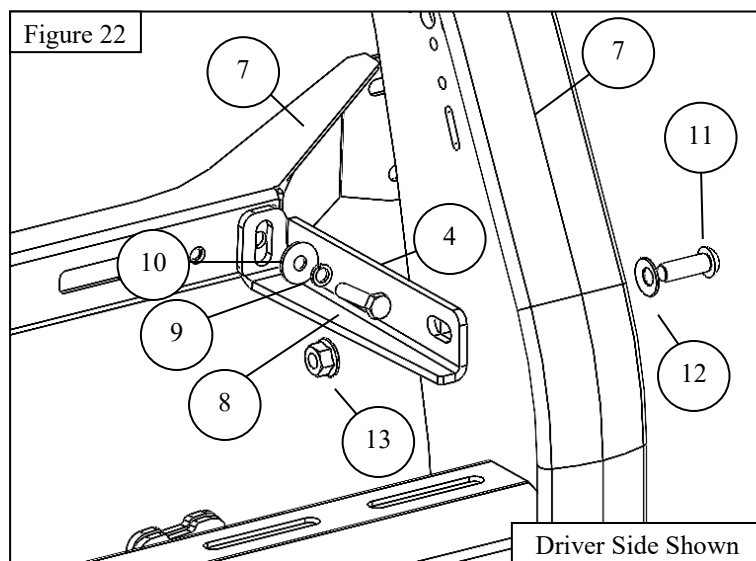
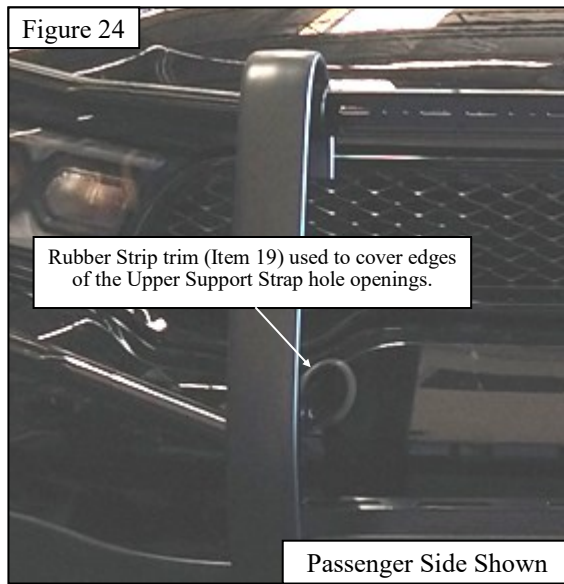
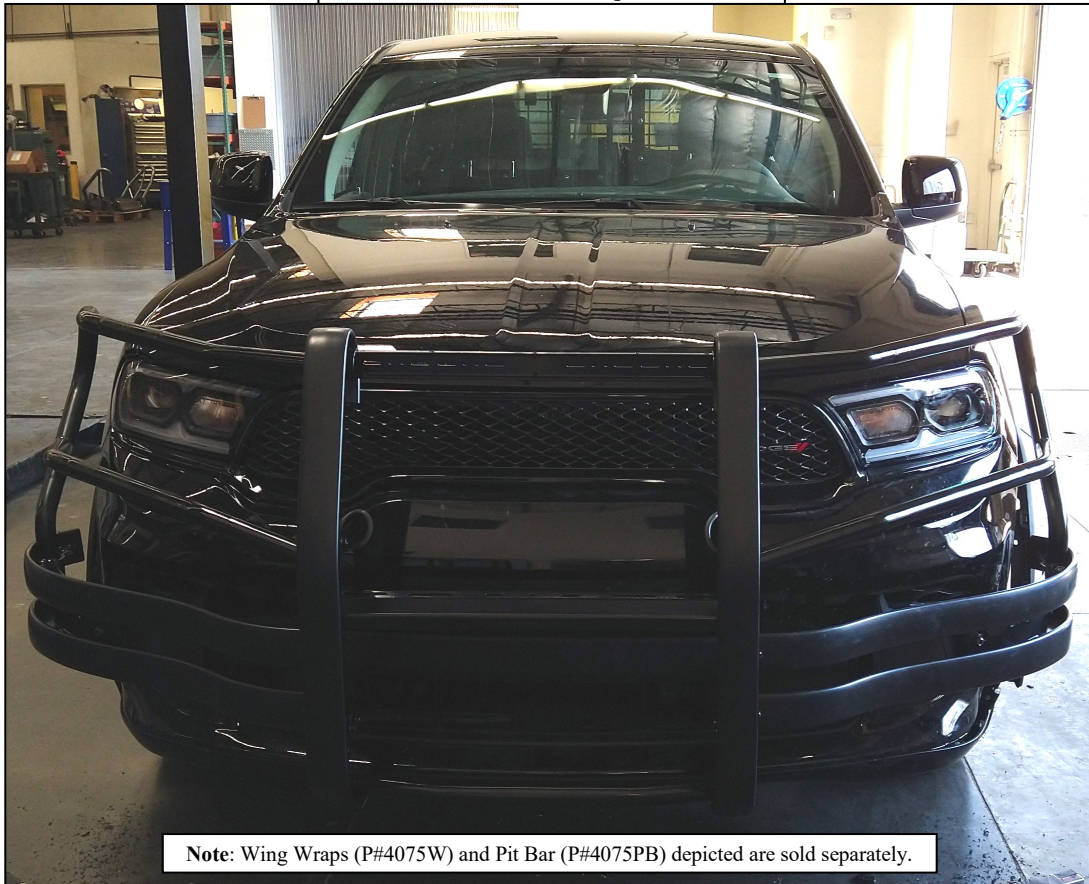



Figure 24



Installation Complete



#### CARE INSTRUCTIONS

- REGULAR WAXING IS RECOMMENDED. DO NOT USE ANY TYPE OF POLISH OR WAX THAT MAY CONTAIN ABRASIVES.
- STAINLESS STEEL PRODUCTS CAN BE CLEANED WITH MILD SOAP AND WATER. STAINLESS STEEL POLISH SHOULD BE USED TO POLISH SMALL SCRATCHES.
- GLOSS BLACK FINISHES SHOULD BE CLEANED WITH MILD SOAP AND WATER.

**WESTIN**

Westin Automotive Products, Inc.  
320 W. Covina Blvd  
San Dimas, Ca. 91773

Thank you for choosing Westin products  
for additional installation assistance please call  
Customer Service (800) 793-7846

[www.westinautomotive.com](http://www.westinautomotive.com)

DATE: 09/17/21



## WARNING



Failure to follow these instructions could lead to death, personal injury, and / or property damage.

Failure to follow these instructions could lead to death, personal injury, and / or property damage.

### FASTENERS:

All Westin supplied fasteners must be utilized and installed in accordance with the installation instructions and apply torque to the specifications as defined. **DOUBLE CHECK ALL FASTENERS BEFORE INITIAL USE, AND PERIODICALLY IN THE FUTURE TO ENSURE PROPER FUNCTION AND SAFETY.**

### DRILLING:

Most Westin products do not require drilling for installation. If drilling is defined as required, use caution when drilling a vehicle. **FAILURE TO REVIEW AN AREA TO BE DRILLED MAY RESULT IN PERSONAL INJURY AND/OR INJURY TO OTHERS AS WELL AS VEHICLE DAMAGE.**

### EYE PROTECTION:

**ALWAYS WEAR SAFETY GLASSES OR GOGGLES DURING THE INSTALLATION PROCESS TO AVOID PERSONAL INJURY.**

### MAXIMUM TOWING/CARRYING CAPACITY: (if applicable)

The Westin Receiver Hitches will have a visible tow rating label affixed directly on the product. User should never exceed the vehicle manufacturers maximum tow and weight rating regardless of the capacity of the hitch. **FAILURE TO FOLLOW THESE GUIDELINES WILL VOID THE WESTIN WARRANTY AND MAY RESULT IN PERSONAL INJURY AND/OR INJURY TO OTHERS AS WELL AS VEHICLE DAMAGE.**

### FOR CALIFORNIA RESIDENTS ONLY-PROP 65 WARNING:

Some products may contain chemicals such as DEHP, which can cause cancer, birth defects or other reproductive harm. For more info go to [www.p65warnings.ca.gov](http://www.p65warnings.ca.gov)



Westin Automotive Products, Inc.  
320 W. Covina Blvd  
San Dimas, Ca. 91773