

# INSTALLATION INSTRUCTIONS



## PIT BAR ELITE

APPLICATION: Tahoe 2021-2022 PPV (Police Pursuit Vehicle)

PART NUMBER: 36-4045PB

CONTENT			
ITEM	QUANTITY	DESCRIPTION	TOOLS NEEDED
1	1	DRIVER PIT BAR	18 MM SOCKET
2	1	PASSENGER PIT BAR	18 MM WRENCH
3	2	SHORT SPAER	RATCHET
4	2	LONG SPACER	TORQUE WRENCH
5	1	DRIVER MOUNTING BRACKET	ALLEN
6	1	PASSENGER MOUNTING BRACKET	CUTTING TOOL
7	4	M12 BOLT PLATE	MOTOR DRILL
8	1	DRIVER SUPPORT BRACKET	1 1/2" HOLE SAW
9	1	PASSENGER SUPPORT BRACKET	
10	2	SUPPORT PLATE BACKET	
11	12	M12 BUTTON HEAD BOLT (BLACK ZINC)	
12	8	M12 SERRATED FLANGE NUT (BLACK ZINC)	
13	12	M12 BELLVILLE WASHER (BLACK ZINC)	
14	2	M12 LONG HEX HEAD BOLT (YELLOW ZINC)	
15	4	M12 SHORT HEX HEAD BOLT (YELLOW ZINC)	
16	8	M12 SERRATED FLANGE NUT (YELLOW ZINC)	
17	6	M12 FLAT WASHER	
18	1	DRIVER TEMPLATE	
19	1	PASSENGER TEMPLATE	

**ANTI-SEIZE LUBRICANT MUST BE USED ON ALL STAINLESS STEEL FASTENERS TO PREVENT THREAD DAMAGE AND GALLING**

**IMPORTANT NOTICE: PIT BARS WILL INTERFERE WITH FRONT PARK ASSIST SENSORS.**

IF VEHICLE IS EQUIPED WITH FRONT PARK ASSIST SENSORS, VEHICLE WILL NEED DEALER REFLASH CALIBRATION  
"SERVICE CAL SK5" TO DISABLE THE FRONT PARK ASSIST.

### PROCEDURE

1. Remove contents from box, verify if all parts listed are present and free from damage.  
Carefully read and understand all instructions before attempting installation.  
**Failure to identify damage before installation could lead to a rejection of any claim.**



Westin Automotive Products, Inc.  
320 W. Covina Blvd  
San Dimas, Ca. 91773

Thank you for choosing Westin products  
for additional installation assistance please call  
Customer Service (800) 793-7846  
[www.westinautomotive.com](http://www.westinautomotive.com)

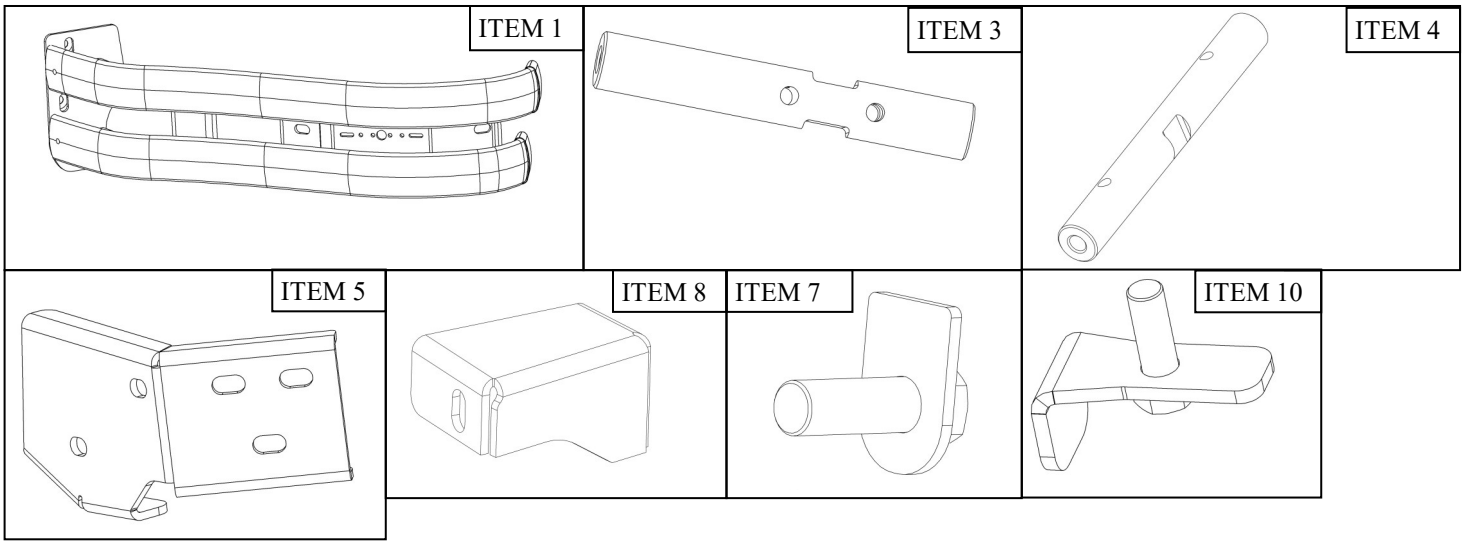

**NOTE:**

**This pit bar kit is to be installed with PN: 36-4045 at the same time.**

**If installing in a civilian vehicle, the product will not work with factory parking sensors. (See note on page 1)**

- With the fascia removed, drill out both the front/rear factory holes shown in **Figure 1 to 9/16"** on both the driver and passenger side.

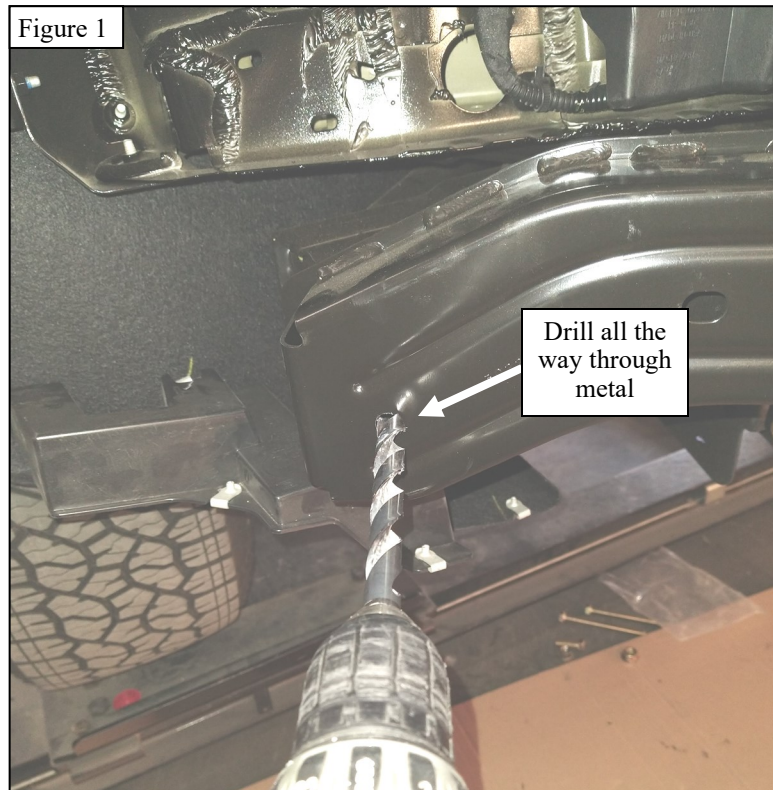

Westin Automotive Products, Inc.  
320 W. Covina Blvd  
San Dimas, Ca. 91773

Thank you for choosing Westin products  
for additional installation assistance please call  
Customer Service (800) 793-7846  
[www.westinautomotive.com](http://www.westinautomotive.com)

3. Loosely install the pit bar mounting brackets (5, 6) and the support brackets (8,9). Using support plates (10) and M12 hardware. See Figures 2-4

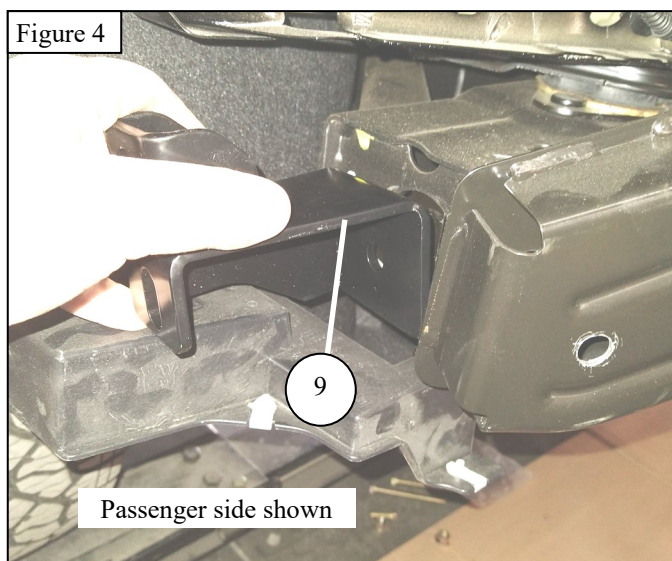
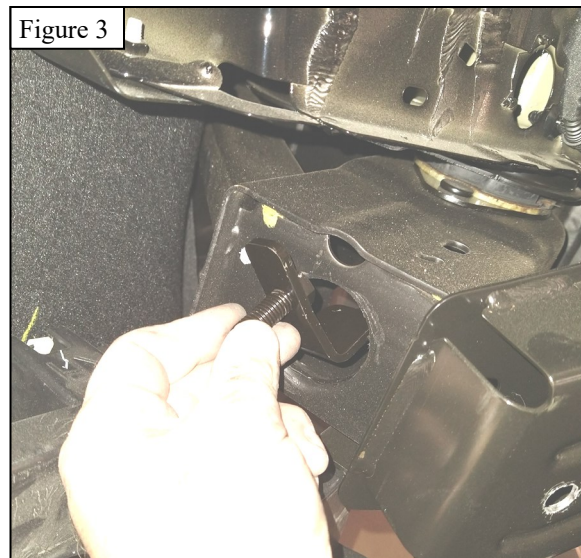
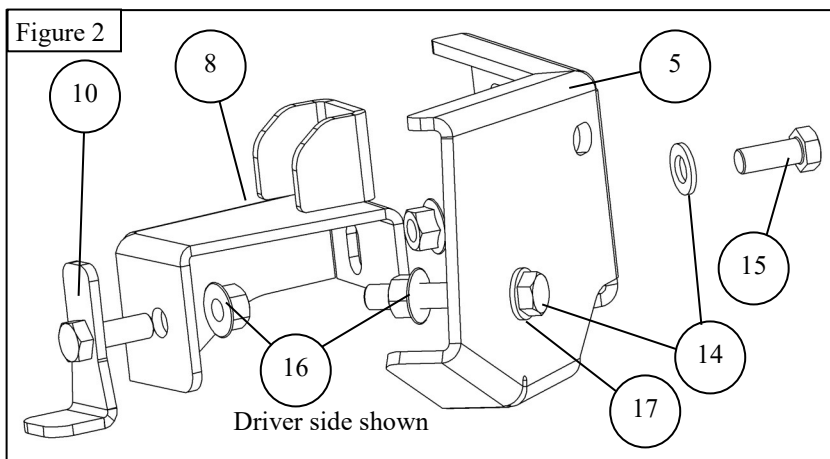

4. Reinstall the fascia and push bumper on the vehicle.

5. Using the provided cutting templates, align template to bumper edge as shown in **Figure 5**, and carefully cut out 1 1/2" D. holes for the pit bar spacers on each side.  
**Note: the outer holes need to be drilled perpendicular to the vehicles tire. See Figure 5-6**
6. Use the bolt plates (7) to install the long and short spacers on each side. The long spacers are mounted on the outer sides of the bumper, and the short spacers mount on the inner sides. **See Figure 7**

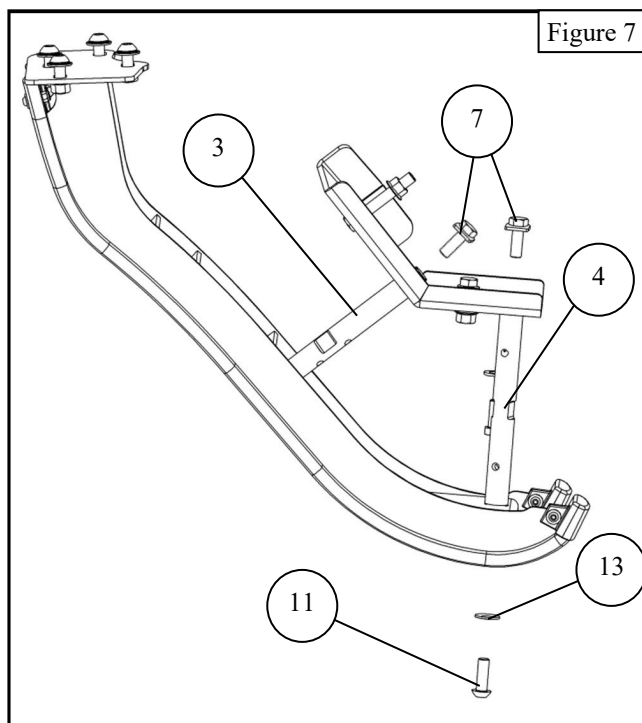
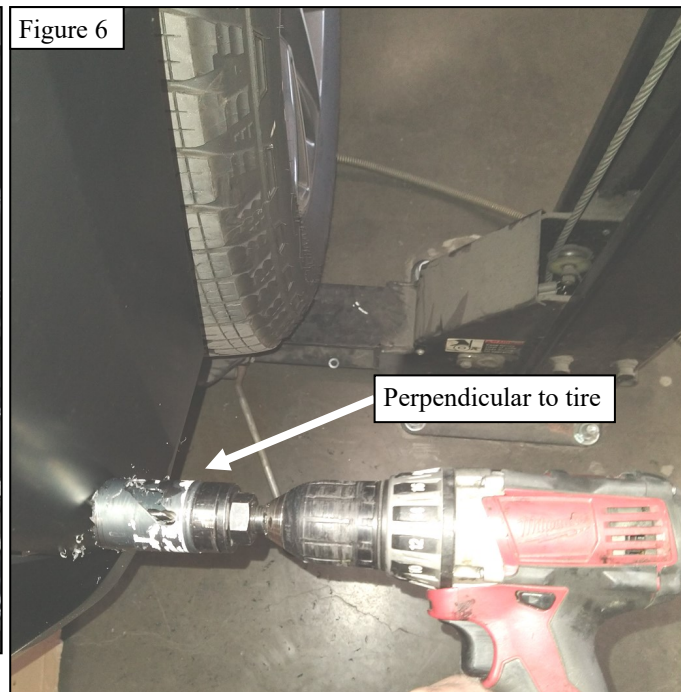
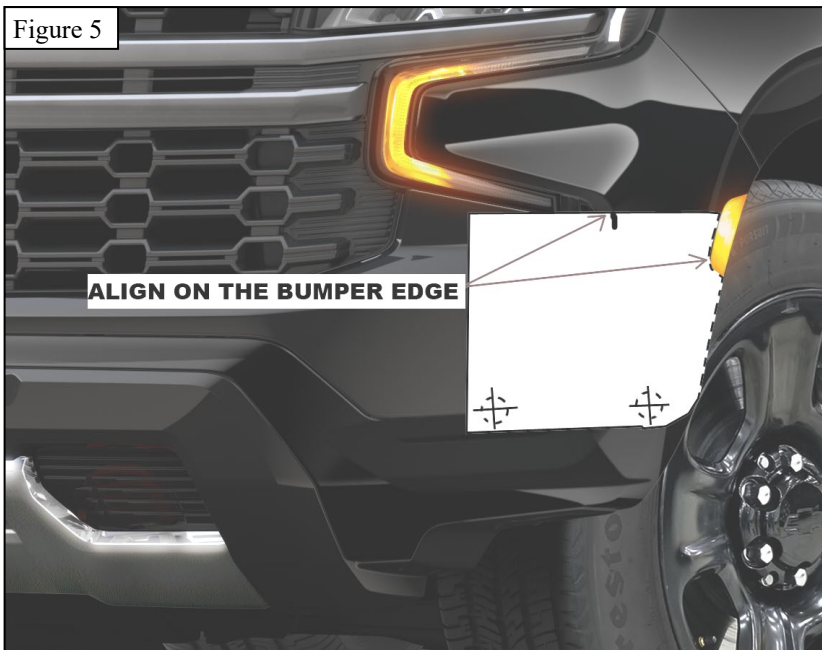



7. Using M12 hardware, assemble the pit bars on to the spacers and push bumper. See Figure 8
8. Adjust all hardware and torque all M12 hardware to 50-55 ft-lbs.

Figure 8

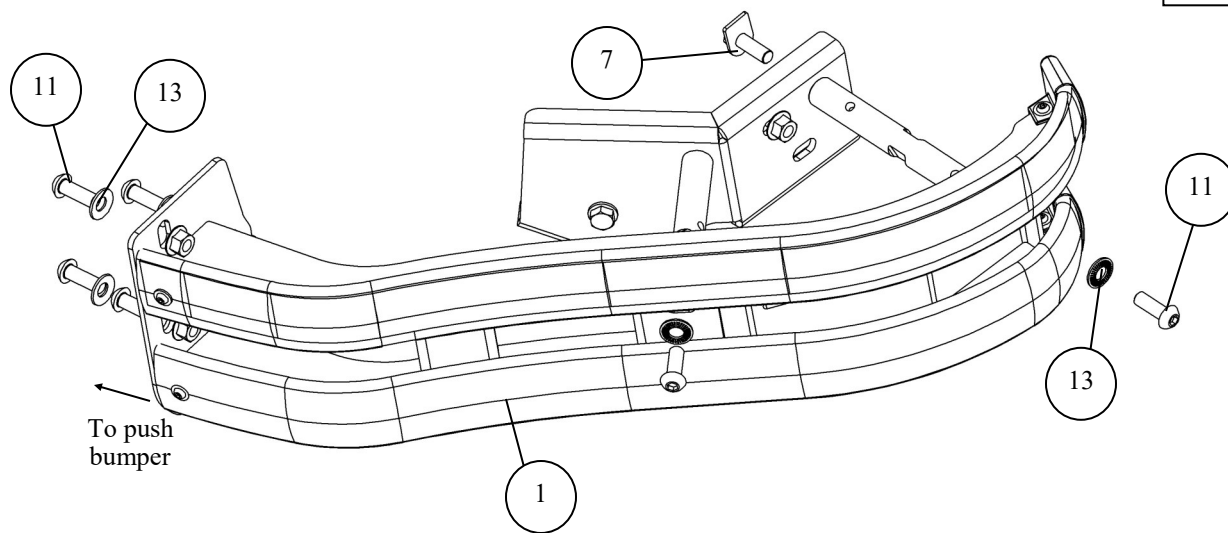

Driver side shown

#### INSTALLATION COMPLETED



#### CARE INSTRUCTIONS

- REGULAR WAXING IS RECOMMENDED. DO NOT USE ANY TYPE OF POLISH OR WAX THAT MAY CONTAIN ABRASIVES.
- STAINLESS STEEL PRODUCTS CAN BE CLEANED WITH MILD SOAP AND WATER. STAINLESS STEEL POLISH SHOULD BE USED TO POLISH SMALL SCRATCHES.
- GLOSS BLACK FINISHES SHOULD BE CLEANED WITH MILD SOAP AND WATER.

**WESTIN**

Westin Automotive Products, Inc.  
320 W. Covina Blvd  
San Dimas, Ca. 91773

Thank you for choosing Westin products  
for additional installation assistance please call  
Customer Service (800) 793-7846  
[www.westinautomotive.com](http://www.westinautomotive.com)



## WARNING



Failure to follow these instructions could lead to death, personal injury, and / or property damage.

Failure to follow these instructions could lead to death, personal injury, and / or property damage.

### FASTENERS:

All Westin supplied fasteners must be utilized and installed in accordance with the installation instructions and apply torque to the specifications as defined. **DOUBLE CHECK ALL FASTENERS BEFORE INITIAL USE, AND PERIODICALLY IN THE FUTURE TO ENSURE PROPER FUNCTION AND SAFETY.**

### DRILLING:

Most Westin products do not require drilling for installation. If drilling is defined as required, use caution when drilling a vehicle. **FAILURE TO REVIEW AN AREA TO BE DRILLED MAY RESULT IN PERSONAL INJURY AND/OR INJURY TO OTHERS AS WELL AS VEHICLE DAMAGE.**

### EYE PROTECTION:

**ALWAYS WEAR SAFETY GLASSES OR GOGGLES DURING THE INSTALLATION PROCESS TO AVOID PERSONAL INJURY.**

### MAXIMUM TOWING/CARRYING CAPACITY: (if applicable)

The Westin Receiver Hitches will have a visible tow rating label affixed directly on the product. User should never exceed the vehicle manufacturers maximum tow and weight rating regardless of the capacity of the hitch. **FAILURE TO FOLLOW THESE GUIDELINES WILL VOID THE WESTIN WARRANTY AND MAY RESULT IN PERSONAL INJURY AND/OR INJURY TO OTHERS AS WELL AS VEHICLE DAMAGE.**

### FOR CALIFORNIA RESIDENTS ONLY-PROP 65 WARNING:

Some products may contain chemicals such as DEHP, which can cause cancer, birth defects or other reproductive harm. For more info go to [www.p65warnings.ca.gov](http://www.p65warnings.ca.gov)



Westin Automotive Products, Inc.  
320 W. Covina Blvd  
San Dimas, Ca. 91773