

INSTALLATION INSTRUCTIONS



PIT BAR ELITE
APPLICATION:
Ford Police Interceptor Utility 2020-2025
PART NUMBER:
36-2125PB

| CONTENT | | | |
|----------------|-----------------|--|---------------------|
| ITEM | QUANTITY | DESCRIPTION | TOOLS NEEDED |
| 1 | 1 | DRIVER PIT PAR | RATCHET |
| 2 | 1 | PASSENGER PIT BAR | SCREWDRIVER |
| 3 | 1 | DRIVER MOUNTING BRACKET | 14MM WRENCH |
| 4 | 1 | PASSENGER MOUNTING BRACKET | 14MM SOCKET |
| 5 | 1 | DRIVER SUPPORT BRACKET | ALLEN WRENCH |
| 6 | 1 | PASSENGER SUPPORT BRACKET | 15MM SOCKET |
| 7 | 2 | LONG M12 BOLT PLATE | 13MM SOCKET |
| 8 | 2 | SHORT SPACER | 10MM SOCKET |
| 9 | 2 | LONG SPACER | 8MM SOCKET |
| 10 | 2 | M12 DOUBLE BOLT PLATE | 6MM SOCKET |
| 11 | 2 | SHORT M12 BOLT PLATE | RATCHET EXT. |
| 12 | 1 | DRIVER TEMPLATE | TORQUE WRENCH |
| 13 | 1 | PASSENGER TEMPLATE | HAMMER |
| 14 | 10 | M12 BUTTON HEAD BOLT | UTILITY KNIFE |
| 15 | 10 | M12 SERRATED FLANGE HEX NUT | |
| 16 | 10 | M12 BELLVILLE WASHER | |
| 17 | 2 | MIDDIAN M12 BOLT PLATE. FOR 2025 PIU ONLY | |
| 18 | 2 | POLY RETAINER. FOR 2025 PIU ONLY | |

ANTI-SEIZE LUBRICANT MUST BE USED ON ALL STAINLESS STEEL FASTENERS TO PREVENT THREAD DAMAGE AND GALLING

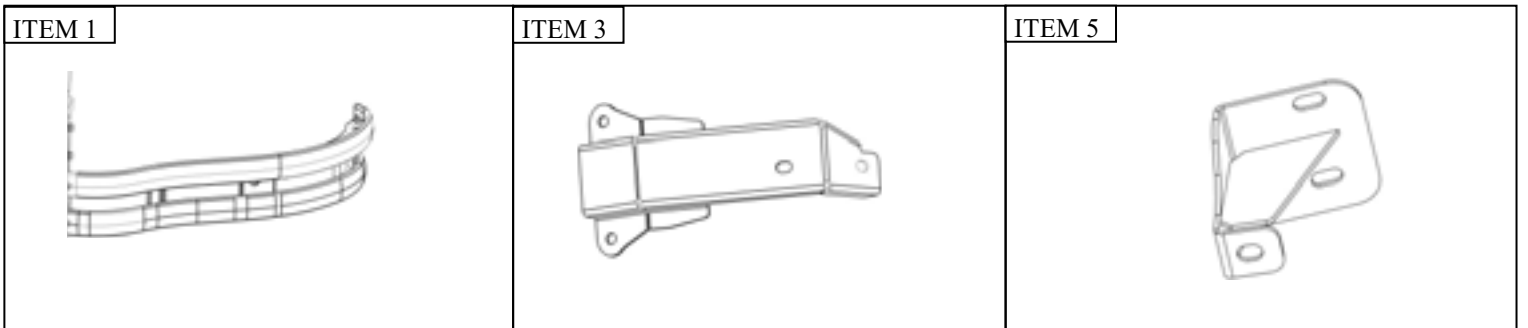

PROCEDURE

1. Remove contents from box, verify if all parts listed are present and free from damage.
Carefully read and understand all instructions before attempting installation.
Failure to identify damage before installation could lead to a rejection of any claim.

NOTE: IF INSTALLING ON 2025 PIU, PLEASE START AT PAGE 3 ,

2. Starting from Step 10 on Install Sheet PN 75-362125 for the 36-2125 push bumper, locate the mounting and support brackets (3-6). Slide the supplied double bolt plate (10) inside the front of the frame. Mount the driver side brackets using the supplied M12 hardware, while holding the bolt plate in place. See **Figures 1, 2 & 3**. Repeat process on the passenger side.
3. Referring to step 11 on Install Sheet PN 75-362125 for 36-2125 push bumper, test fit the push bumper and pit bar brackets with the fascia off. Tighten all the M12 hardware to 50-55 ft lbs.
4. Make a mark on the stock bumper plate as indicated in **Figure 2** and drill a 9/16" hole on both driver and passenger side.

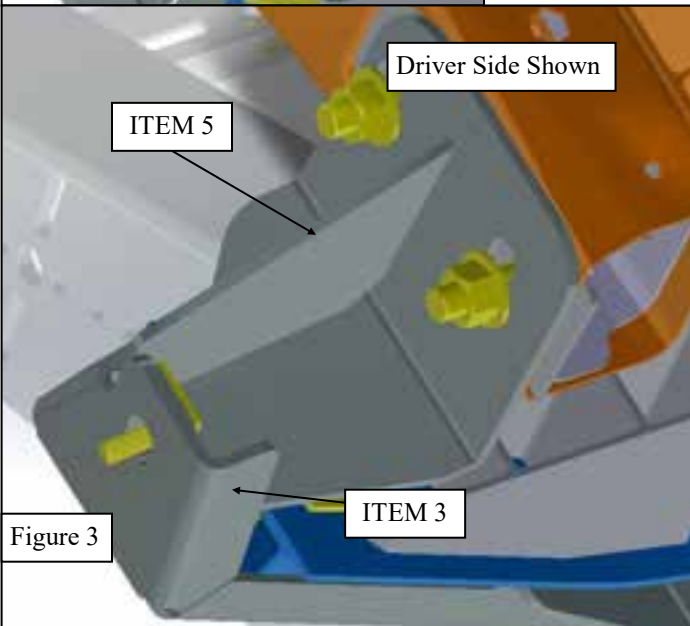
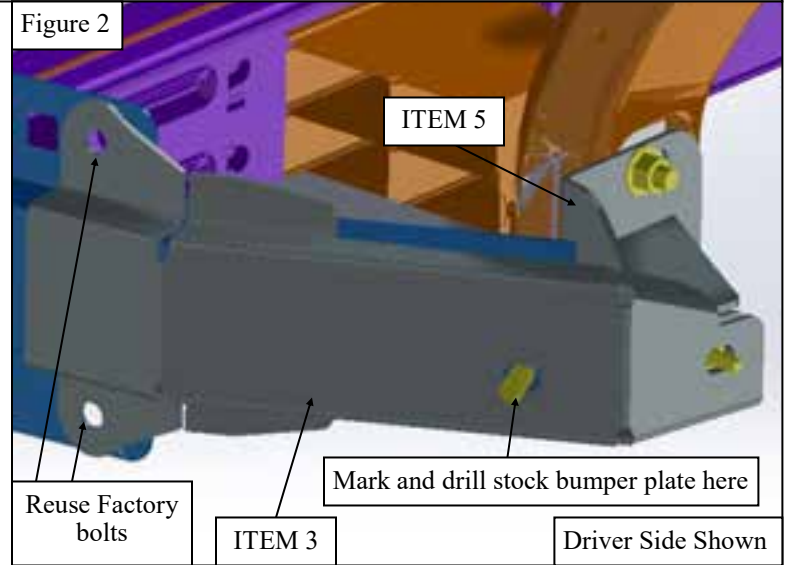
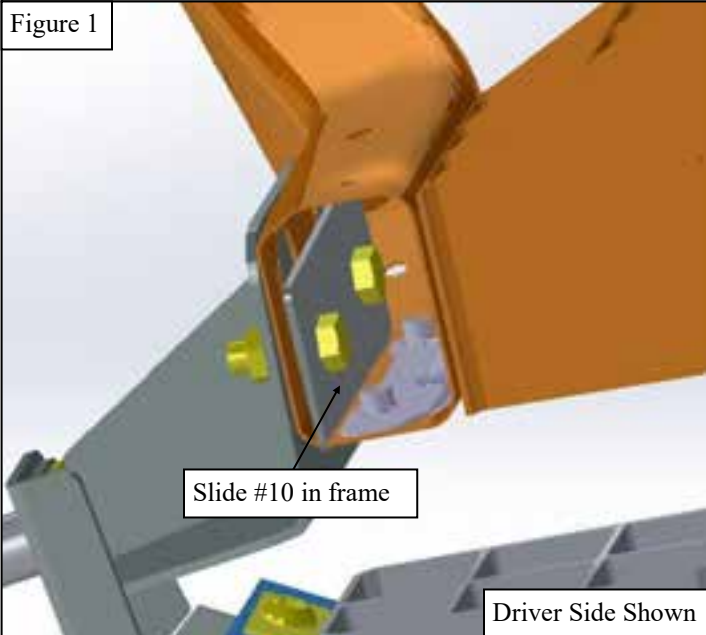

2025 MOUNT BRACKETS INSTALLATION

2. Starting from Step 10 on Install Sheet PN 75-362125 for the 36-2125 push bumper, locate the mounting and support brackets (3-6).
3. Starting with the driver side, slide the supplied double bolt plate #10 inside the front of the frame. Figure 1.
4. Place bracket #5 in the other side of the frame and hold it with two M12 flange nuts #15 onto the studs and leave them loose. Place bolt plate #11 into #10. Figures 1 and 2.
5. Get bracket #3 and place the bolt plate #17 as shown on Figure 3 and place the poly retainer #18 onto the bolt to hold the bolt plate as shown in Figure 4.
6. Remove the OE bolts per Figure 5.
7. Mount the driver side bracket #3 using on M12 flange nut Figure 6, install the nut loosely, and the two OE bolts Figure 7. Tight the OE bolts to 56 lbs, then remove the nut on figure 6. ***It is important that you follow this steps.***
8. Repeat process on the passenger side.
9. Referring to step 11 on Install Sheet PN 75-362125 for 36-2125 push bumper, test fit the push bumper and pit bar brackets with the fascia off. Tighten all the M12 hardware to 50-55 ft lbs.



4. Re-install the fascia but leave the fenders area open so you can access the mounting brackets.



TRIMMING IS REQUIRED ON THE FRONT FASCIA
TRIMMING INSTRUCTIONS:

1. **Measure the reference units on the template to ensure it is the correct size.** If it is not, then please call the customer service line **(800) 793-7846**.
2. Trim and tape the supplied template on to the front fascia per the instructions on the template. **Make sure the template is aligned correctly before trimming fascia.** See Figure 6-7
3. Using a center-punch, mark the center of the two specified holes on the template.
4. Remove the template and using a 1.5" hole saw, cut out the two holes then clean the edges. Figure 8.
5. Repeat on the passenger side

Figure 6

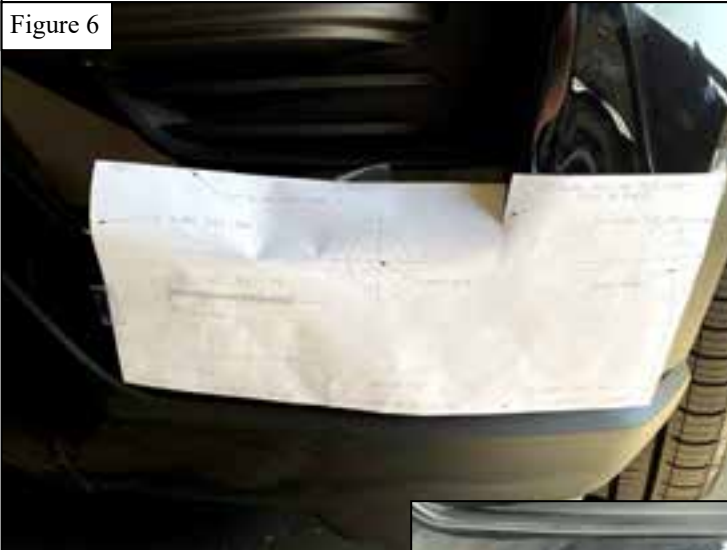
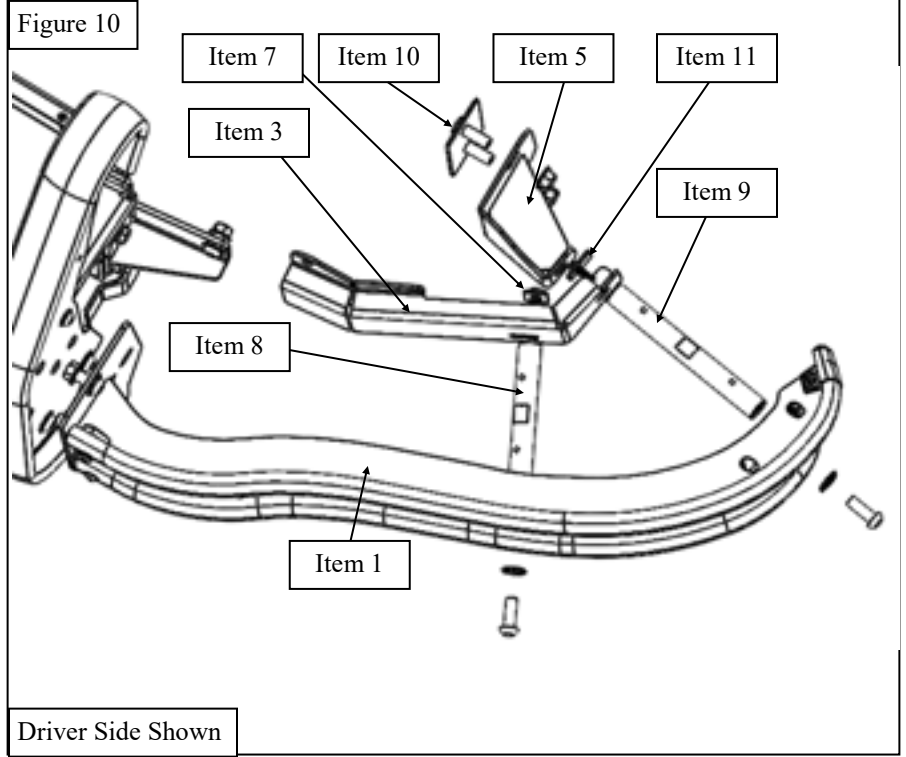

Figure 7

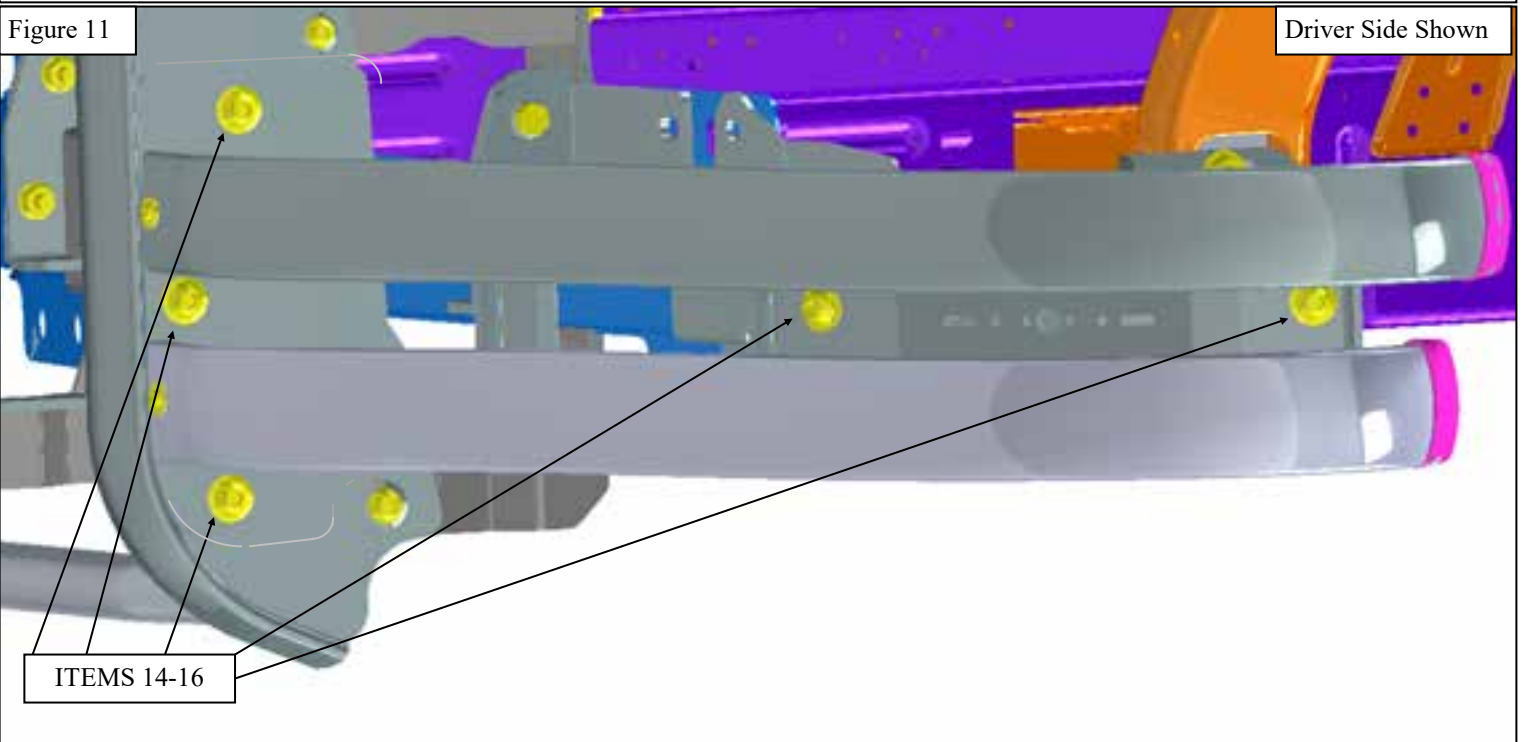

Figure 8

6. Going in between the driver inner fender and fascia, install the short and long M12 bolt plates into the brackets.
7. Install the spacers by placing them into previously cut holes and screw the spacers in to each bolt plate. Repeat on the passenger side. **See Figure 9-10**



8. Refer back to Install Sheet PN 75-362125 to install the push bumper.
9. Install the pit bar sides using the supplied M12 hardware. **See Figure 11.**
10. Align and adjust the Pit Bars as necessary. Tighten all remaining fasteners : M12 to 50-55 ft-lbs.



INSTALLATION COMPLETE



CARE INSTRUCTIONS

- REGULAR WAXING IS RECOMMENDED. DO NOT USE ANY TYPE OF POLISH OR WAX THAT MAY CONTAIN ABRASIVES.
- STAINLESS STEEL PRODUCTS CAN BE CLEANED WITH MILD SOAP AND WATER. STAINLESS STEEL POLISH SHOULD BE USED TO POLISH SMALL SCRATCHES.
- GLOSS BLACK FINISHES SHOULD BE CLEANED WITH MILD SOAP AND WATER.

WESTIN Westin Automotive Products, Inc.
320 W. Covina Blvd
San Dimas, Ca. 91773

Thank you for choosing Westin products
for additional installation assistance please call
Customer Service (800) 793-7846
www.westinautomotive.com



WARNING



Failure to follow these instructions could lead to death, personal injury, and / or property damage.

Failure to follow these instructions could lead to death, personal injury, and / or property damage.

FASTENERS:

All Westin supplied fasteners must be utilized and installed in accordance with the installation instructions and apply torque to the specifications as defined. **DOUBLE CHECK ALL FASTENERS BEFORE INITIAL USE, AND PERIODICALLY IN THE FUTURE TO ENSURE PROPER FUNCTION AND SAFETY.**

DRILLING:

Most Westin products do not require drilling for installation. If drilling is defined as required, use caution when drilling a vehicle. **FAILURE TO REVIEW AN AREA TO BE DRILLED MAY RESULT IN PERSONAL INJURY AND/OR INJURY TO OTHERS AS WELL AS VEHICLE DAMAGE.**

EYE PROTECTION:

ALWAYS WEAR SAFETY GLASSES OR GOGGLES DURING THE INSTALLATION PROCESS TO AVOID PERSONAL INJURY.

MAXIMUM TOWING/CARRYING CAPACITY: (if applicable)

The Westin Receiver Hitches will have a visible tow rating label affixed directly on the product. User should never exceed the vehicle manufacturers maximum tow and weight rating regardless of the capacity of the hitch. **FAILURE TO FOLLOW THESE GUIDELINES WILL VOID THE WESTIN WARRANTY AND MAY RESULT IN PERSONAL INJURY AND/OR INJURY TO OTHERS AS WELL AS VEHICLE DAMAGE.**

FOR CALIFORNIA RESIDENTS ONLY-PROP 65 WARNING:

Some products may contain chemicals such as DEHP, which can cause cancer, birth defects or other reproductive harm. For more info go to www.p65warnings.ca.gov



Westin Automotive Products, Inc.
320 W. Covina Blvd
San Dimas, Ca. 91773