

## INSTALLATION INSTRUCTIONS

### DEFENDER REAR ELECTRICAL BOX

#### APPLICATION:

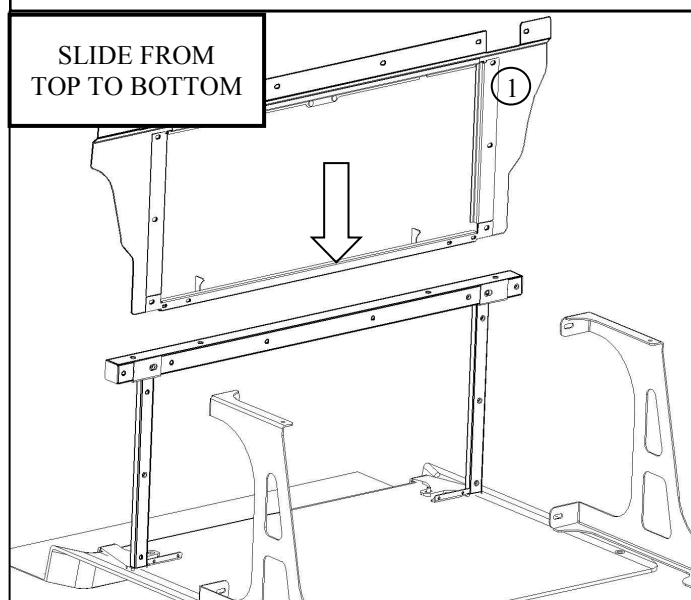
2015-2019 CHEVROLET TAHOE PPV

PART NUMBER: 35-120251

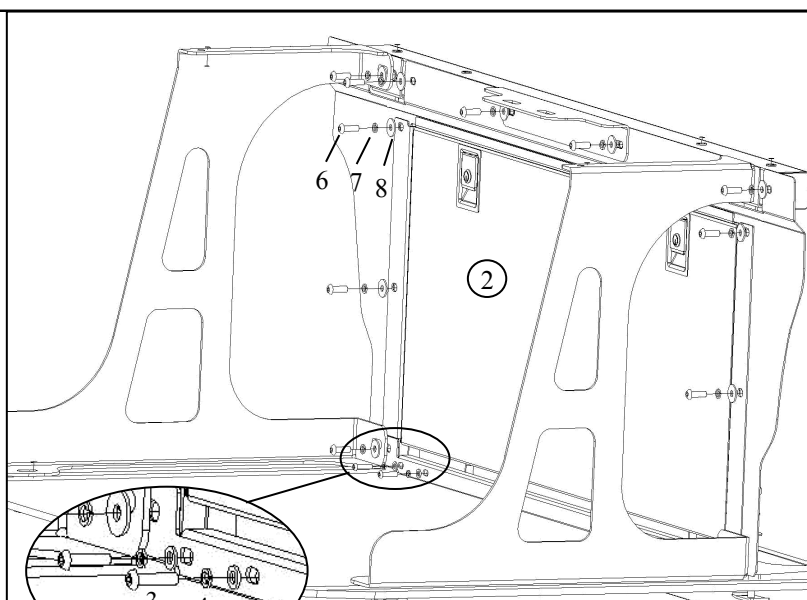
| ITEM | QUANTITY | DESCRIPTION                        | TOOLS NEEDED |
|------|----------|------------------------------------|--------------|
| 1    | 1        | ELECTRICAL BOX FRAME               | 4MM ALLEN    |
| 2    | 1        | ELECTRICAL BOX DOOR                | 5MM ALLEN    |
| 3    | 4        | M6 BUTTON HEAD BOLT (BLACK ZINC)   |              |
| 4    | 4        | M6 LOCK WASHER (BLACK ZINC)        |              |
| 5    | 4        | M6 FLAT WASHER (BLACK ZINC)        |              |
| 6    | 14       | M8 BUTTON HEAD BOLT ( BLACK ZINC)  |              |
| 7    | 14       | M8 SPLIT LOCK WASHER ( BLACK ZINC) |              |
| 8    | 14       | M8 FLAT WASHER (BLACK ZINC)        |              |

**ANTI-SEIZE LUBRICANT MUST BE USED ON ALL STAINLESS STEEL FASTENERS TO PREVENT THREAD DAMAGE AND GALLING**

1. Remove contents from box, verify if all parts listed are present and free from damage. Carefully read and understand all instructions before attempting installation. **Failure to identify damage before installation could lead to a rejection of any claim.**
2. Note: This Electrical box must be installed with our Defender rear partition 35-12025. Proceed to the installation of the rear partition 35-120025, and stop at the step 10 from the rear partition's installation instructions. Then proceed to install the electrical box.
3. Remove the electrical box door (2) from the frame (1). And Install the electrical box frame (1) instead of the filler panel, by sliding it from top to bottom. **Figure 1**. Use M8 hardware (6, 7, 8) **Figure 2** and M6 Hardware (3, 4, 5) at the bottom 4 slots holes to install it **Figure 2** , **View 1**. Leave the hardware loose for now.
4. Finish the installation of the parts of the rest of the Defender rear partition 35-12025.
5. Square and center everything with the vehicle. Tighten hardware to: M6 hardware to 6-8 ft-lbs, M8 hardware to 22-27 ft-lbs, M10 hardware to 51-56 ft-lbs and M12 hardware to 92-97 ft-lbs. And place electrical box door back (2).

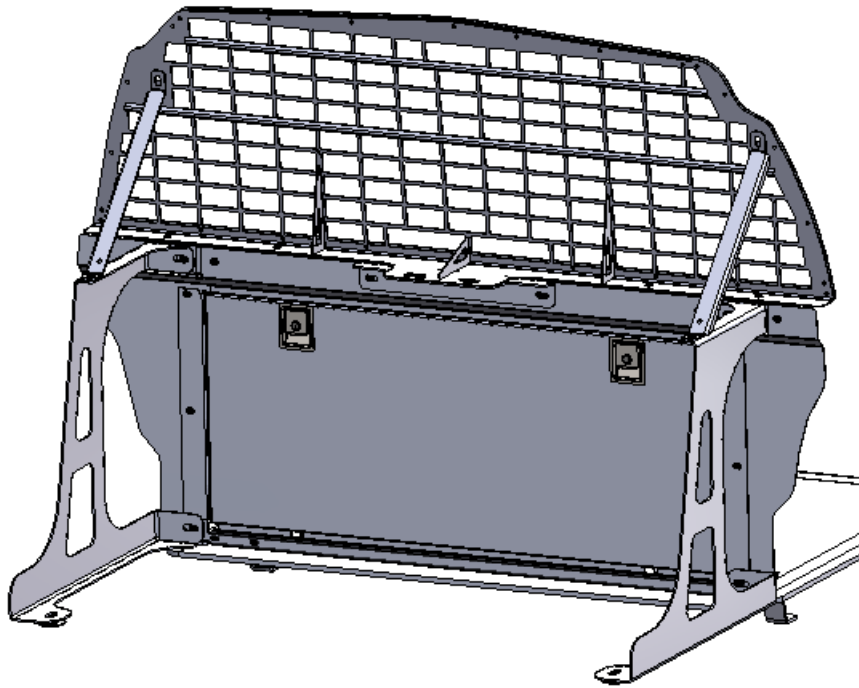


**Figure 1** **INSTALLATION TIME: 25 - 35 MINUTES**



**Figure 2**

INSTALLATION COMPLETED



#### CARE INSTRUCTIONS

- REGULAR WAXING IS RECOMMENDED. DO NOT USE ANY TYPE OF POLISH OR WAX THAT MAY CONTAIN ABRASIVES.
- STAINLESS STEEL PRODUCTS CAN BE CLEANED WITH MILD SOAP AND WATER. STAINLESS STEEL POLISH SHOULD BE USED TO POLISH SMALL SCRATCHES.
- GLOSS BLACK FINISHES SHOULD BE CLEANED WITH MILD SOAP AND WATER.

**WESTIN** Westin Automotive Products, Inc.  
320 W. Covina Blvd  
San Dimas, Ca. 91773

Thank you for choosing Westin products  
for additional installation assistance please call  
Customer Service (800) 793-7846  
[www.westinautomotive.com](http://www.westinautomotive.com)



## WARNING



Failure to follow these instructions could lead to death, personal injury, and / or property damage.

### FASTENERS:

All Westin supplied fasteners must be utilized and installed in accordance with the installation instructions and apply torque to the specifications as defined. **DOUBLE CHECK ALL FASTENERS BEFORE INITIAL USE, AND PERIODICALLY IN THE FUTURE TO ENSURE PROPER FUNCTION AND SAFETY.**

### DRILLING:

Most Westin products do not require drilling for installation. If drilling is defined as required, use caution when drilling a vehicle. **FAILURE TO REVIEW AN AREA TO BE DRILLED MAY RESULT IN PERSONAL INJURY AND/OR INJURY TO OTHERS AS WELL AS VEHICLE DAMAGE.**

### EYE PROTECTION:

**ALWAYS WEAR SAFETY GLASSES OR GOGGLES DURING THE INSTALLATION PROCESS TO AVOID PERSONAL INJURY.**

### MAXIMUM TOWING/CARRYING CAPACITY:

The Westin Receiver Hitches will have a visible tow rating label affixed directly on the product. User should never exceed the vehicle manufacturers maximum tow and weight rating regardless of the capacity of the hitch. **FAILURE TO FOLLOW THESE GUIDELINES WILL VOID THE WESTIN WARRANTY AND MAY RESULT IN PERSONAL INJURY AND/OR INJURY TO OTHERS AS WELL AS VEHICLE DAMAGE.**



Westin Automotive Products, Inc.  
320 W. Covina Blvd  
San Dimas, Ca. 91773

Thank you for choosing Westin products  
for additional installation assistance please call  
Customer Service (800) 793-7846  
[www.westinautomotive.com](http://www.westinautomotive.com)