



INSTALLATION INSTRUCTIONS

DEFENDER PIU EXPANDED REAR PARTITION

APPLICATION:

2011-2019 POLICE INTERCEPTOR UTILITY

PART NUMBER:

35-12005

ITEM	QUANTITY	DESCRIPTION	TOOLS NEEDED
1	1	REAR GUARD ASSEMBLY SCREEN	14MM SOCKET
2	1	CENTER PANEL	15MM SOCKET
3	1	FRAME	18MM SOCKET
4,5	2	SUPPORT BRACKET, DRIVER (4) AND PASSENGER (5)	ALLEN WRENCH
6	2	SUPPORT STRAP	CUTTING TOOL
7,8	2	FILLER PANEL, DRIVER (7) AND PASSENGER (8)	SOCKET EXT.
9	2	M8 HEX HEAD CAP SCREW (BLACK ZINC)	RATCHET
10	2	M8 FLAT WASHER (BLACK ZINC)	TORQUE WRENCH
11	2	M8 SPLIT LOCK WASHER (BLACK ZINC)	
12	4	M6 SELF DRILL SCREW (BLACK ZINC)	
13	4	M6 FLAT WASHER (BLACK ZINC)	
14	22	M10 BUTTON HEAD CAP SCREW (BLACK ZINC)	
15	22	M10 FLAT WASHER (BLACK ZINC)	
16	12	M10 SPLIT LOCK WASHER (BLACK ZINC)	
17	10	M10 FLANGE NUT (BLACK ZINC)	
18	1	SEAT BELT BRACKET	

ANTI-SEIZE LUBRICANT MUST BE USED ON ALL STAINLESS STEEL FASTENERS TO PREVENT THREAD DAMAGE AND GALLING

INSTALLATION TIME: 30 - 40 MINUTES

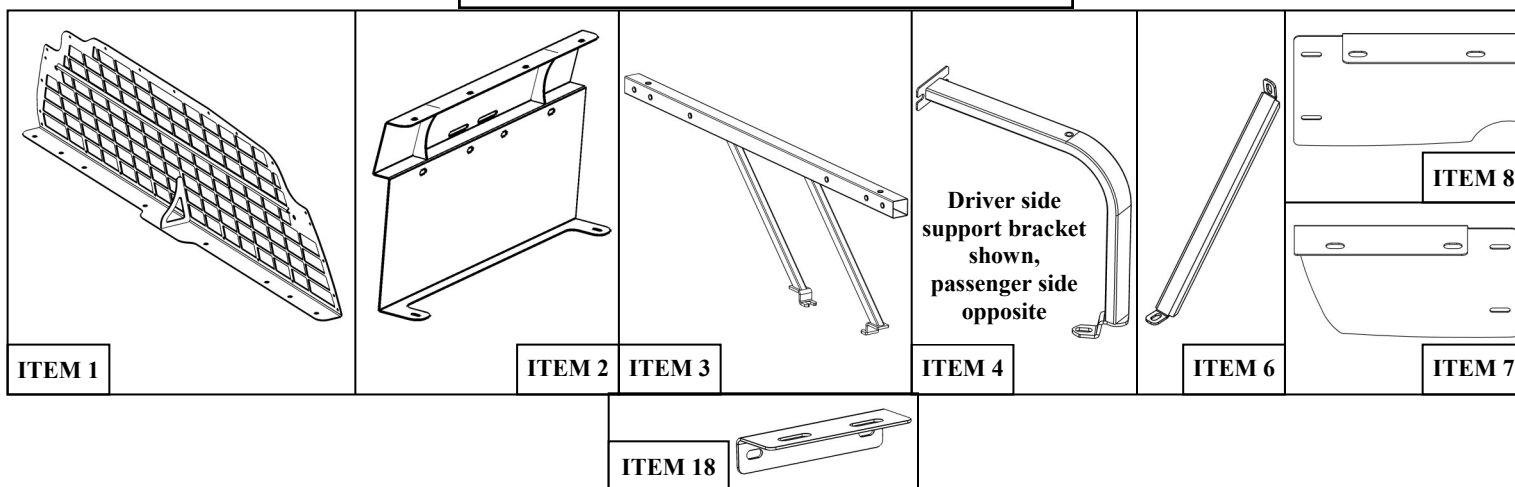

PROCEDURE

1. Remove contents from box, verify if all parts listed are present and free from damage.
Carefully read and understand all instructions before attempting installation.
Failure to identify damage before installation could lead to a rejection of any claim.



Westin Automotive Products, Inc.
320 W. Covina Blvd
San Dimas, Ca. 91773

Thank you for choosing Westin products
for additional installation assistance please call
Customer Service (800) 793-7846
www.westinautomotive.com

2. Start installation by trimming out back cargo cover. See **Figure 1**.
3. Several bolts and studs will be revealed after trimming cargo cover. See **Figure 2**.

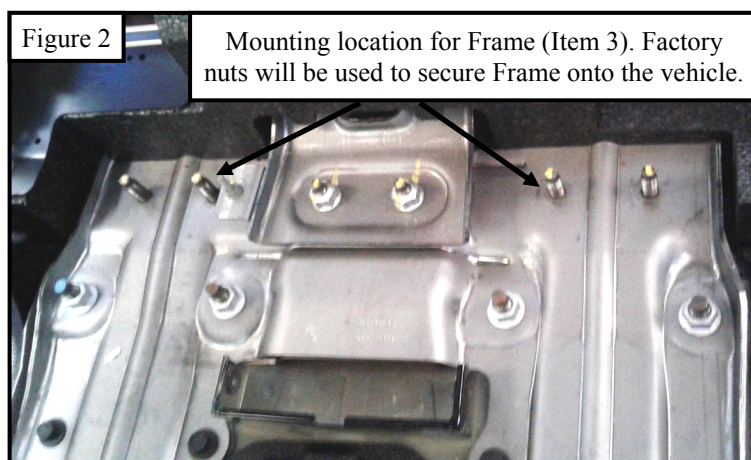
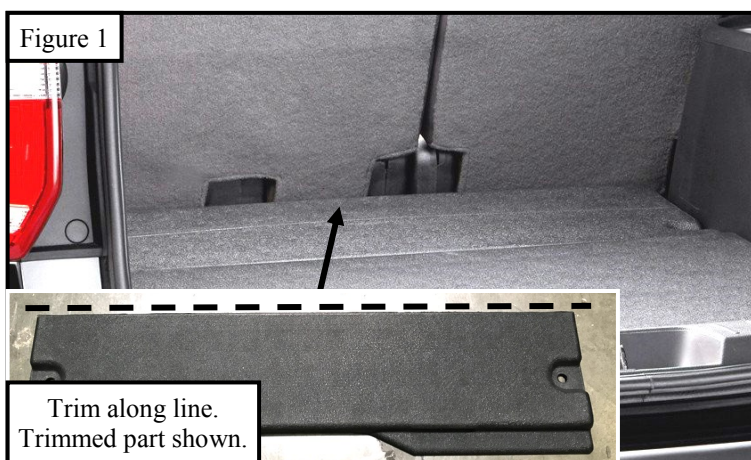

4. Locate the Frame (Item 3) and loosely secure onto factory studs using the factory nuts. See **Figures 2 and 3**.
5. On the sides of rear locate (2) plastic covers. There is (1) plastic cover on each side. Remove the covers to expose a factory bolt. See **Figure 4**.

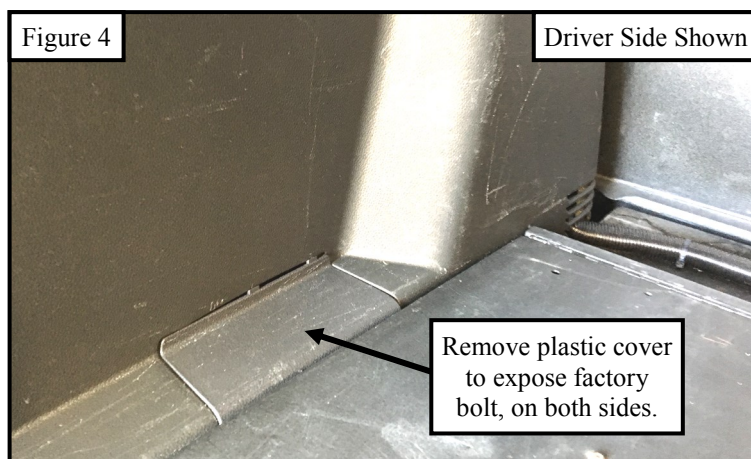
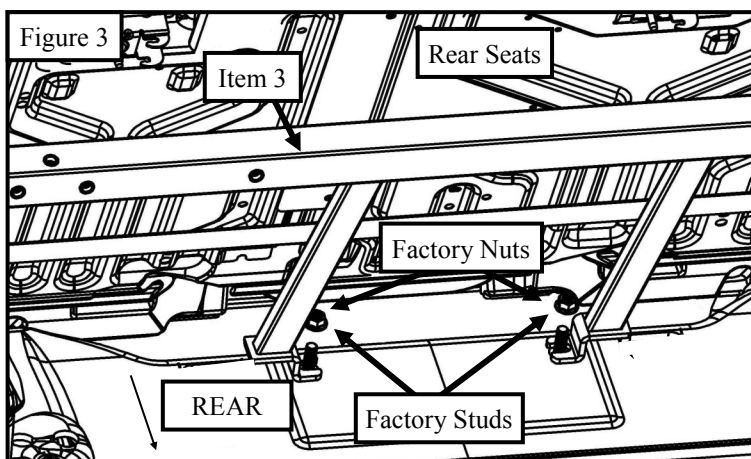

6. Locate (1) Support Bracket (Item 4/5) and loosely secure onto Frame (Item 3) using the provided M10 hardware (Items 14-16) and the factory bolt. See **Figures 5 and 6**. Repeat step for other side.

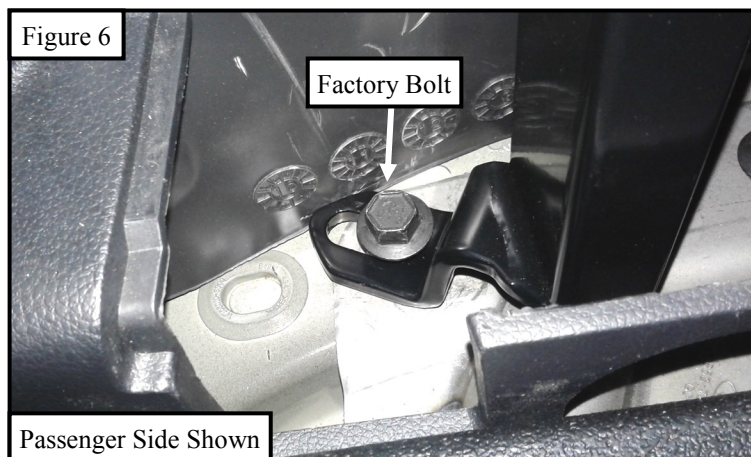
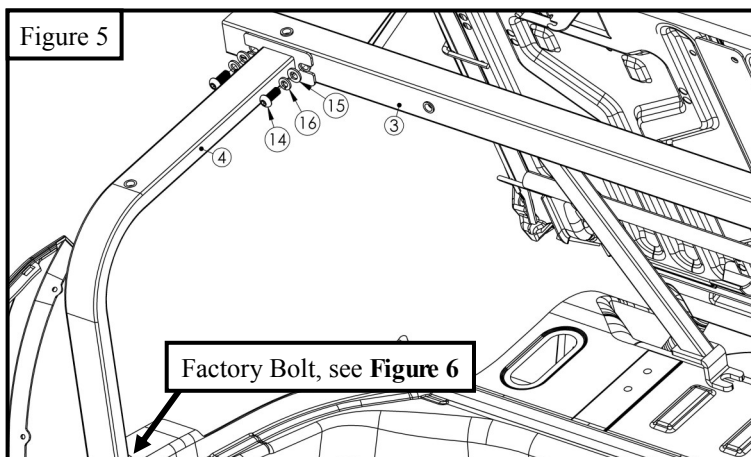

7. Locate (1) Central Panel (Item 2) and loosely secure onto the Frame (Item 3) and vehicle using the provided M8 hardware (Items 8-11) and M10 hardware (Items 14-16). See **Figure 7**. **Note:** Do not install Central Panel if installing with Defender Rear Partition Electrical Box (Item Number: 35-12005EB). Refer to Install Sheet 75-3512005EB.
8. Locate (2) Support Straps (Item 6) and loosely secure onto Support Brackets (Item 5) using the provided M10 hardware (Items 14-16). See **Figure 8**.

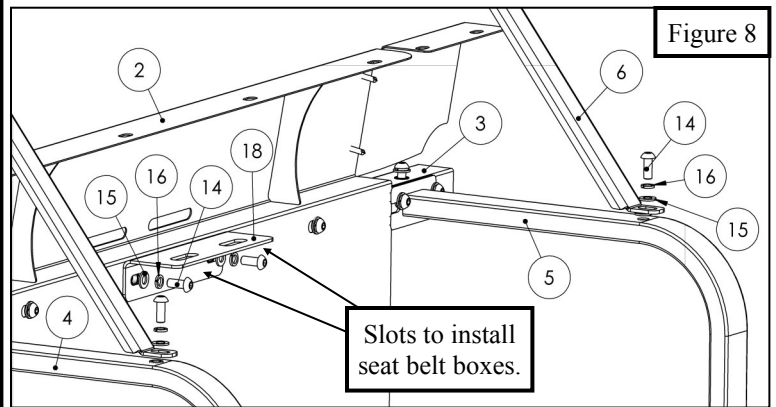
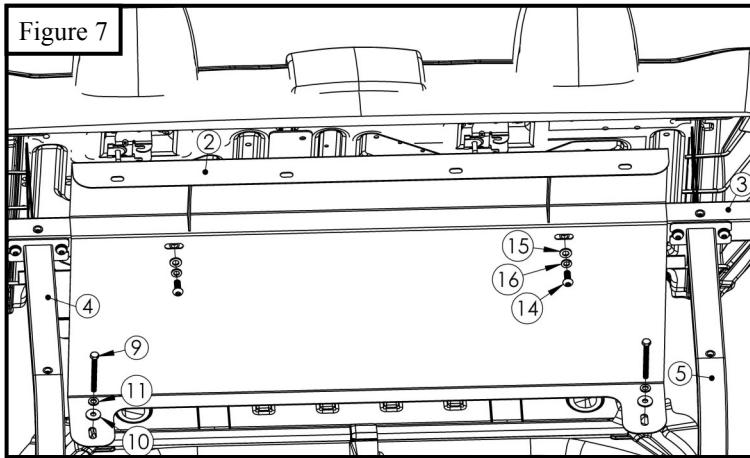

9. Loosely secure the Rear Guard Assembly Screen (Item 1) onto the Central Panel (Item 2) and both Support Straps (Item 6) using the provided M10 hardware (Items 14-17). See **Figure 9**.
10. Locate both Filler Panels (Items 7 and 8) and using the provided M6 hardware (Items 12-13) and M10 hardware (Items 14-17) to loosely secure onto the Rear Guard Assembly Screen and Center Panel. See **Figure 10**.

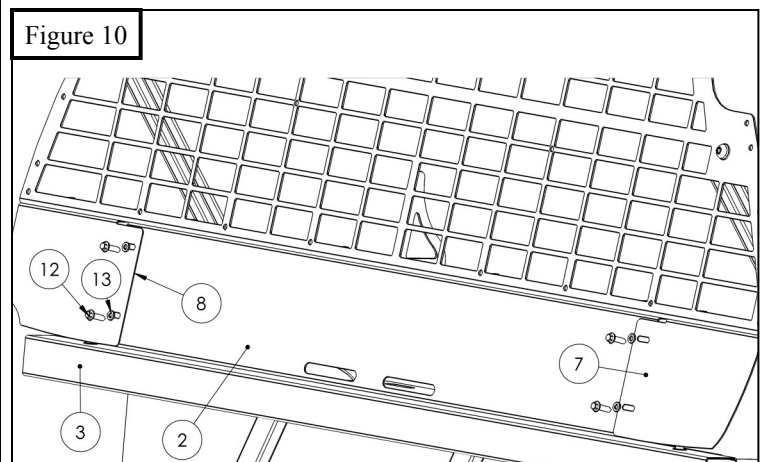
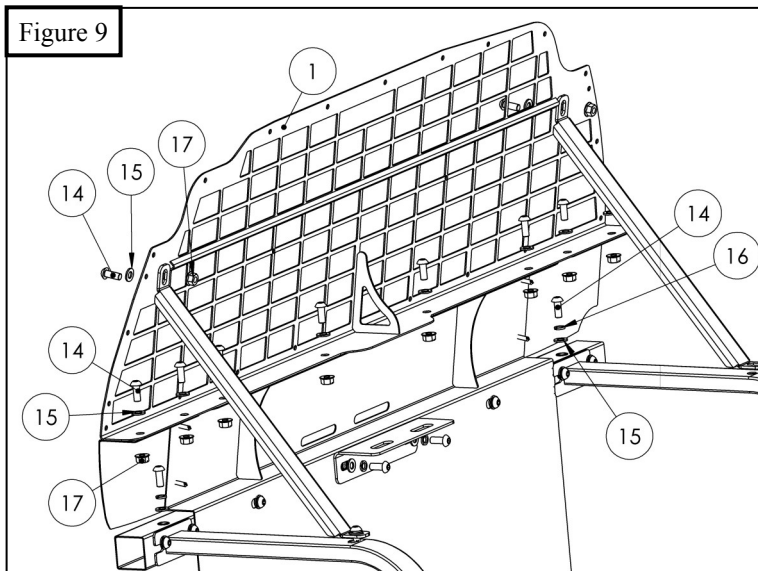

11. Align and adjust as necessary then tighten hardware, M8 hardware to 15-18 ft-lbs, M6 hardware to 5-7 ft-lbs, and M10 hardware to 30-35 ft-lbs.

Exploded View

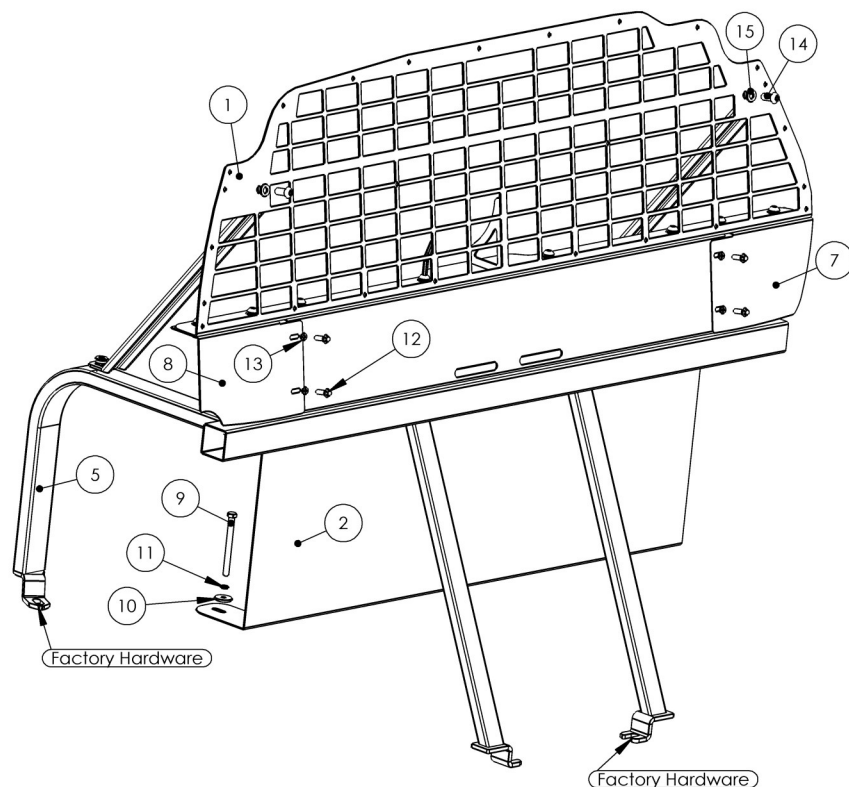

Exploded View

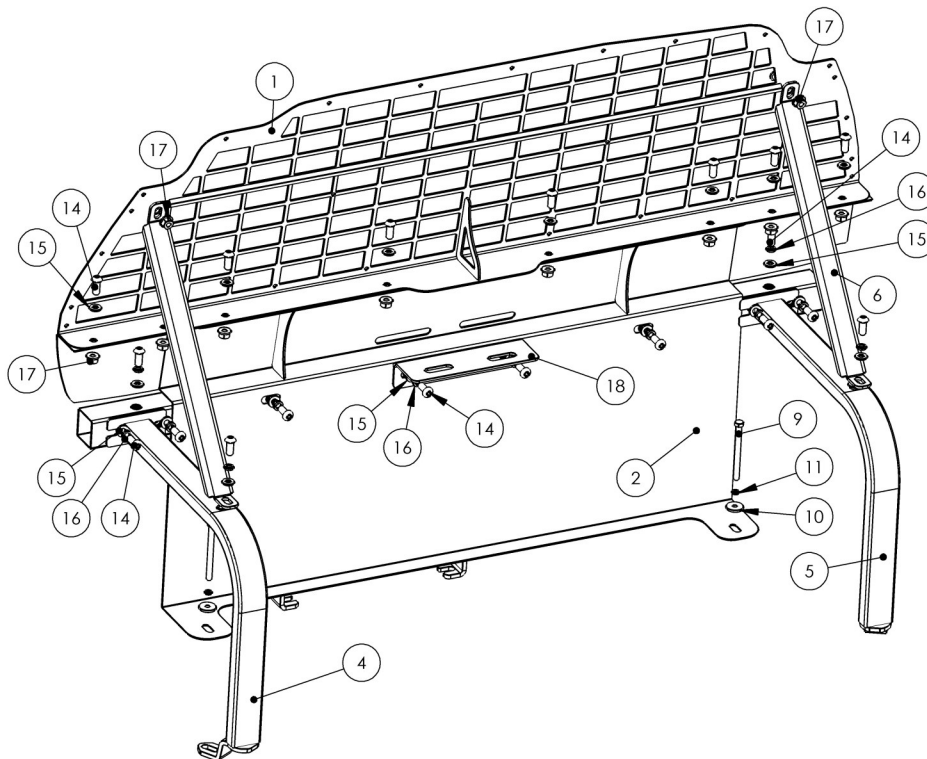

CARE INSTRUCTIONS

- REGULAR WAXING IS RECOMMENDED. DO NOT USE ANY TYPE OF POLISH OR WAX THAT MAY CONTAIN ABRASIVES.
- STAINLESS STEEL PRODUCTS CAN BE CLEANED WITH MILD SOAP AND WATER. STAINLESS STEEL POLISH SHOULD BE USED TO POLISH SMALL SCRATCHES.
- GLOSS BLACK FINISHES SHOULD BE CLEANED WITH MILD SOAP AND WATER.

WESTIN

Westin Automotive Products, Inc.
320 W. Covina Blvd
San Dimas, Ca. 91773

Thank you for choosing Westin products
for additional installation assistance please call
Customer Service (800) 793-7846
www.westinautomotive.com



WARNING



Failure to follow these instructions could lead to death, personal injury, and / or property damage.

Failure to follow these instructions could lead to death, personal injury, and / or property damage.

FASTENERS:

All Westin supplied fasteners must be utilized and installed in accordance with the installation instructions and apply torque to the specifications as defined. **DOUBLE CHECK ALL FASTENERS BEFORE INITIAL USE, AND PERIODICALLY IN THE FUTURE TO ENSURE PROPER FUNCTION AND SAFETY.**

DRILLING:

Most Westin products do not require drilling for installation. If drilling is defined as required, use caution when drilling a vehicle. **FAILURE TO REVIEW AN AREA TO BE DRILLED MAY RESULT IN PERSONAL INJURY AND/OR INJURY TO OTHERS AS WELL AS VEHICLE DAMAGE.**

EYE PROTECTION:

ALWAYS WEAR SAFETY GLASSES OR GOGGLES DURING THE INSTALLATION PROCESS TO AVOID PERSONAL INJURY.

MAXIMUM TOWING/CARRYING CAPACITY: (if applicable)

The Westin Receiver Hitches will have a visible tow rating label affixed directly on the product. User should never exceed the vehicle manufacturers maximum tow and weight rating regardless of the capacity of the hitch. **FAILURE TO FOLLOW THESE GUIDELINES WILL VOID THE WESTIN WARRANTY AND MAY RESULT IN PERSONAL INJURY AND/OR INJURY TO OTHERS AS WELL AS VEHICLE DAMAGE.**

FOR CALIFORNIA RESIDENTS ONLY-PROP 65 WARNING:

Some products may contain chemicals such as DEHP, which can cause cancer, birth defects or other reproductive harm. For more info go to www.p65warnings.ca.gov



Westin Automotive Products, Inc.
320 W. Covina Blvd
San Dimas, Ca. 91773

Thank you for choosing Westin products
for additional installation assistance please call
Customer Service (800) 793-7846
www.westinautomotive.com