

# INSTALLATION INSTRUCTIONS

## DEFENDER FRONT PARTITION

APPLICATION: 2021 Chevrolet Tahoe PPV

PART NUMBER: 35-10065



CONTENT			
ITEM	QUANTITY	DESCRIPTION	TOOLS NEEDED
1	1	PARTITION	10MM SOCKET
2	1	DRIVER MOUNTING BRACKET	13MM SOCKET
3	1	PASSENGER MOUNTING BRACKET	13MM WRENCH
4	1	DRIVER STRAP	T-45 TORX BIT
5	1	PASSENGER STRAP	5MM ALLEN
6	1	UPPER DRIVER BRACKET	RATCHET
7	1	UPPER PASSENGER BRACKET	TORQUE WRENCH
8	2	FILLER PLATE	TRIM TOOL
9	1	DRIVER FOOT SHIELD	
10	1	PASSENGER FOOT SHIELD	
11	4	M8 BUTTON HEAD BOLT	
12	4	M8 FLAT WASHER	
13	4	M8 SPLIT LOCK WASHER	
14	4	M6 BUTTON HEAD BOLT	
15	26	M6 FLAT WASHER	
16	26	M6 SERRATED FLANGE NUT	
17	4	M6 LOCK WASHER	
18	4	M8 SERRATED FLANGE BOLT	
19	4	M8 SERRATED FLANGE NUT	
20	6	#8 SCREW	
21	1	CENTER COVER	
ANTI-SEIZE LUBRICANT MUST BE USED ON ALL STAINLESS STEEL FASTENERS TO PREVENT THREAD DAMAGE AND GALLING			

### PROCEDURE

1. Remove contents from box, verify if all parts listed are present and free from damage.  
Carefully read and understand all instructions before attempting installation.  
**Failure to identify damage before installation could lead to a rejection of any claim.**



Westin Automotive Products, Inc.  
320 W. Covina Blvd  
San Dimas, Ca. 91773

Thank you for choosing Westin products  
for additional installation assistance please call  
Customer Service (800) 793-7846  
[www.westinautomotive.com](http://www.westinautomotive.com)

ITEM 1

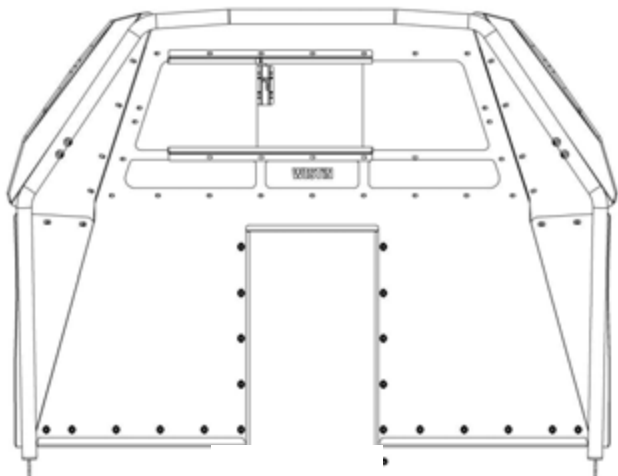

ITEM 9

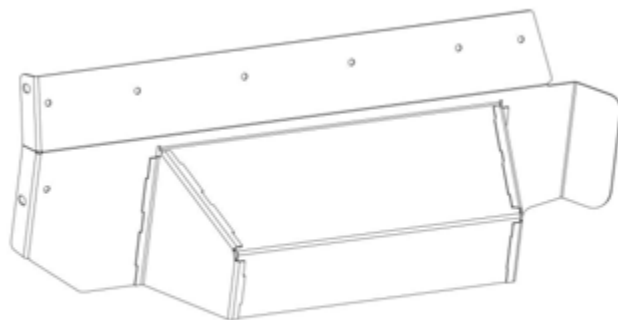

ITEM 3

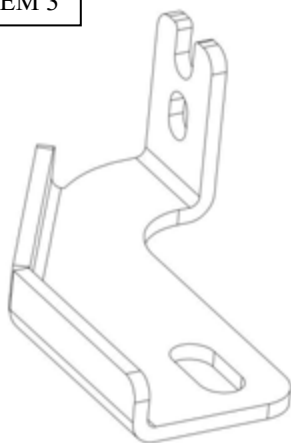

ITEM 5



ITEM 6

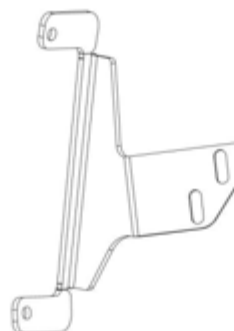

ITEM 8



2. Starting on either side. Remove the rear bolts out of the front seat. Locate the mounting brackets (items 2,3) and the straps (items 4,5). Slide the mounting brackets under the outer seat rails. Slide the straps under the inner seat rails. Loosely replace the factory bolts. **See Figures 1-2**

Figure 1

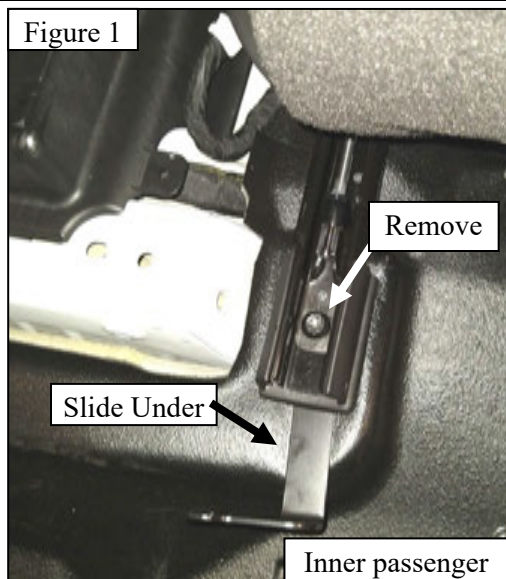
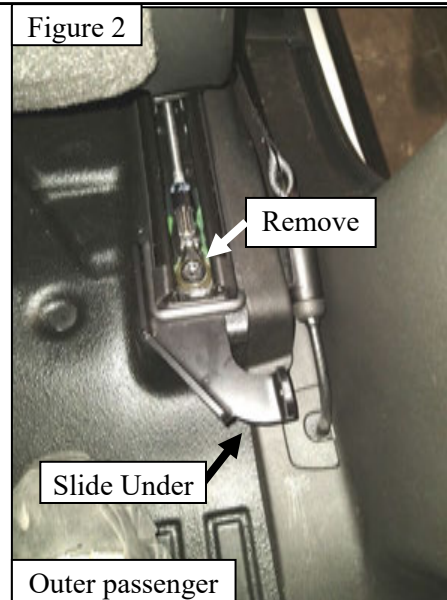

Figure 2

**WESTIN**

Westin Automotive Products, Inc.  
320 W. Covina Blvd  
San Dimas, Ca. 91773

Thank you for choosing Westin products  
for additional installation assistance please call  
Customer Service (800) 793-7846  
[www.westinautomotive.com](http://www.westinautomotive.com)

3. Remove the square tab and remove the top screw in the B-Pillar. Using a Trim removal tool, remove the plastic paneling on the B-Pillar to access the grab handle. Remove the factory bolts and grab handle on both sides. **See Figure 3-4**
4. Re-using factory bolts, assemble the upper mounting bracket to the grab handle bolt holes. ***Make sure to slide in the cover plate prior to installation.*** Tighten to 5-7 ft-lbs. Replace the factory trim. **See Figure 5-6**
5. Using the supplied #8 screws, assemble the cover plate to the factory trim.

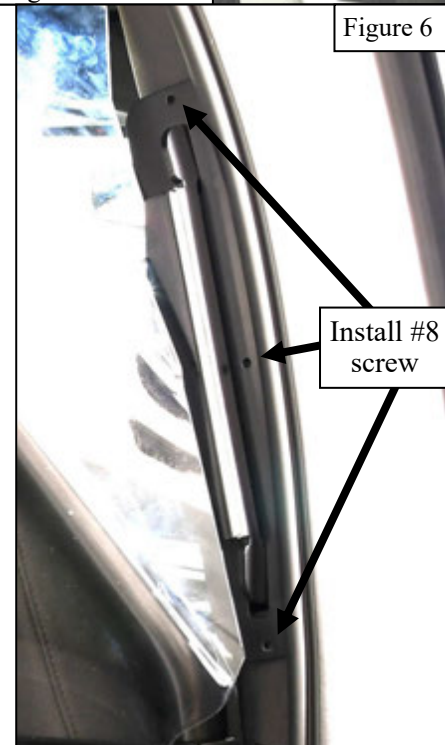
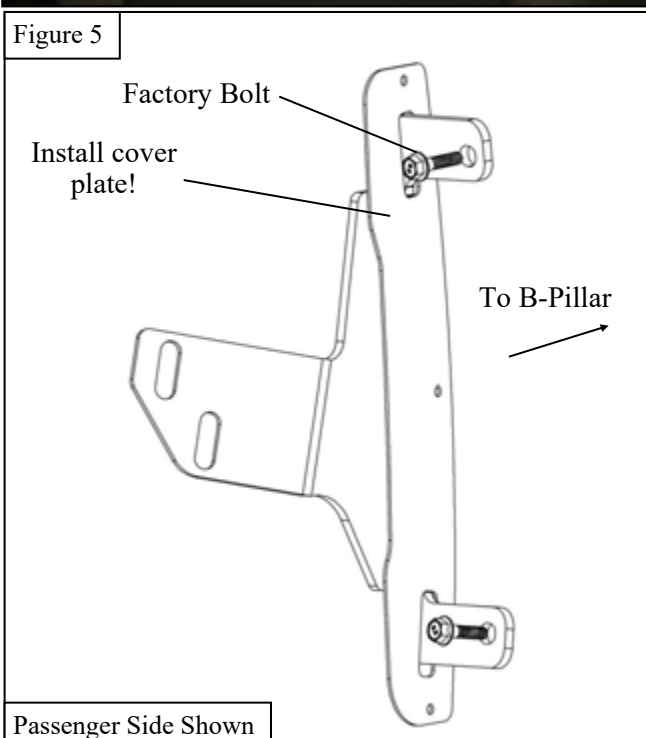

6. With help, locate the partition onto its designated are in the vehicle.
7. Using supplied M8 and M12 hardware, loosely install the partition to the mounting brackets. **See Figure 7, 8 & 9**

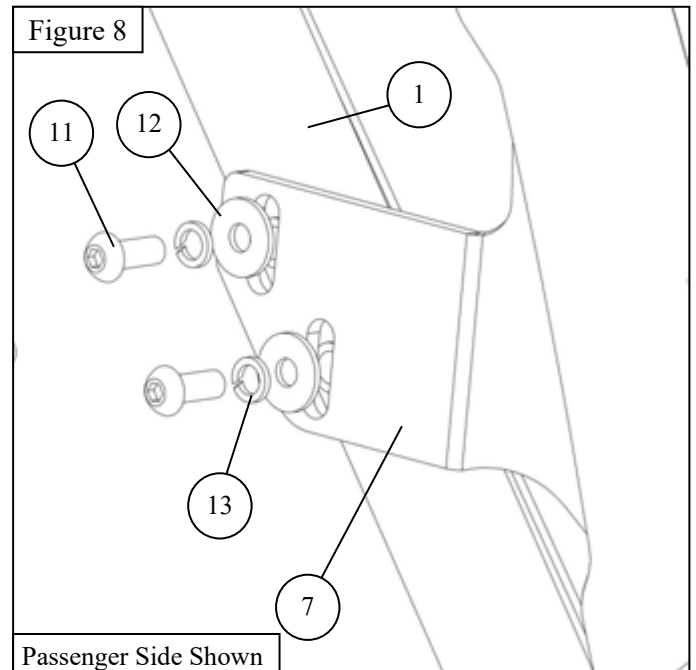
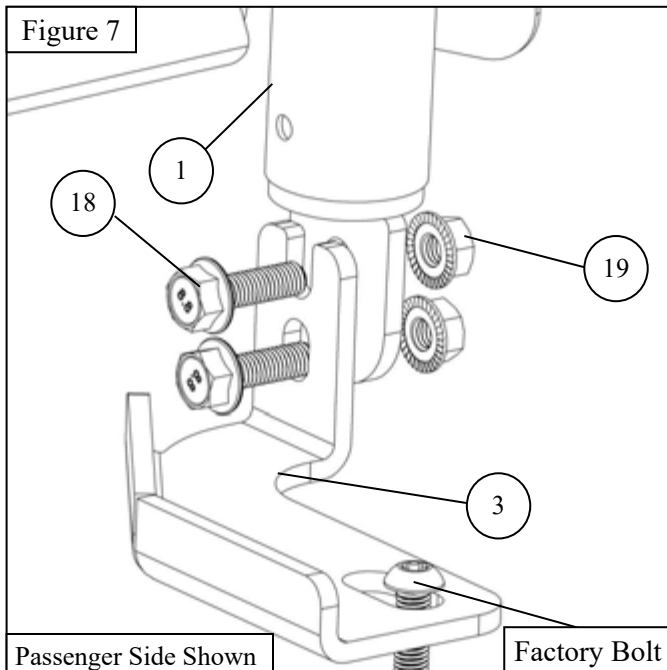

8. Locate the center cover (21). Using supplied M6 hardware, loosely assemble the center cover to the partition.  
*Note: Mount from the rear side. See Figure 9*

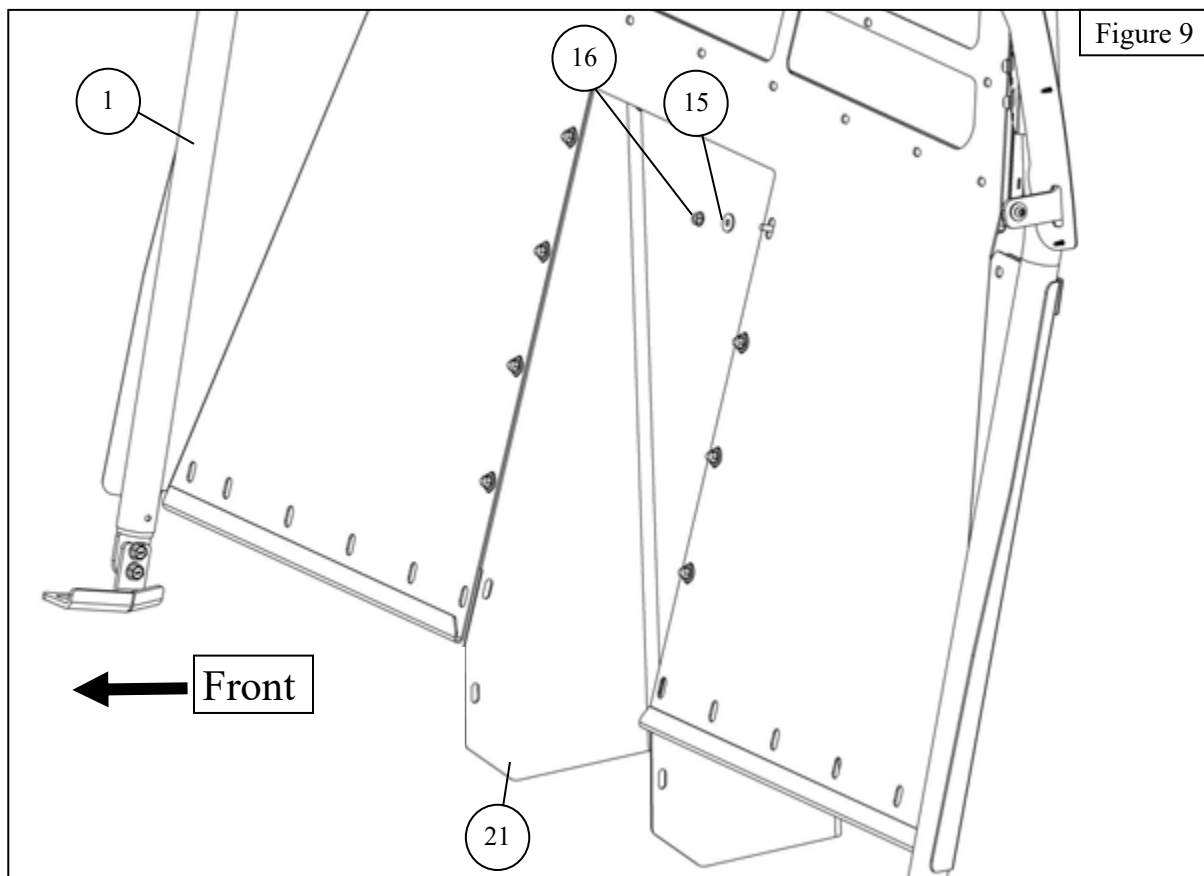



9. Locate the driver and passenger foot shields (9,10). Using supplied M6 hardware, loosely assemble the foot shields to the partition. *Note: Mount from the rear side, foot shield mounts over the center cover. See Figures 10 and 11.*

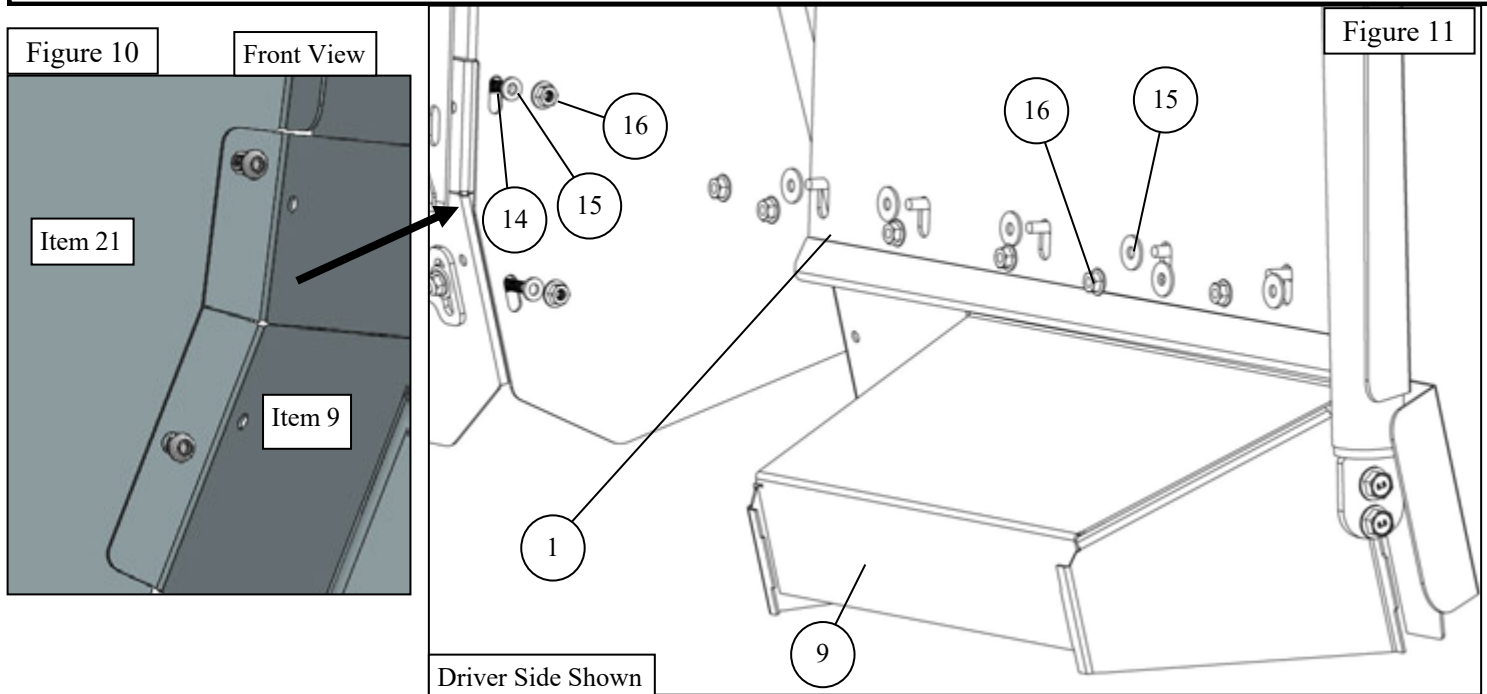

10. Adjust the partition as necessary and torque as specified: M6 to 5-7 ft– lbs, M8 to 15-18 ft lbs.



#### CARE INSTRUCTIONS

- REGULAR WAXING IS RECOMMENDED. DO NOT USE ANY TYPE OF POLISH OR WAX THAT MAY CONTAIN ABRASIVES.
- STAINLESS STEEL PRODUCTS CAN BE CLEANED WITH MILD SOAP AND WATER. STAINLESS STEEL POLISH SHOULD BE USED TO POLISH SMALL SCRATCHES.
- GLOSS BLACK FINISHES SHOULD BE CLEANED WITH MILD SOAP AND WATER.



## WARNING



Failure to follow these instructions could lead to death, personal injury, and / or property damage.

Failure to follow these instructions could lead to death, personal injury, and / or property damage.

### FASTENERS:

All Westin supplied fasteners must be utilized and installed in accordance with the installation instructions and apply torque to the specifications as defined. **DOUBLE CHECK ALL FASTENERS BEFORE INITIAL USE, AND PERIODICALLY IN THE FUTURE TO ENSURE PROPER FUNCTION AND SAFETY.**

### DRILLING:

Most Westin products do not require drilling for installation. If drilling is defined as required, use caution when drilling a vehicle. **FAILURE TO REVIEW AN AREA TO BE DRILLED MAY RESULT IN PERSONAL INJURY AND/OR INJURY TO OTHERS AS WELL AS VEHICLE DAMAGE.**

### EYE PROTECTION:

**ALWAYS WEAR SAFETY GLASSES OR GOGGLES DURING THE INSTALLATION PROCESS TO AVOID PERSONAL INJURY.**

### MAXIMUM TOWING/CARRYING CAPACITY: (if applicable)

The Westin Receiver Hitches will have a visible tow rating label affixed directly on the product. User should never exceed the vehicle manufacturers maximum tow and weight rating regardless of the capacity of the hitch. **FAILURE TO FOLLOW THESE GUIDELINES WILL VOID THE WESTIN WARRANTY AND MAY RESULT IN PERSONAL INJURY AND/OR INJURY TO OTHERS AS WELL AS VEHICLE DAMAGE.**

### FOR CALIFORNIA RESIDENTS ONLY-PROP 65 WARNING:

Some products may contain chemicals such as DEHP, which can cause cancer, birth defects or other reproductive harm. For more info go to [www.p65warnings.ca.gov](http://www.p65warnings.ca.gov)



Westin Automotive Products, Inc.  
320 W. Covina Blvd  
San Dimas, Ca. 91773