

INSTALLATION INSTRUCTIONS

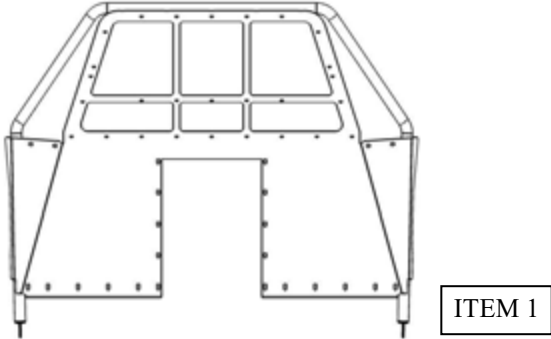

DEFENDER PARTITION
APPLICATION:
2018-2022 Ford F-150 Police Responder
PART NUMBER:
35-10035

| CONTENT | | | |
|---|----------|--|--------------------|
| ITEM | QUANTITY | DESCRIPTION | TOOLS NEEDED |
| 1 | 1 | PARTITION ASSEMBLY | 10MM SOCKET |
| 2,3 | 2 | FOOT POCKET (DRIVER (2), PASSENGER (3)) | 10MM WRENCH |
| 4 | 1 | MIDDLE COVER PLATE | 13MM SOCKET |
| 5 | 1 | RECESSED PANEL | 13MM WRENCH |
| 6,7 | 2 | MOUNT (DRIVER (6), PASSENGER (7)) | 16MM SOCKET |
| 8,9 | 2 | UPPER MOUNT (DRIVER (8), PASSENGER (9)) | 16MM WRENCH |
| 10,11 | 2 | STRAP (DRIVER (10), PASSENGER (11)) | 7/16" SOCKET |
| 12 | 4 | 10MM SPACER | RATCHET |
| 13 | 4 | 21MM SPACER | TORQUE WRENCH |
| 14,15 | 2 | POLY BRACKET (DRIVER (14), PASSENGER (15)) | 5/32" ALLEN WRENCH |
| 16,17 | 2 | AIR BAG RELIEF (DRIVER (16), PASSENGER (17)) | 5MM ALLEN WRENCH |
| 18 | 24 | M6 SERRATED FLANGE NUT | |
| 19 | 4 | M8 BUTTON HEAD SCREW | |
| 20 | 4 | M8 FLAT WASHER | |
| 21 | 4 | M8 SPLIT LOCK WASHER | |
| 22 | 4 | M6 BUTTON HEAD SCREW—SHORT | |
| 23 | 4 | M6 FLAT WASHER | |
| 24 | 4 | M6 SPLIT LOCK WASHER | |
| 25 | 4 | M10 SERRATED FLANGE BOLT | |
| 26, 27 | 2 | 2021 UPPER MOUNT (DRIVER (26), PASSENGER (27)) | |
| 28 | 4 | 16MM SPACER 2021 UPPER MOUNT | |
| 29 | 4 | M6 BUTTON HEAD SCREW—LONG | |
| ANTI-SEIZE LUBRICANT MUST BE USED ON ALL STAINLESS STEEL FASTENERS TO PREVENT THREAD DAMAGE AND GALLING | | | |
|  | | | |

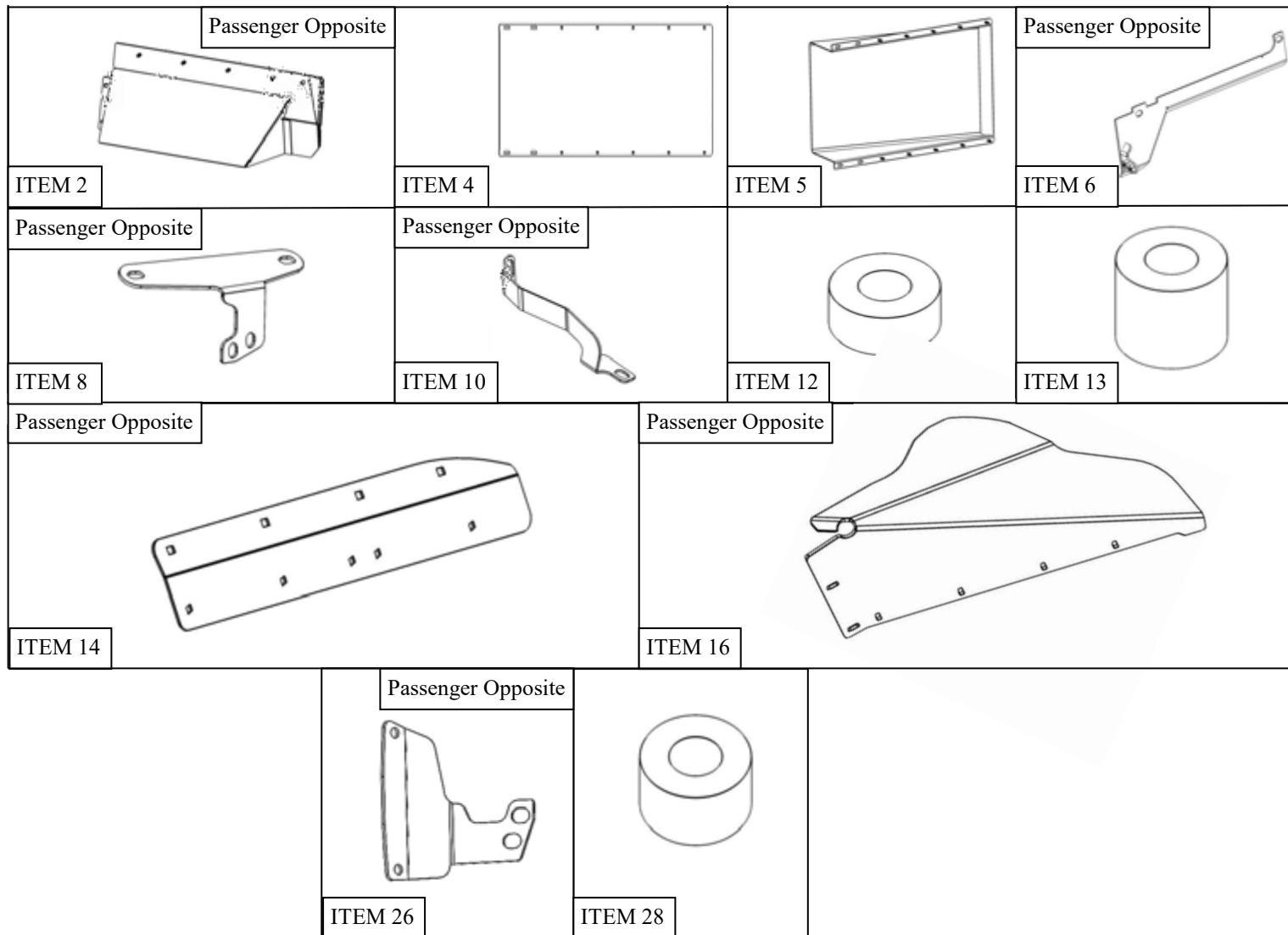

PROCEDURE

1. Remove contents from box, verify if all parts listed are present and free from damage.
Carefully read and understand all instructions before attempting installation.
Failure to identify damage before installation could lead to a rejection of any claim.

2. Remove the plastic covers from the two bolt locations accessible at the rear of the front seats. See **Figure 1** for reference.
3. Remove **all four** of the bolts at the rear mounting locations of the front seats. See **Figure 2** for reference.



4. Loosely attach the Mount (6,7) to the rear brackets on the front seat using the supplied Large Spacers (13) and OEM Hardware removed in **Step 3**. See **Figures 3 & 4** for reference.

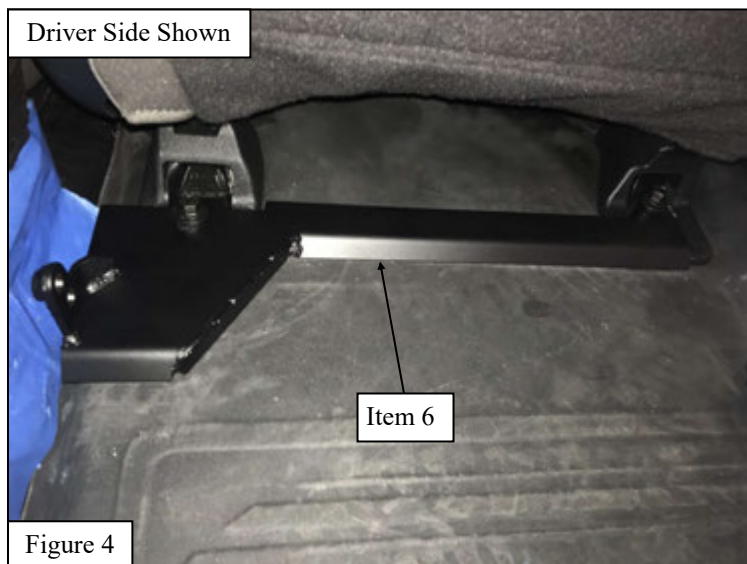
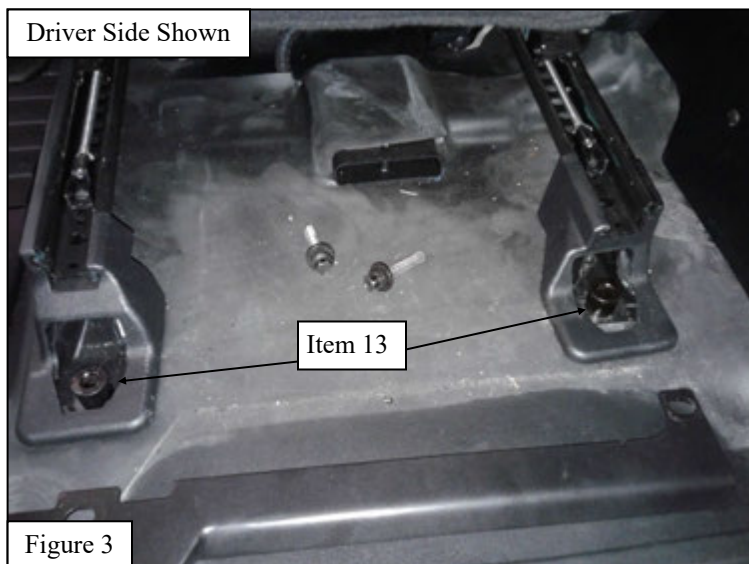

WESTIN

Westin Automotive Products, Inc.
320 W. Covina Blvd
San Dimas, Ca. 91773

Thank you for choosing Westin products
for additional installation assistance please call
Customer Service (800) 793-7846

www.westinautomotive.com

For 2018 - 2020 Vehicles

5. Remove the existing handle near the door frame from both sides of the vehicle.
6. Place the supplied 10MM Spacers (12) in each bolt location. See **Figure 5** for reference.
7. Loosely attach the Upper Mounts (8,9) to this location using the supplied M6 Hardware (22, 23, 24). See **Figure 6**.

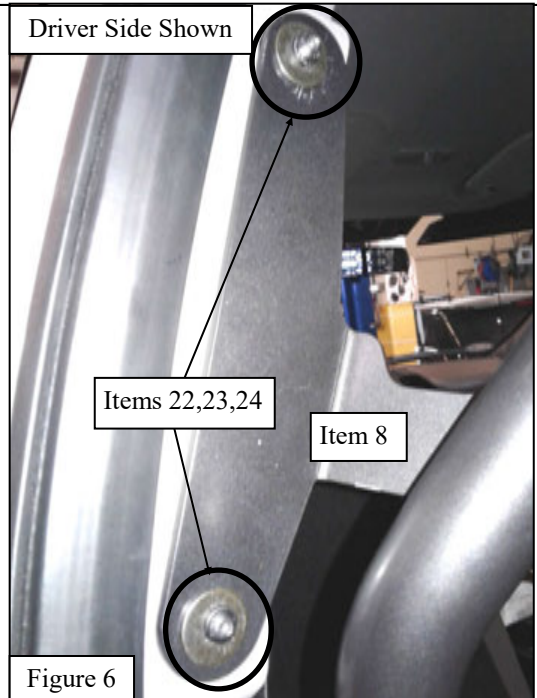
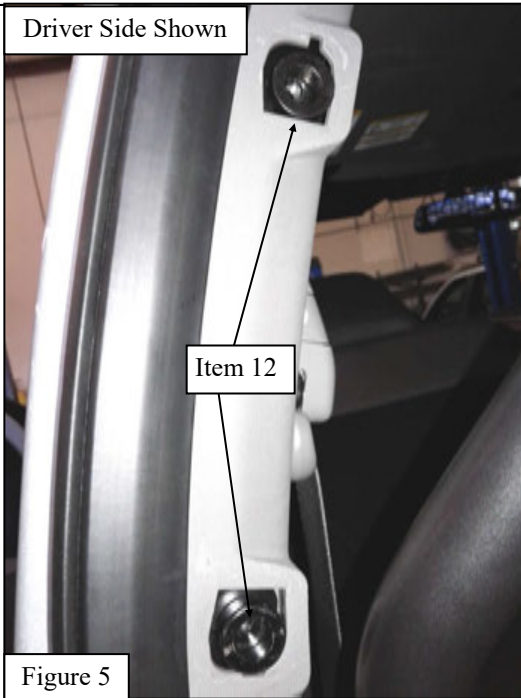

For 2021 Vehicles

8. Pull back the rubber pillar trim near the door frame as shown in **Figure 7** and pry back the center pillar trim molding to remove the two 6MM bolts.
9. Using the OEM bolt holes as a reference, drill a 1/2" hole into the center pillar trim molding as shown in **Figure 8**.
10. Place the supplied 2021 16MM Spacers (28) in each bolt location. See **Figure 8** for reference.
11. Loosely attach the Upper Mounts (26, 27) to this location using the M6 hardware (23, 24, 29) See **Figure 9** for reference.

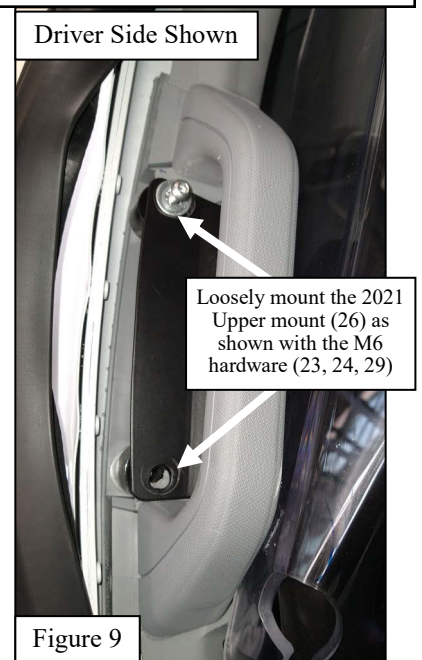
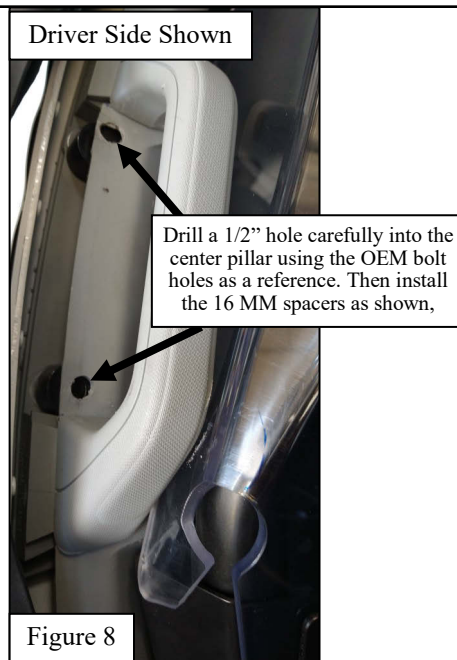
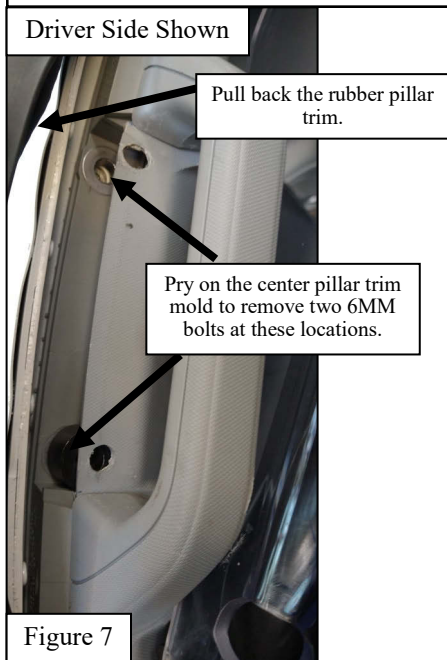

12. With help, move the Partition Assembly (1) into place.
13. Loosely attach it to each Mount (6,7) using the supplied M10 Serrated Flange Bolts (25). See **Figure 10** for reference.
14. Loosely attach the Partition Assembly (1) to the Upper Mounts (8, 9, 26, or 27) using the supplied M8 Hardware. See **Figure 11** for reference. **Note:** 2018-2020 vehicle is shown in figure, but the 2021 vehicle installation is similar. See **Figure 12** for reference.

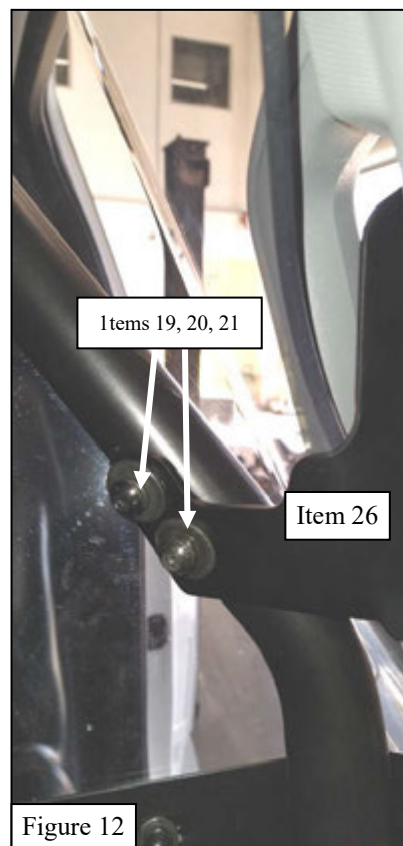
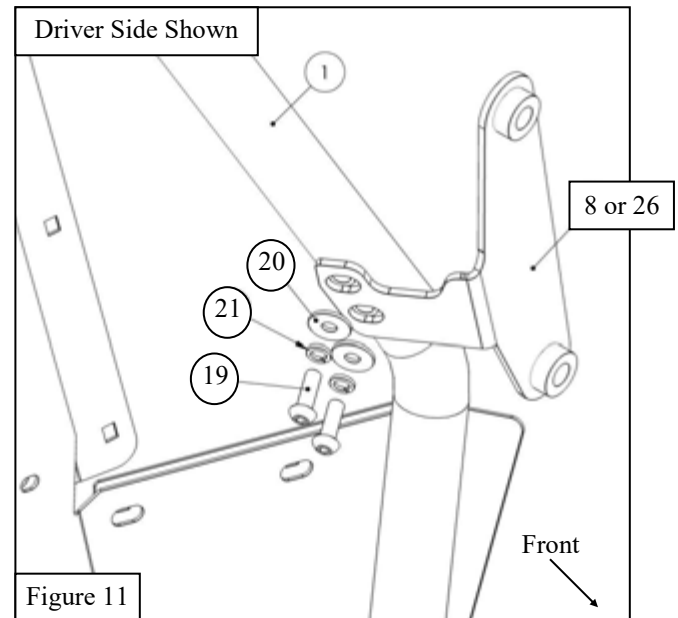
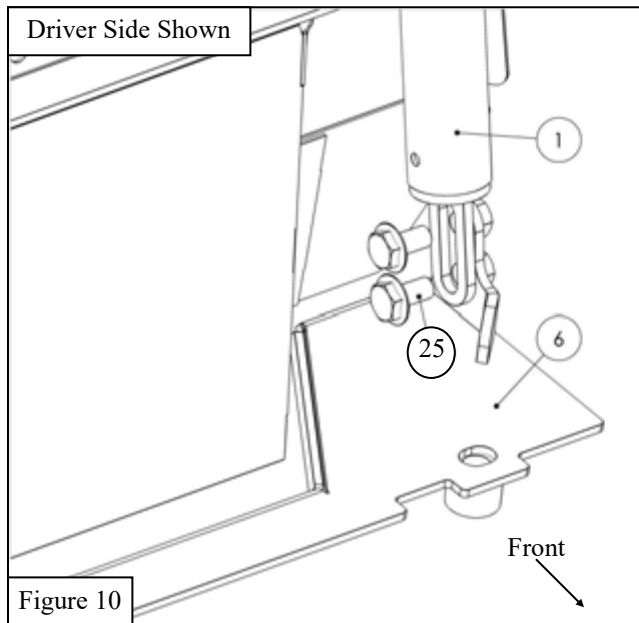

15. Remove the inner most bolt on each of the Mounts (6,7) and attach the Straps (10,11) using the same bolt. See **Figures 13 & 14** for reference.

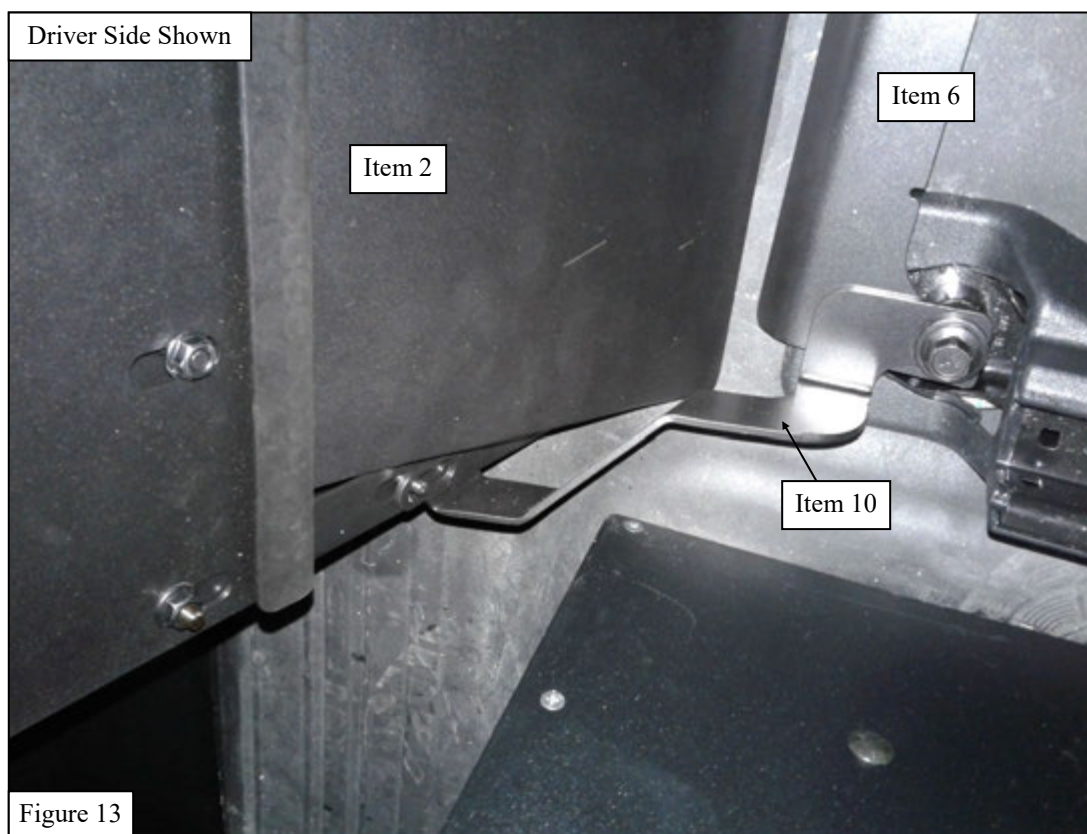

Westin Automotive Products, Inc.
320 W. Covina Blvd
San Dimas, Ca. 91773

16. Assemble the Partition Assembly (1), Foot Pockets (2,3), Middle Cover Plate (4), or Recessed Panel (5) using the supplied M6 Serrated Flange Nuts (18). See **Figures 14 & 15**.

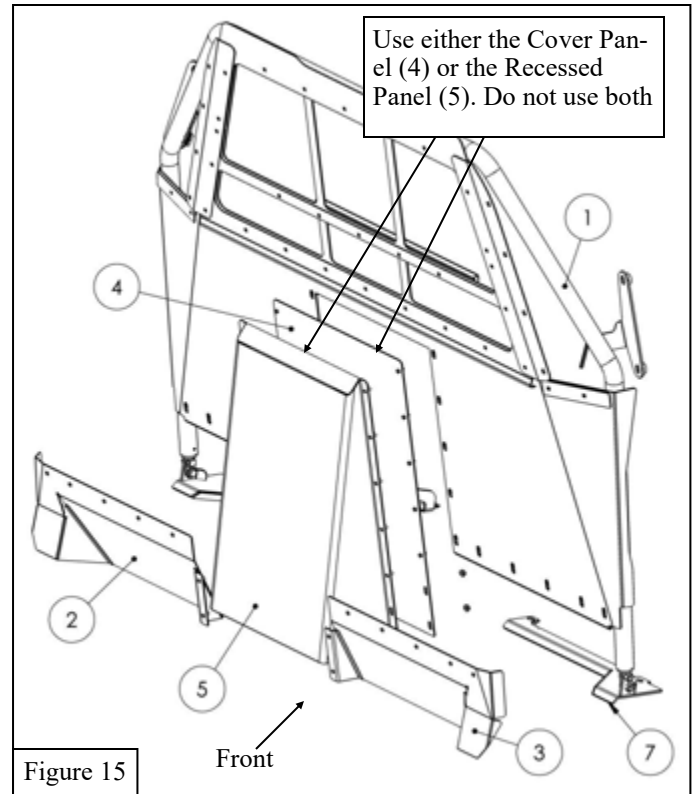
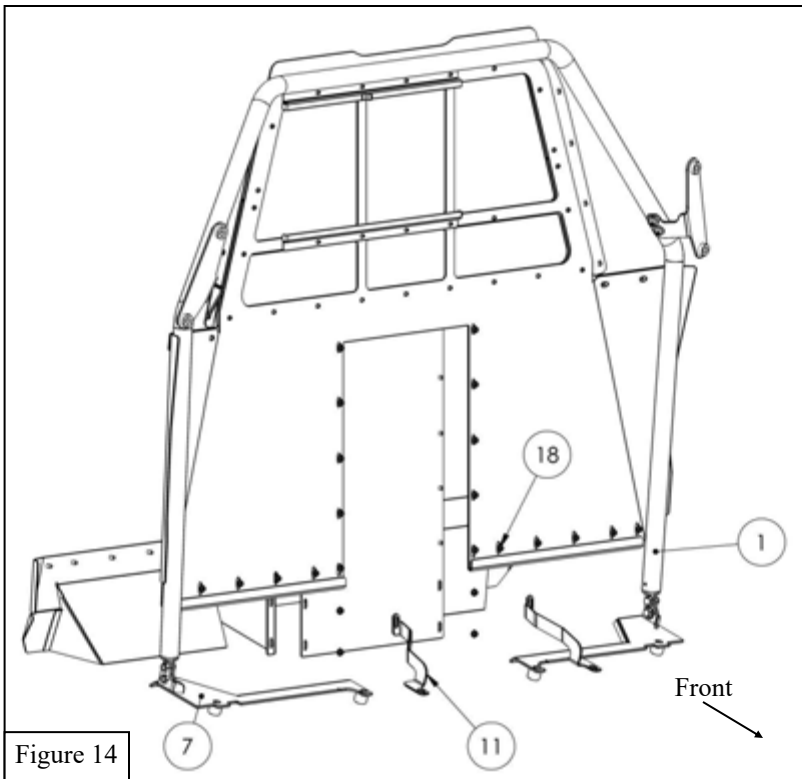

17. Loosen the Poly Bracket (14,15) and Air Bag Relief (16,17) hardware if needed in order to adjust them and line them up properly with the roof of the vehicle. See **Figure 16** for reference.

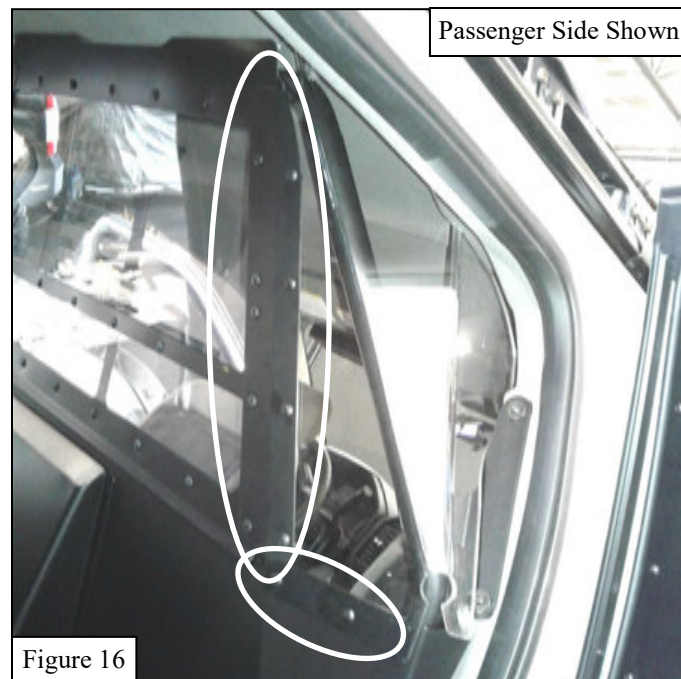

18. Align and adjust the Partition Assembly as needed. Torque all hardware as specified: M6 to 8 ft-lbs, M8 to 18 ft-lbs, M10 to 38 ft-lbs.

INSTALLATION COMPLETE

2019-2020 Vehicle Shown



CARE INSTRUCTIONS

- REGULAR WAXING IS RECOMMENDED. DO NOT USE ANY TYPE OF POLISH OR WAX THAT MAY CONTAIN ABRASIVES.
- STAINLESS STEEL PRODUCTS CAN BE CLEANED WITH MILD SOAP AND WATER. STAINLESS STEEL POLISH SHOULD BE USED TO POLISH SMALL SCRATCHES.
- GLOSS BLACK FINISHES SHOULD BE CLEANED WITH MILD SOAP AND WATER

WESTIN

Westin Automotive Products, Inc.
320 W. Covina Blvd
San Dimas, Ca. 91773

Thank you for choosing Westin products
for additional installation assistance please call
Customer Service (800) 793-7846

www.westinautomotive.com



WARNING



Failure to follow these instructions could lead to death, personal injury, and / or property damage.

Failure to follow these instructions could lead to death, personal injury, and / or property damage.

FASTENERS:

All Westin supplied fasteners must be utilized and installed in accordance with the installation instructions and apply torque to the specifications as defined. **DOUBLE CHECK ALL FASTENERS BEFORE INITIAL USE, AND PERIODICALLY IN THE FUTURE TO ENSURE PROPER FUNCTION AND SAFETY.**

DRILLING:

Most Westin products do not require drilling for installation. If drilling is defined as required, use caution when drilling a vehicle. **FAILURE TO REVIEW AN AREA TO BE DRILLED MAY RESULT IN PERSONAL INJURY AND/OR INJURY TO OTHERS AS WELL AS VEHICLE DAMAGE.**

EYE PROTECTION:

ALWAYS WEAR SAFETY GLASSES OR GOGGLES DURING THE INSTALLATION PROCESS TO AVOID PERSONAL INJURY.

MAXIMUM TOWING/CARRYING CAPACITY: (if applicable)

The Westin Receiver Hitches will have a visible tow rating label affixed directly on the product. User should never exceed the vehicle manufacturers maximum tow and weight rating regardless of the capacity of the hitch. **FAILURE TO FOLLOW THESE GUIDELINES WILL VOID THE WESTIN WARRANTY AND MAY RESULT IN PERSONAL INJURY AND/OR INJURY TO OTHERS AS WELL AS VEHICLE DAMAGE.**

FOR CALIFORNIA RESIDENTS ONLY-PROP 65 WARNING:

Some products may contain chemicals such as DEHP, which can cause cancer, birth defects or other reproductive harm. For more info go to www.p65warnings.ca.gov



Westin Automotive Products, Inc.
320 W. Covina Blvd
San Dimas, Ca. 91773