



SIGNATURE OF QUALITY

AUTOMOTIVE PRODUCTS, INC.

INSTALLATION INSTRUCTIONS

PUSH BUMPER ELITE XD
APPLICATION: 2014-2015 CHEVROLET SILVERADO 1500
36-53685

ITEM	QUANTITY	DESCRIPTION	TOOLS NEEDED
1	1	POLICE PUSH BUMPER ELITE XD	RATCHET
2, 3	2	UPPER MOUNTING STRAP DRIVER/ PASSENGER	TORQUE WRENCH
4, 5	2	BOTTOM MOUNTING BRACKET DRIVER/ PASSENGER	ALLEN KEY
6	4	M12 X 25mm HEX HEAD FLANGE BOLT (Yellow Zinc)	8MM ALLEN SOCKET
7	6	M12 SERRATED FLANGE NUT (Yellow Zinc)	15MM SOCKET
8	2	M10 SERRATED FLANGE NUT (Black Stainless)	16MM SOCKET
9	2	M10 X 35mm HEX SOCKET BUTTON HEAD SCREW (Black Stainless)	18MM SOCKET
10	2	M10 CUPPED WASHER (Black Stainless)	SOCKET EXTENSION
11	6	M12 x 40 HEX SOCKET BUTTON HEAD SCREW (Black Stainless)	18MM WRENCH
12	6	M12 CUPPED WASHER (Black Stainless)	
13	6	M12 SERRATED FLANGE NUT (Black Stainless)	
14	2	M12 x 50mm STUD PLATE	
15	2	SPACER	

ANTI-SEIZE LUBRICANT MUST BE USED ON ALL STAINLESS STEEL FASTENERS TO PREVENT THREAD DAMAGE AND GALLING

1. Remove contents from box, verify if all parts listed are present and free from damage. Carefully read and understand all instructions before attempting installation. Note: This product may be mounted stand-alone or in conjunction with Winch Tray P/N 46-23685 (sold separately).

STEP 1: Removal and Trimming

- Remove Grille and Filler Panel. (Figures 2-7)
- **Vehicles without factory tow hooks:** Locate on the bumper the cover insert. This cover will need to be trimmed to install the bottom bracket. (Figure 1)
- **Vehicles with factory tow hooks:** Tow hooks will need to be removed, review figures 8-11 to remove the bumper in order to access the tow hook bolts.

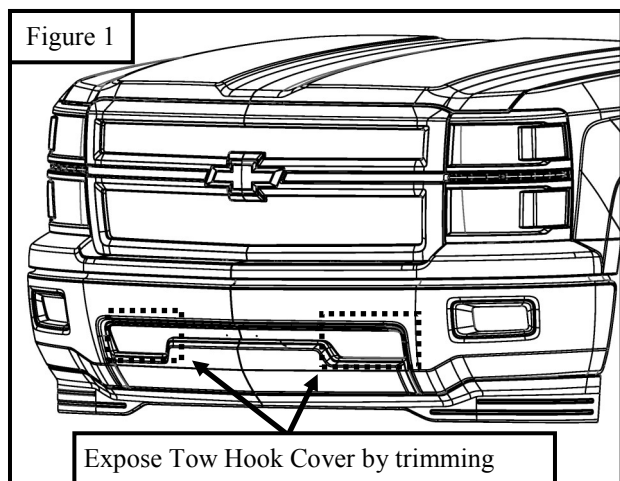

Westin Automotive Products, Inc.
320 Covina Blvd
San Dimas, Ca. 91773

Figure 3

Remove the two fasteners on each side attaching the filler panel to the body.

Working from beneath the vehicle use a flat-head screwdriver to pop loose the plastic tabs retaining the filler panel to the grille.

Figure 4

Once all fasteners have been removed and the tabs are popped loose carefully pull the filler panel off of the vehicle.

Figure 5

Remove all of the lower screws holding the grille to the radiator support.

Figure 6

Figure 7

Remove all of upper the screws holding the grille to the upper radiator support and carefully pull it from the vehicle. Note: there are several inaccessible clips that provide some retention on the grille. They will pop loose when you pull on the grille.

Remove this M10 bolt from each side of the bumper (Driver side shown).

Figure 8



Westin Automotive Products, Inc.
320 Covina Blvd
San Dimas, Ca. 91773

Remove these M12 bolts from each side of the bumper (Driver side shown).

Figure 9

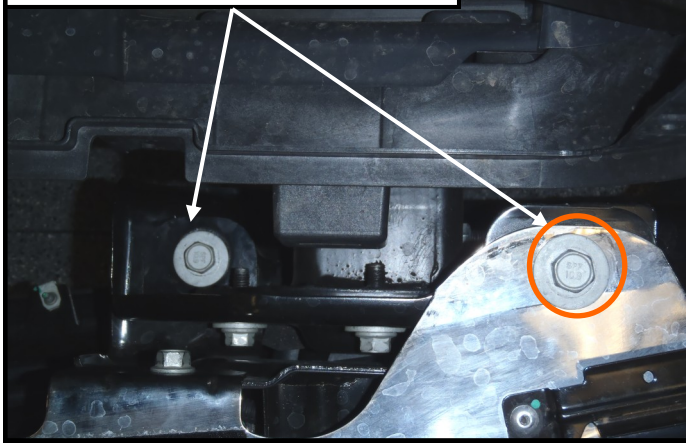

Loosen the (3) bumper bracket bolts on the Driver Side only.

Figure 10

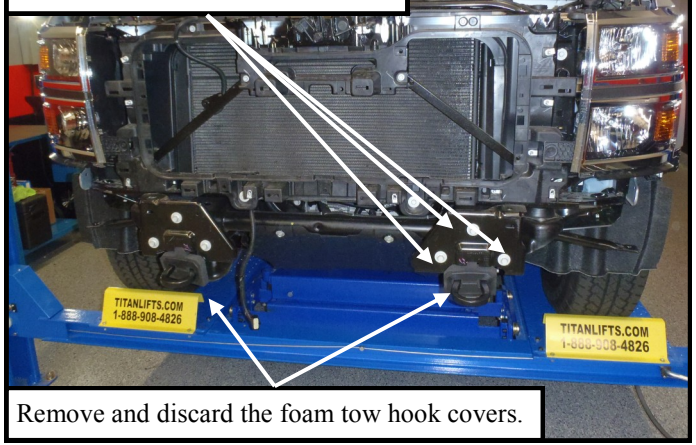

Remove and discard the foam tow hook covers.

Figure 11

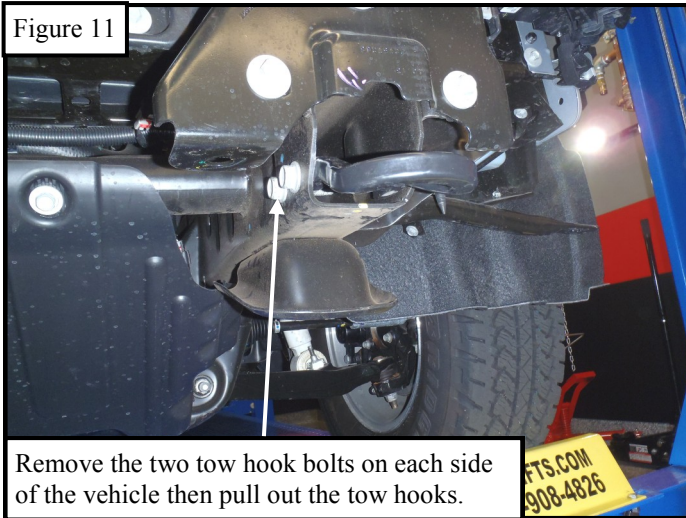

Remove the two tow hook bolts on each side of the vehicle then pull out the tow hooks.

Step 2: Bottom Bracket installation — (Skip this step if mounting the Push Bumper in conjunction with 46-23685 Winch Tray Kit)

- Re-install the bumper if the bumper was previously removed. Do not re-install bolt that is circled on Figure 9
- Locate the Passenger and Driver Side Bottom Brackets (items 4 & 5 on Figure 12), and position each one in the tow hook pockets (Figure 13).

Figure 12

ITEM 4 & 5

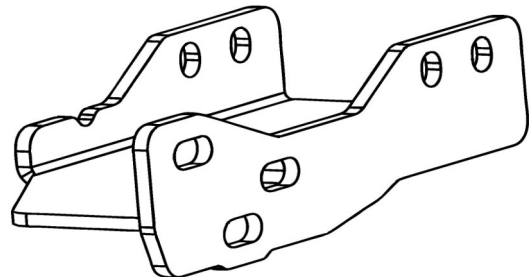

DRIVER

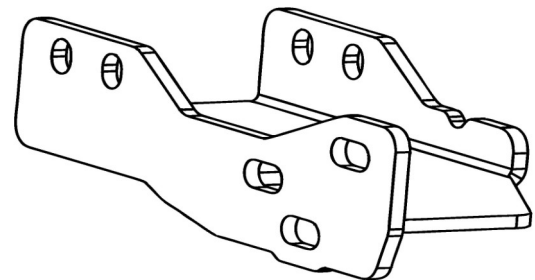

PASSENGER

Figure 13

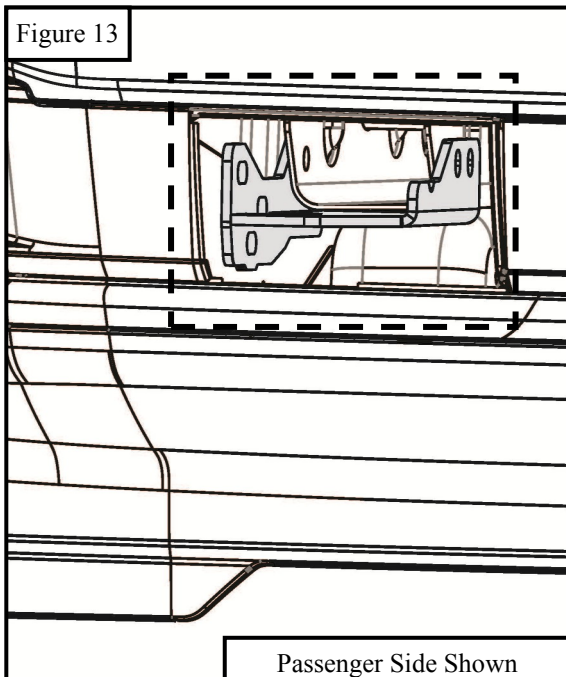

Passenger Side Shown



Westin Automotive Products, Inc.
320 Covina Blvd
San Dimas, Ca. 91773

- Loosely attach each of the Bottom Brackets by using (2) M12 Hex Head Flange Bolts (item 6), (1) M12 Stud plate (item 14) and (3) M12 Ser-rated Flange Nuts (item 7). (Figure 14)

Step 3: Installing Upper Brackets

- Remove the upper factory bumper bolt that is circled on figure 9. If it was not previously removed.
- Locate the Upper Support Straps (items 2 & 3 on Figure 15) and loosely attach them to where the upper factory bumper bolts were removed on the previous step.
- Measure and adjust the Upper Support Straps (Figure 17); then torque down the factory M10 bolts to 35 ft-lbs.
- Re-install the filler panel and the factory grille.

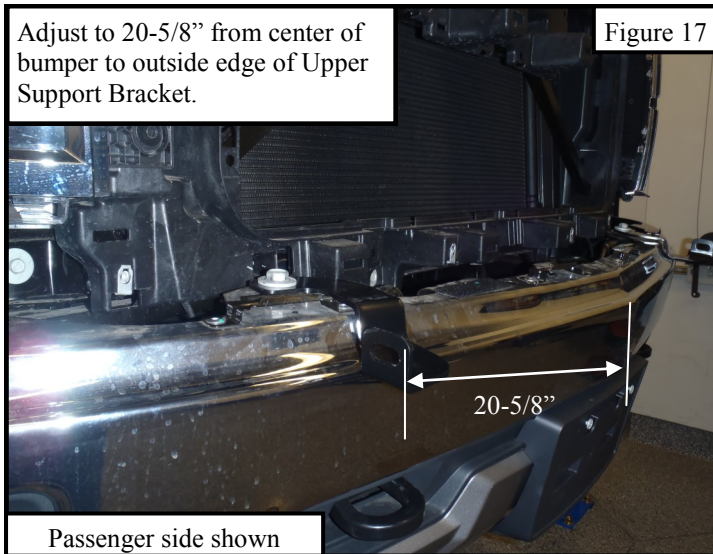
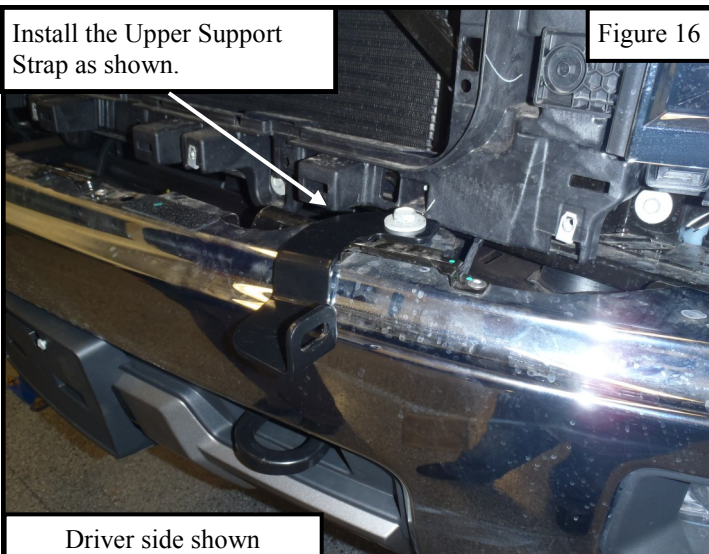
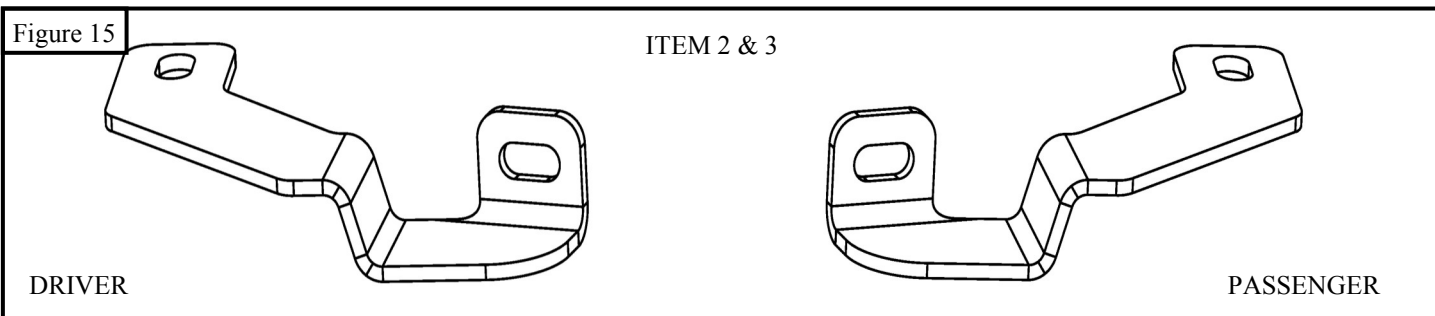
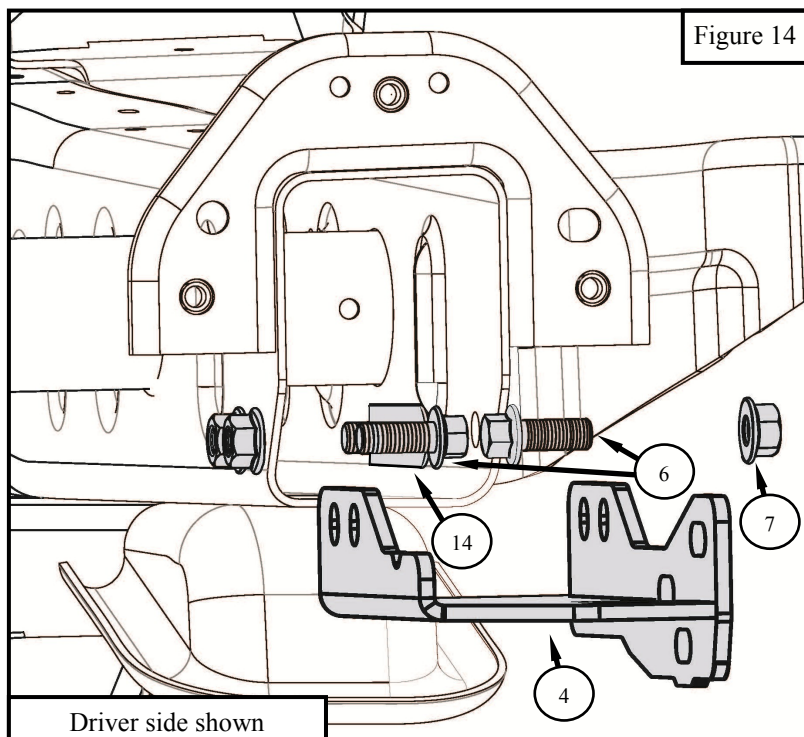

Westin Automotive Products, Inc.
320 Covina Blvd
San Dimas, Ca. 91773

STEP 4: Installing the Push Bumper without Winch Tray

- Locate and attach the Push Bumper (Figure 18) to the Bottom Brackets using (6) M12 Hex Socket Button Head Screws (item 11), (4) M12 Cupped Washers (item 12) and (4) M12 Serrated Flange Nuts (item 13). (Figure 19)
- Attach the Push Bumper to the Upper Support Straps using (2) M10 Hex Socket Button Head Screws (item 9), (2) M10 Cupped Washers (item 10) and (2) M10 Serrated Flange Nuts (item 8). (Figure 19)
- Align and adjust the Push Bumper then tighten and torque all M10 hardware to 30-35 ft-lbs. and all M12 to 50-55 ft-lbs.

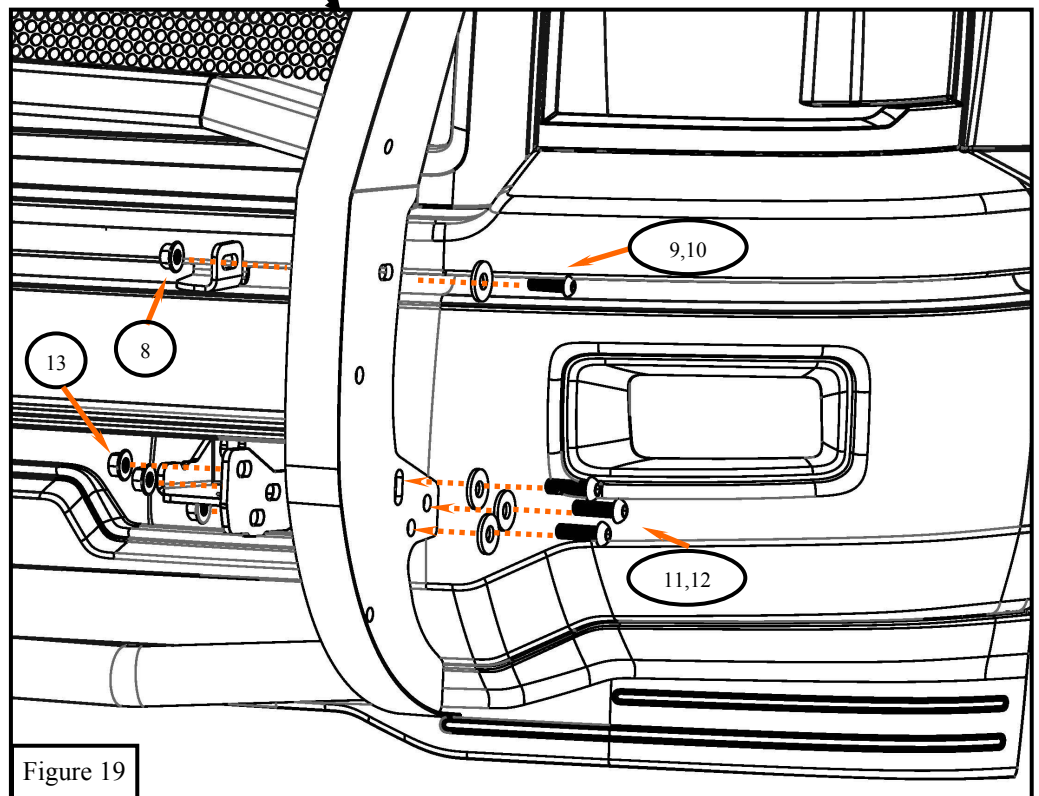
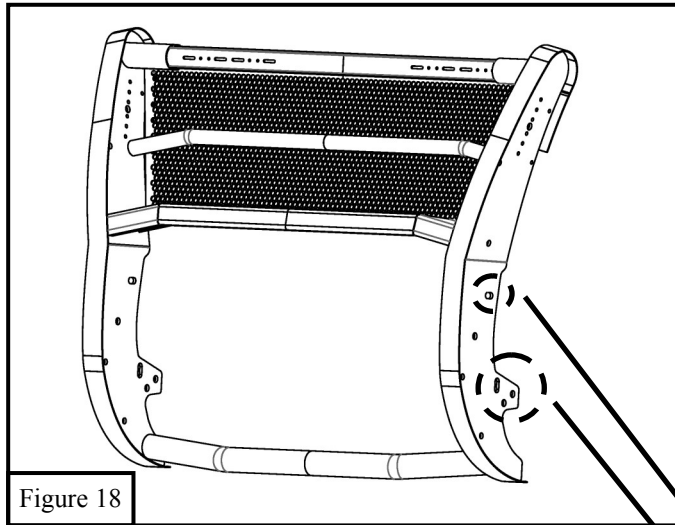

Westin Automotive Products, Inc.
320 Covina Blvd
San Dimas, Ca. 91773

STEP 5: Installing Push Bumper With Winch Tray (46-23685)

- Loosely install the Winch Tray per the Winch Tray Install sheet.
- If installing the Winch Tray you will use the Spacer (Item 15) that is included in this kit. (Figure 20)
- Place the spacer between the Push Bumper and the Bottom Bracket as shown on Figure 21. Note: The Bottom Bracket is supplied with the Winch Tray (46-23685).
- Align the holes from the Push Bumper and the Spacer with the Slot on the Bottom Bracket.
- Then secure the Spacer and Push Bumper by using (1) M12 Serrated Flange Nut (item 13), (1) M12 Cupped Washer (item 12) and (1) M12 Hex Socket Button Head Screw, per side. Note: refer to Winch Tray installation instructions (46-23685) for torque specs and hardware on securing the Winch Tray to the Push Bumper.

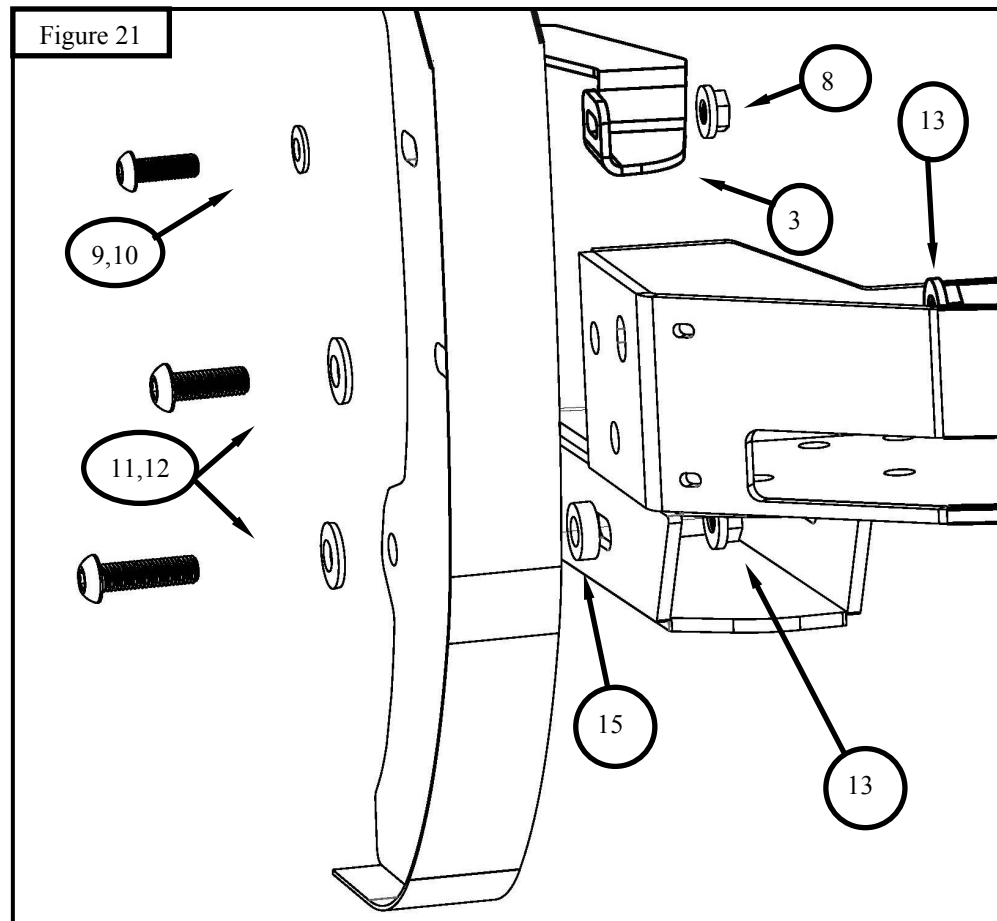
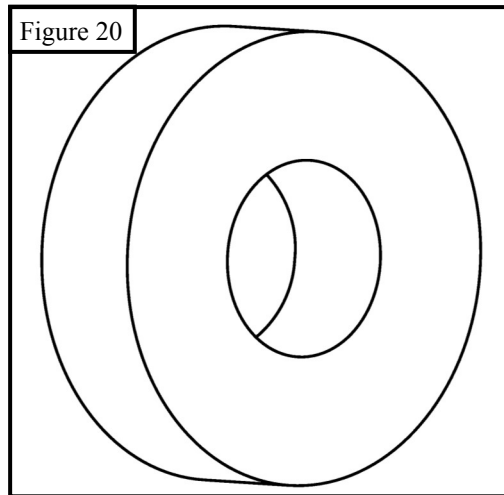

Westin Automotive Products, Inc.
320 Covina Blvd
San Dimas, Ca. 91773

Shown with optional Wing Wraps p/n 36-53685W (sold separately)



With Winch Tray, Installation Complete.



Without Winch Tray, Installation Complete

CARE INSTRUCTIONS

- REGULAR WAXING IS RECOMMENDED. DO NOT USE ANY TYPE OF POLISH OR WAX THAT MAY CONTAIN ABRASIVES.
- STAINLESS STEEL PRODUCTS CAN BE CLEANED WITH MILD SOAP AND WATER. STAINLESS STEEL POLISH SHOULD BE USED TO POLISH SMALL SCRATCHES.
- GLOSS BLACK FINISHES SHOULD BE CLEANED WITH MILD SOAP AND WATER.



Westin Automotive Products, Inc.
320 Covina Blvd
San Dimas, Ca. 91773

Thank You for choosing Westin products
For Additional installation assistance please call
Customer service (800) 793-7846
www.westinautomotive.com